

FLETCHERS

ESTATE AGENTS



Wellesley Road, W4

£525,000

Located on the third floor of a sought after mansion block, this two double bedroom property features a 16' reception room and separate kitchen. There is plenty of storage in the flat and it also benefits from a lift, communal gardens and swimming pool.

Belgrave Court is located on the corner of Wellesley Road and Sutton Lane North off Turnham Green within a quarter of a mile of Chiswick Park tube station and within easy reach of the M4 and A316.

- Two Double Bedrooms • Third Floor • Lift Access • Communal Gardens • New Lease & Share Of Freehold On Completion • Sought After Location •

Third Floor

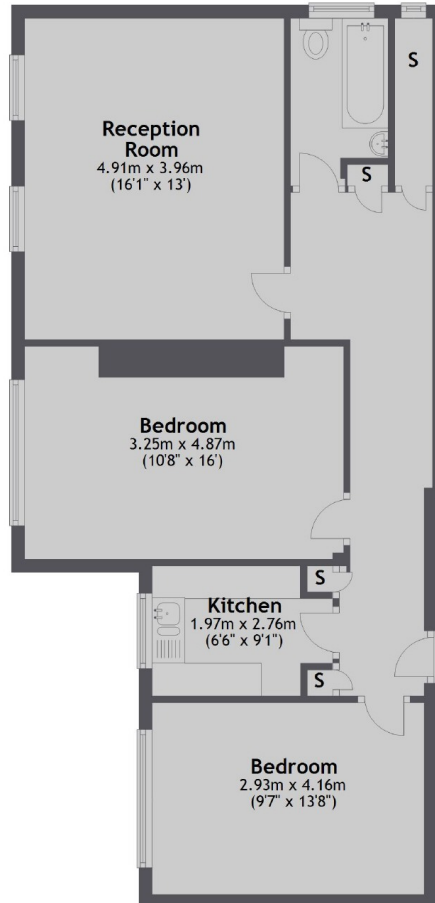

Total area: approx. 72.5 sq. metres (780.7 sq. feet)

Fletchers Chiswick Turnham Green
Sales
58 Turnham Green Terrace, London, W4
1QP
020 8987 3000

Energy Rating: C. We aim to make our particulars both accurate and reliable. However they are not guaranteed; nor do they form part of an offer or contract. If you require clarification on any points then please contact us, especially if you're traveling some distance to view. Please note that appliances and heating systems have not been tested and therefore no warranties can be given as to their good working order.