

Chard

— Lettings —



Sloane Avenue, SW3

£495 pw (£2,145 pcm)

This one bedroom seventh floor apartment in the Nell Gwynn House development has an open-plan reception with a fitted kitchen and tiled bathroom. Residents benefit from an on site porter and excellent local amenities and transport links.

Sloane Avenue is close to the many shops, bars and restaurants of Sloane Square and Kings Road. The property is moments away from Sloane Square station with many bus routes and alternative transport links also nearby.

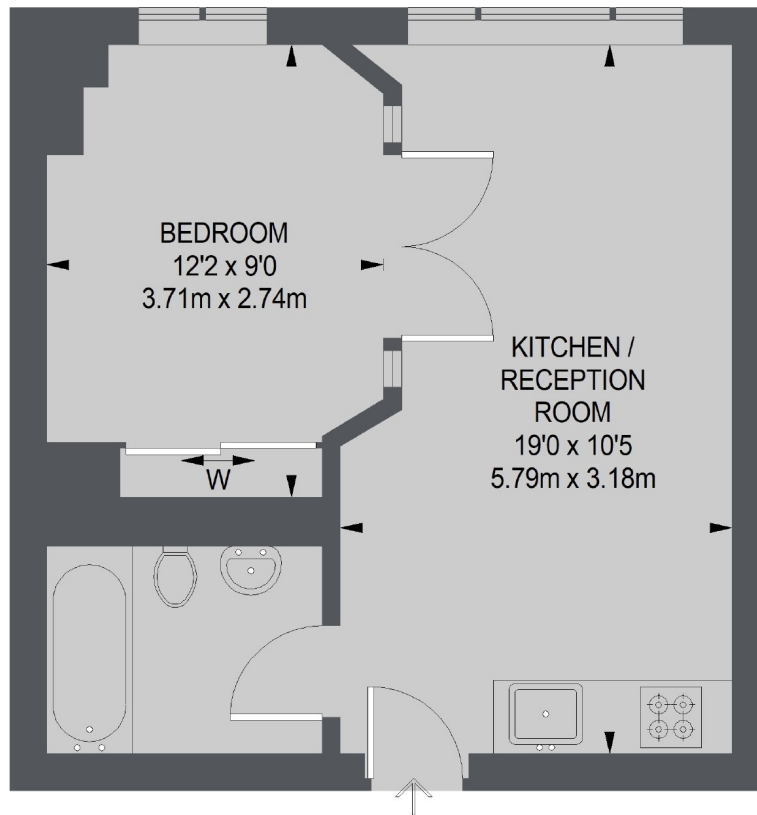

SEVENTH FLOOR

TOTAL APPROX. FLOOR AREA
351 SQ. FT. 32.65 SQ. M.)

Chard Fulham
5 Harwood Road,
London, SW6 4QP
020 7384 1400
fulhamlettings@chard.co.uk

Energy Rating: C. We aim to make our particulars both accurate and reliable. However they are not guaranteed; nor do they form part of an offer or contract. If you require clarification on any points then please contact us, especially if you're traveling some distance to view. Please note that appliances and heating systems have not been tested and therefore no warranties can be given as to their good working order.