



## Grange Road, W5

£475,000

This two bedroom apartment is conveniently located a short walking distance to various parks, shops and restaurants of the Broadway area. The flat has great potential for a new owner to refurbish to their own taste.

The flat is just half a mile from Ealing Broadway station (Crossrail, Central and District lines) as well as multiple bus routes available.

- Private Rear Garden • Own Entrance • No Onward Chain •
- Newly Extended Lease • Potential To Refurbish • Separate Kitchen •

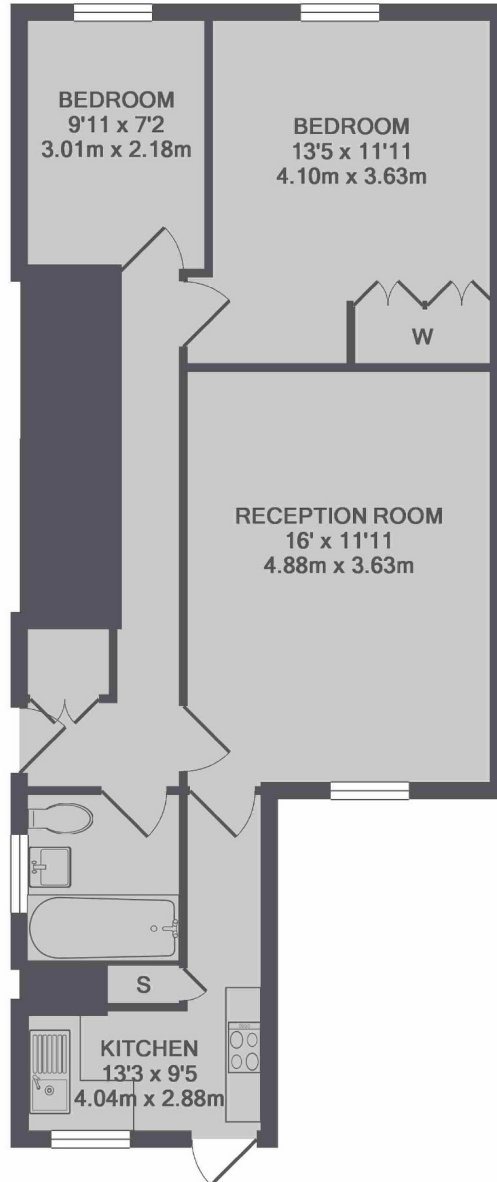

TOTAL APPROX. FLOOR AREA 606 SQ.FT. (56.3 SQ.M.)  
Made with Metropix ©2018

Robertson Smith & Kempson Ealing Sales  
1 The Broadway, London,  
W5 2NT  
020 8840 7677  
[ealingsales@robertsonsmithandkempson.co.uk](mailto:ealingsales@robertsonsmithandkempson.co.uk)

Energy Rating: E. We aim to make our particulars both accurate and reliable. However they are not guaranteed; nor do they form part of an offer or contract. If you require clarification on any points then please contact us, especially if you're traveling some distance to view. Please note that appliances and heating systems have not been tested and therefore no warranties can be given as to their good working order.