



Wheeler Road
Maidenbower, West Sussex RH10 7UF

£850

* A well presented one bedroom ground floor maisonette * Redecorated throughout * Ideally situated within a mile of Three Bridges train station * Double glazed * Allocated parking for two cars * Garden area to the front * UNFURNISHED * Newly fitted carpets & flooring *

Wheeler Road, Maidenbower, West Sussex RH10 7UF

Members of the property ombudsman
Members of CMP for client money protection
security deposit equivalent 5 weeks rent
reservation deposit equivalent of one weeks rent



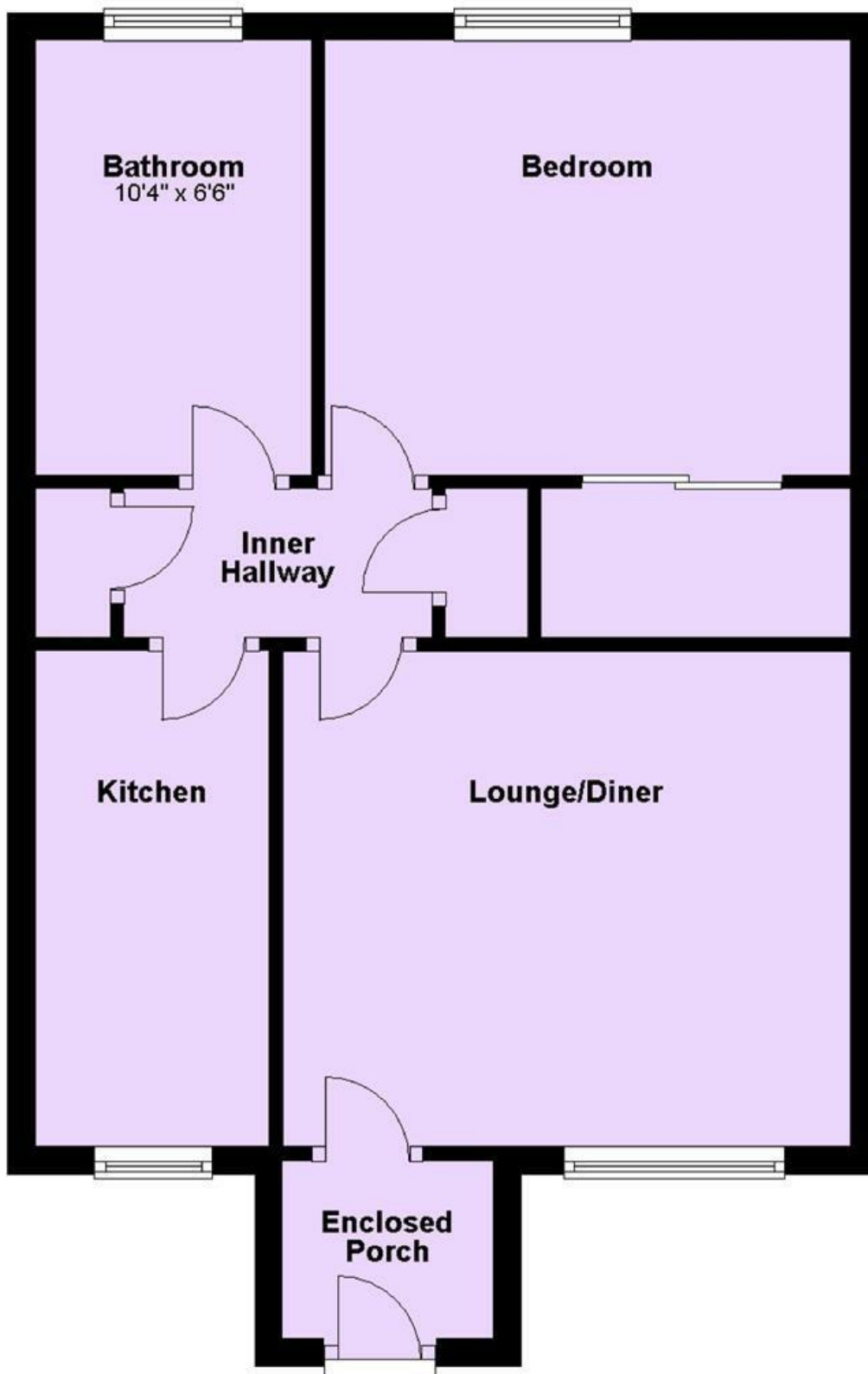

Energy Efficiency Rating		
	Current	Potential
Very energy efficient - lower running costs		
(92 plus) A		
(81-91) B		
(69-80) C		
(55-68) D		
(39-54) E		
(21-38) F		
(1-20) G		
Not energy efficient - higher running costs		
England & Wales	69	78
EU Directive 2002/91/EC		

Environmental Impact (CO ₂) Rating		
	Current	Potential
Very environmentally friendly - lower CO ₂ emissions		
(92 plus) A		
(81-91) B		
(69-80) C		
(55-68) D		
(39-54) E		
(21-38) F		
(1-20) G		
Not environmentally friendly - higher CO ₂ emissions		
England & Wales	51	63
EU Directive 2002/91/EC		