

Lakeside Drive, NW10

£499,950

A two bedroom top floor apartment with a private balcony overlooking the communal gardens.

In the popular Lakeside Drive development, within half a mile of both Park Royal and Hanger Lane stations.

- Two Bedrooms • Two Bathrooms • Top Floor •
- Underground Parking • Communal Gardens • No Onward

Fifth Floor

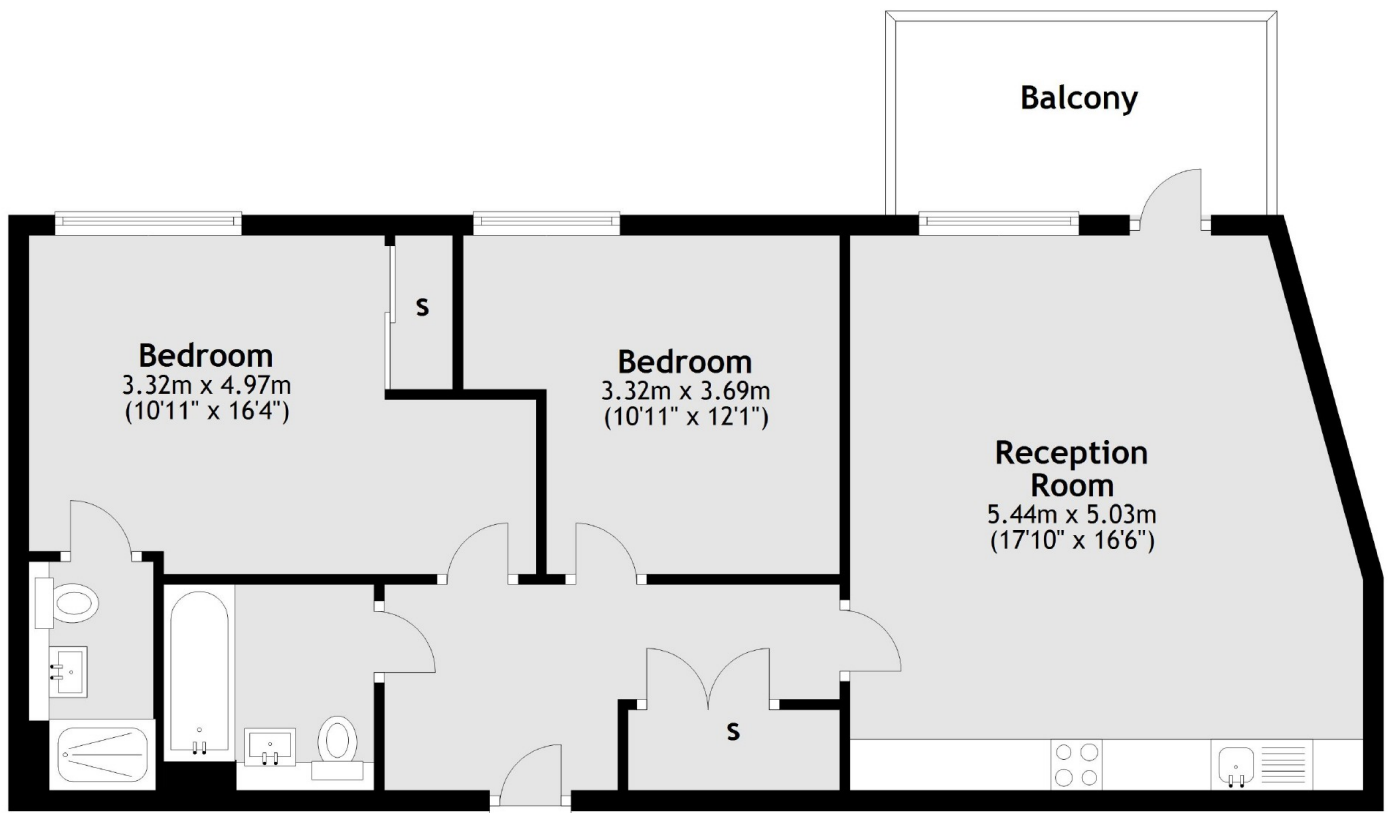

Main area: Approx. 69.6 sq. metres (748.9 sq. feet)
Plus balconies, approx. 7.3 sq. metres (78.3 sq. feet)

Robertson Smith & Kempson Acton Sales
98 High Street, London, W3
6QX
020 8896 3996
actonsales@robertsonsmithandkempson.co.uk

Energy Rating: B. We aim to make our particulars both accurate and reliable. However they are not guaranteed; nor do they form part of an offer or contract. If you require clarification on any points then please contact us, especially if you're traveling some distance to view. Please note that appliances and heating systems have not been tested and therefore no warranties can be given as to their good working order.