

SNELLERS

ESTATE AGENTS



Tudor Avenue, TW12

£849,950

A beautiful four bedroom Victorian home on a much sought after, tree lined road in Hampton Village. This character filled home is bright and spacious throughout with an extended kitchen/dining room and configured over three floors. An ideal family property with the ability to work from home in the well equipped garden home office/gym.



The ground floor has a lovely front reception room with shutters and a decorative fireplace. To the rear is a wonderful kitchen/dining room complete with an integrated kitchen, skylights and doors opening on to the lovely west facing rear garden.

On the first floor are two double bedrooms, a single bedroom and family bathroom. The second floor is home to the master bedroom with en suite shower room.

To the rear is a pretty garden with the added benefit of a lovely home office/gym with two separate working spaces, power light and internet access.

Tudor Avenue is a lovely tree lined avenue, ideally located off Broad Lane, less than half a mile to Hampton Village and mainline station

- Four Bedrooms • Two Bathrooms • Home Office/Gym •
- Period Features • Hampton Village • Open Plan Kitchen •



SNELLERS

ESTATE AGENTS

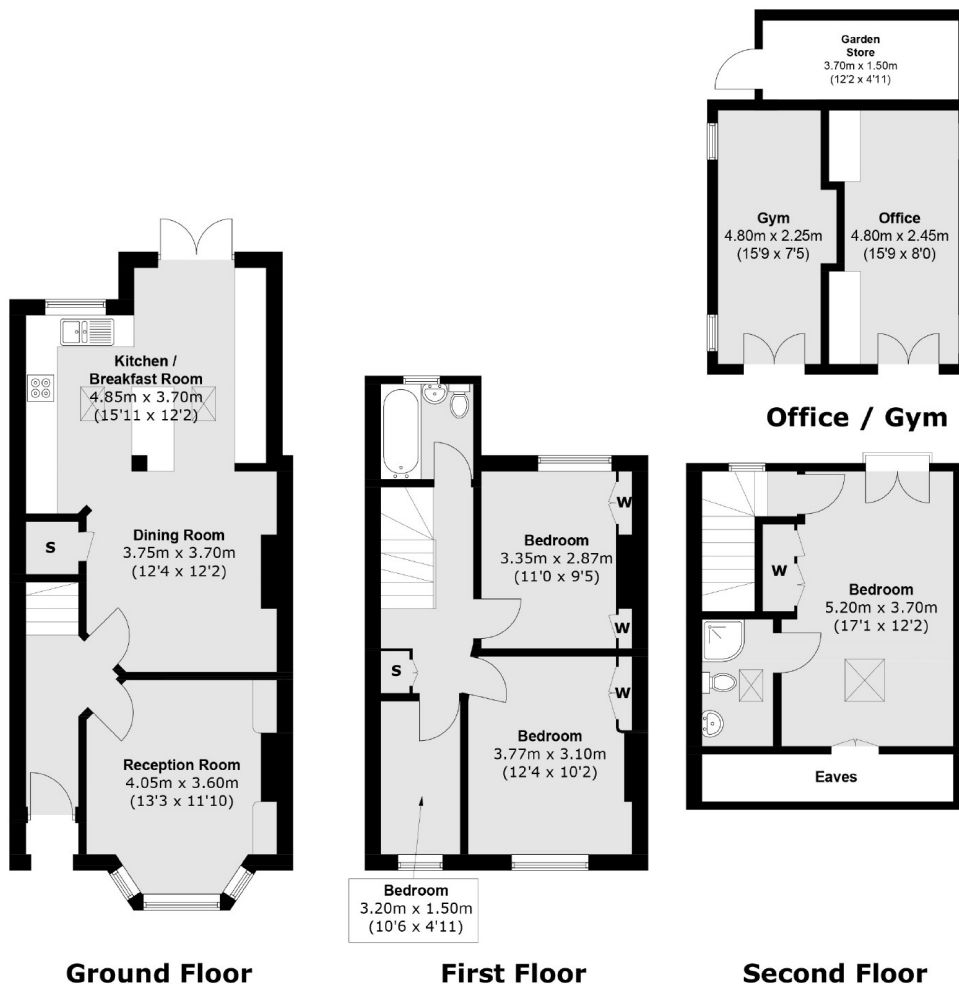

Total area (approx.): 112.9 sq. m (1215 sq. ft)
Home Office / Gym Total area (approx.): 21.8 sq. m (235 sq. ft)
(Excluding Garden Store)
Balcony Area : 0.2 sq. m (2.1 sq. ft)

Snellers Hampton Hill Sales
197-201 High Street
Hampton Hill
TW12 1NL
020 8783 0083
hamptonsales@snellers.co.uk

Energy Rating: D We aim to make our particulars both accurate and reliable. However they are not guaranteed; nor do they form part of an offer or contract. If you require clarification on any points then please contact us, especially if you're traveling some distance to view. Please note that appliances and heating systems have not been tested and therefore no warranties can be given as to their good working order