



## Empire Square East, SE1

£700,000

An immaculately presented apartment with a generous open plan modern kitchen, dining and living room, with ample room for storage

Empire Square is enviably located at the top of Long Lane, next to Borough High Street & Borough tube, with London Bridge Station just

• Cash Buyers Only • Two Bathrooms • Excellent Condition • Secure Parking & Cycle Storage • 24 Hr Concierge &

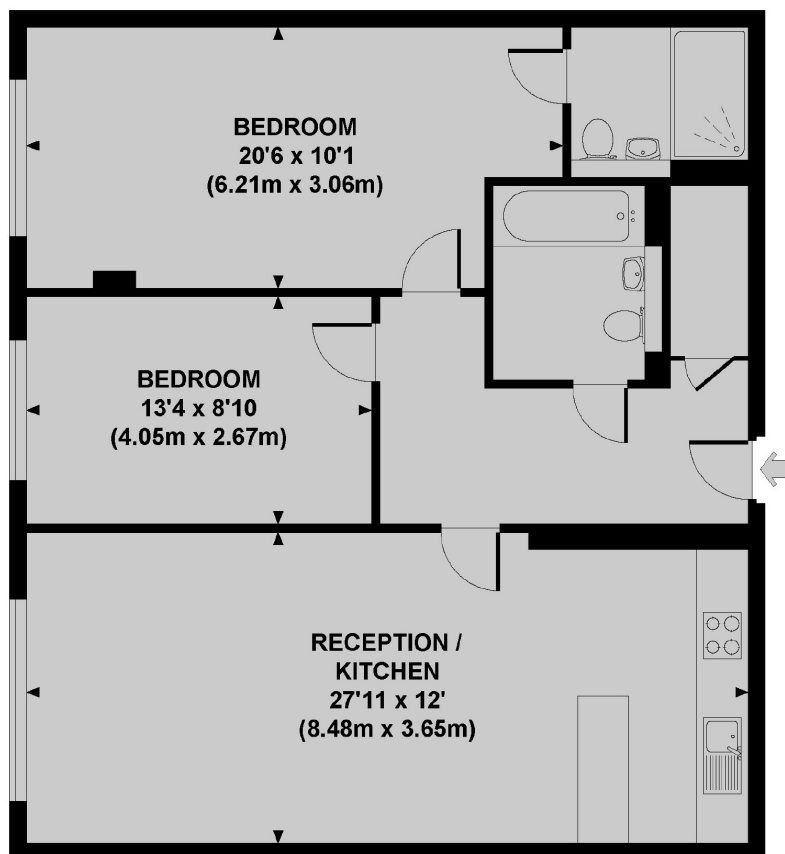

**Third Floor  
EMPIRE SQUARE EAST, SE1**

Approx. gross internal area  
874 Sq Ft. / 81.2 Sq M.

City Docklands  
205 Tooley Street  
London, SE1 2JX  
020 7234 0880  
[welcome@citydocklands.com](mailto:welcome@citydocklands.com)

Energy Rating: . We aim to make our particulars both accurate and reliable. However they are not guaranteed; nor do they form part of an offer or contract. If you require clarification on any points then please contact us, especially if you're traveling some distance to view. Please note that appliances and heating systems have not been tested and therefore no warranties can be given as to their good working order.