

SNELLERS

ESTATE AGENTS



Ridgway, TW10

£1,695 PCM

A modern two double bedroom, split-level apartment in a well-maintained portered block with lift and allocated parking. The property has a semi open-plan kitchen/reception with a private balcony overlooking communal gardens and a family bathroom.

Mount Ararat Road is close to Richmond town centre for a selection of local shops and easily accessible to as well as Richmond station, Richmond Park and a short walk to Richmond Hill for garden walks and views over the river.

- Purpose Built • Two Bedrooms • Spacious Reception •
- Private Balcony • Allocated Parking • Great Location •

SNELLERS

ESTATE AGENTS

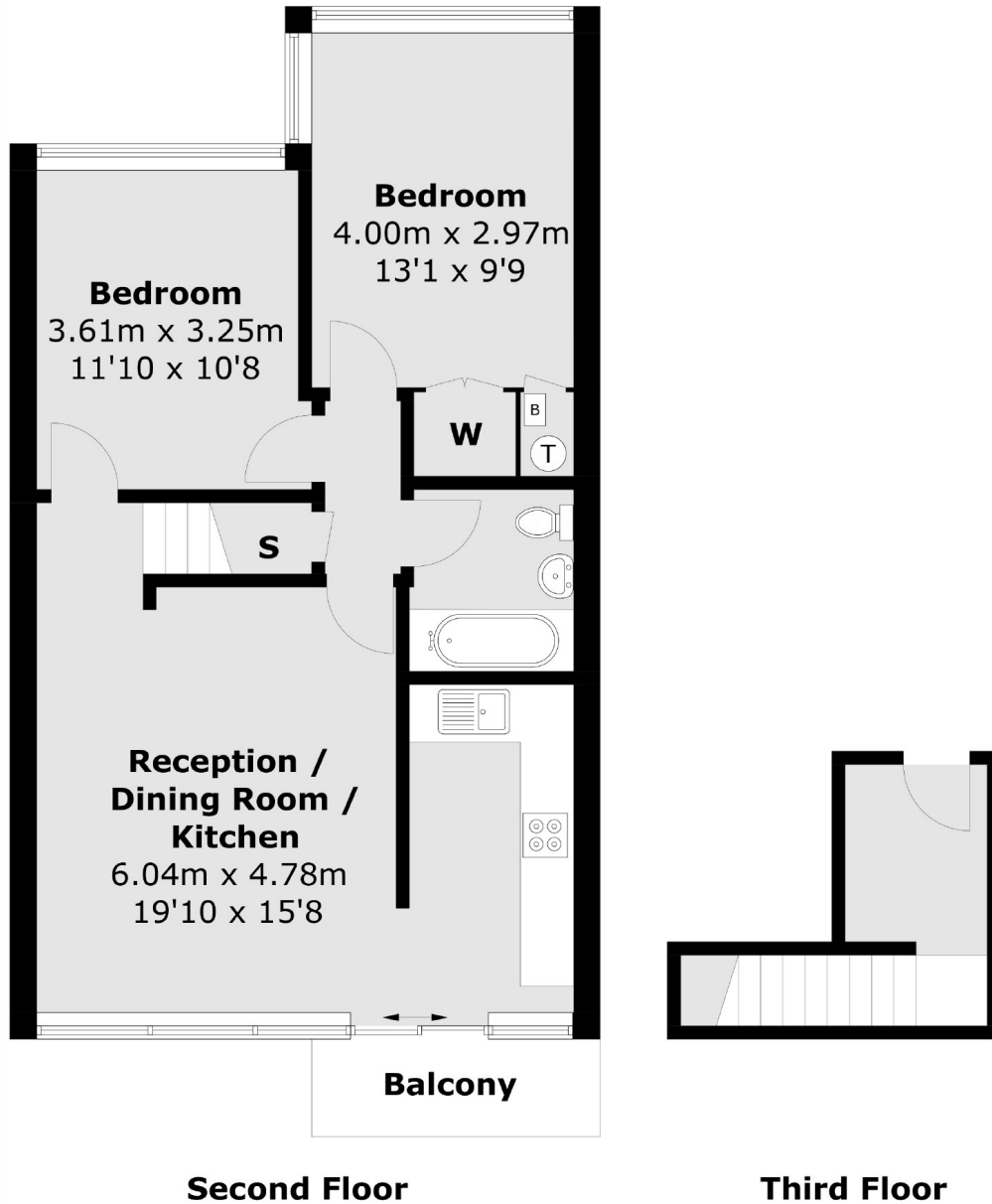

Total area (approx.): 68.4 sq. m (736 sq. ft)
Balcony: 3.6 sq. m (39 sq. ft)

Snellers St. Margarets Lettings
36 Crown Road
St Margarets
TW1 3EH
020 8892 0700
stmargaretslettings@snellers.co.uk

Energy Rating: D We aim to make our particulars both accurate and reliable. However they are not guaranteed; nor do they form part of an offer or contract. If you require clarification on any points then please contact us, especially if you're traveling some distance to view. Please note that appliances and heating systems have not been tested and therefore no warranties can be given as to their good working order