



Newington Causeway, SE1

£495,000

A highly attractive apartment, with two generous double bedrooms, two bathrooms, new double glazed windows, a spacious open plan

Elephant & Castle station has fantastic links into the City, via the Bakerloo & Northern Lines and Overground. London Bridge &

- Two Double Bedrooms - Two Bathrooms • Open Plan Kitchen & Living Room • 24 Hour Concierge • Gym, Sauna & Swimming

Fourth Floor

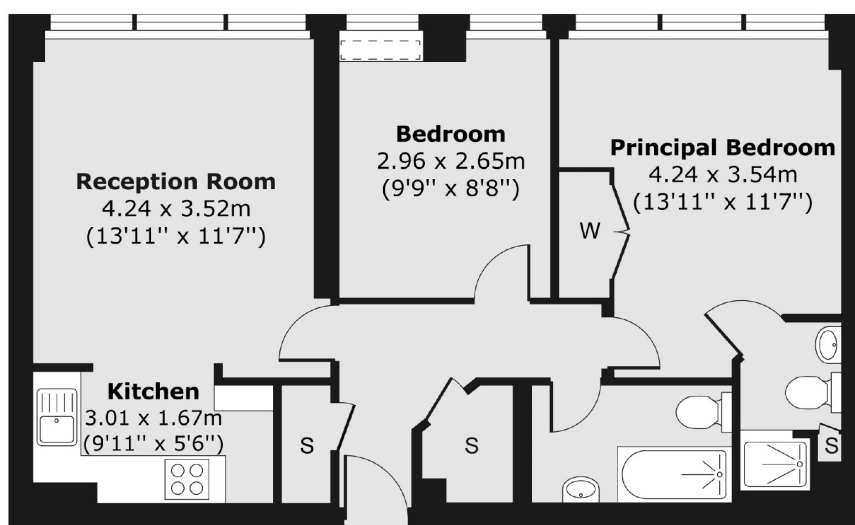

Total area (approx.) 58.48 sq. m (629 sq. ft)

City Docklands
205 Tooley Street
London, SE1 2JX
020 7234 0880
welcome@citydocklands.com

Energy Rating: . We aim to make our particulars both accurate and reliable. However they are not guaranteed; nor do they form part of an offer or contract. If you require clarification on any points then please contact us, especially if you're traveling some distance to view. Please note that appliances and heating systems have not been tested and therefore no warranties can be given as to their good working order.