

# FLETCHERS

ESTATE AGENTS



## Weston Road, W4

£999,950

A mid-terraced Victorian home is split over three floors, with a reception, dining room and a kitchen leading to a lovely private garden with rear access. There are four bedrooms in total, with further potential for extension (STPP).

Weston Road is in a great spot close to Chiswick Park station with the fabulous selection of boutiques, restaurants and independent retailers on the High Street just beyond.

- Four Bedrooms • Two Bathrooms • Two Reception Rooms • Separate Kitchen • Potential to Extend • Chiswick Park •

# FLETCHERS

ESTATE AGENTS

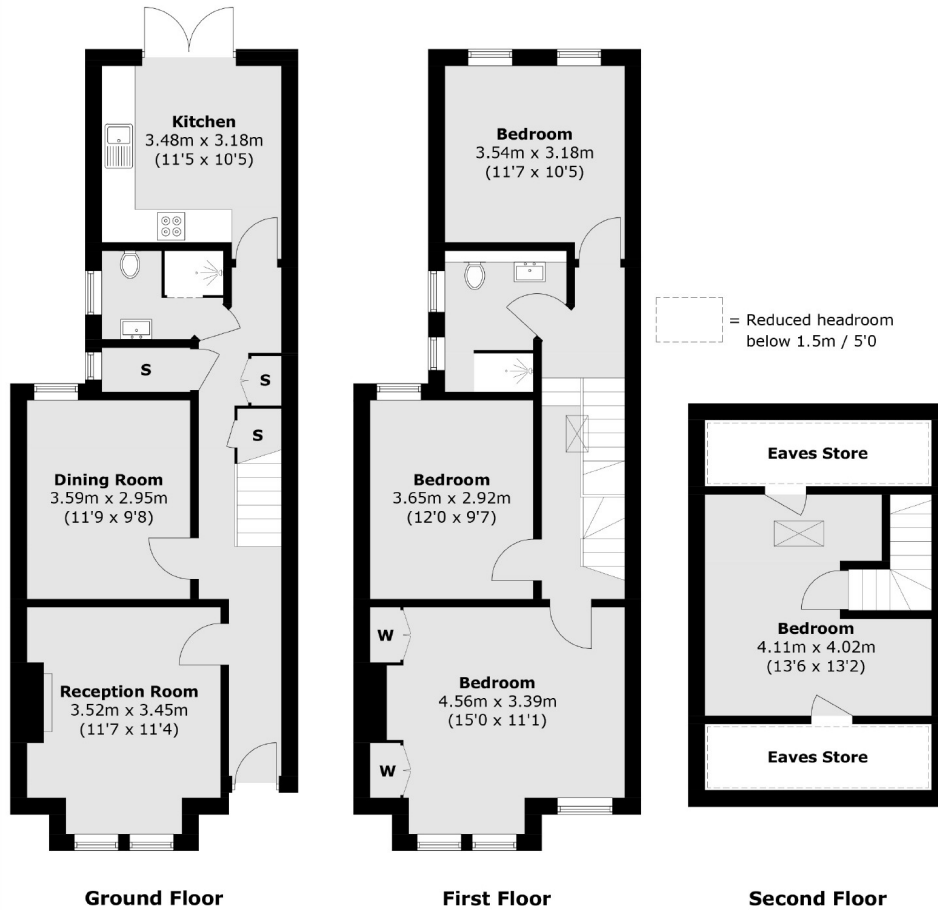

Total area (approx.): 124.6 sq. m (1,341.1 sq. ft)  
(Excluding Eaves Store)

Fletchers Chiswick Turnham Green Sales  
58 Turnham Green Terrace, London, W4 1QP  
020 8987 3000  
chiswicksales@fletcherestates.com

Energy Rating: E. We aim to make our particulars both accurate and reliable. However they are not guaranteed; nor do they form part of an offer or contract. If you require clarification on any points then please contact us, especially if you're traveling some distance to view. Please note that appliances and heating systems have not been tested and therefore no warranties can be given as to their good working order.