

24 Courtlands Avenue, Kew, TW9 4EP

£1350pcm

Furnished or Unfurnished



- Superb spacious 1 bedroom flat with private garden.
- Beautifully maintained and recently redecorated.
- 1st floor modern apartment situated at the end of a quiet cul-de-sac
- Large lounge
- Double bedroom
- Bathroom with shower over the bath
- Dining kitchen with all appliances
- Wooden floors throughout
- Double glazed
- Private garden with shed
- Permit on-street parking
  
- Close to Kew Retail Park and Kew Gardens Station (District Line)

Stunning 1 bedroom 1st floor flat situated on Courtlands Avenue, Kew so incredibly convenient for Kew Retail Park and Kew Gardens Station (District Line Tube)

The flat has a large living room with wooden floor, a modern kitchen with full size dishwasher, washer/dryer, large fridge/freezer and gas hob and oven. There is plenty of space to also eat in the kitchen too.

The stylish bathroom has a large mirrored wall and shower over the bath.

The great sized double bedroom has a wooden floor and the hallway has a fitted storage cupboard with hanging and shelving.

The private south-west facing paved garden is the perfect place to relax and with a useful garden shed, you can also keep your bike secure too.

Double glazed throughout.

This gorgeous flat will make someone a very happy home.

This property is in a fantastic location, so close to the shops at Kew Retail Park the independent shops and restaurants in Kew Village. It has excellent transport links: it is within a very short walk of Kew Gardens Station (District Line Tube) and positioned perfectly for very easy access to the M4/M3.

Council Tax Band C £1741.03 (2021/2022)

## Courtlands Avenue, Kew, TW9

Approximate Gross Internal Area = 40.1 sq m / 432 sq ft

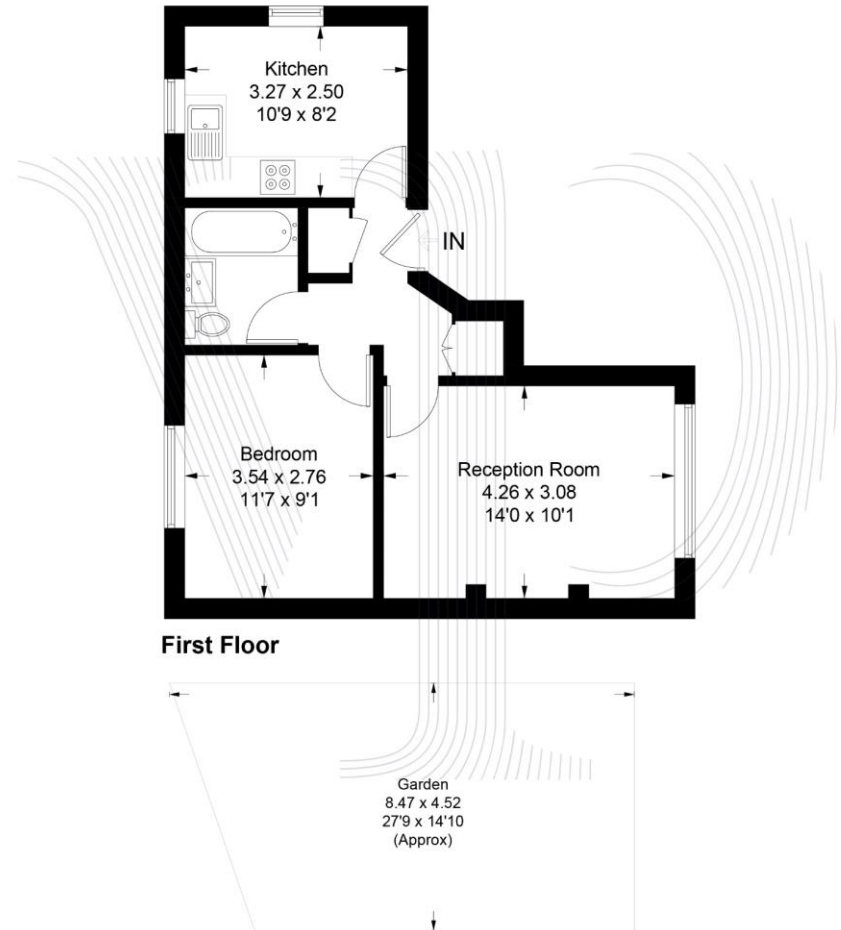

(Not Shown In Actual Location / Orientation)









