

Altenburg Avenue, W13

£850,000

A beautiful brick fronted period house situated on a much sought after road in the heart of Northfields.

Perfectly located for the excellent range of local schools, Piccadilly line tube and Lammas Park.



A beautiful brick fronted period house situated on arguably one of the finest roads on the west side of Northfield Avenue, perfectly located for Fielding Primary School (Ofsted outstanding).

Consisting of two reception rooms, guest wc and kitchen leading to a well maintained garden. First floor accommodation is a front double bedroom with built in storage, family bathroom, single bedroom, stairs leading to the loft extension where you will find the third bedroom.

A very well presented house in a great location, viewing is highly recommended.

- Three Bedrooms • Excellent Local Schools • Close To Shops •
 - Park Nearby • Brick Fronted • Good Transport Links •
-



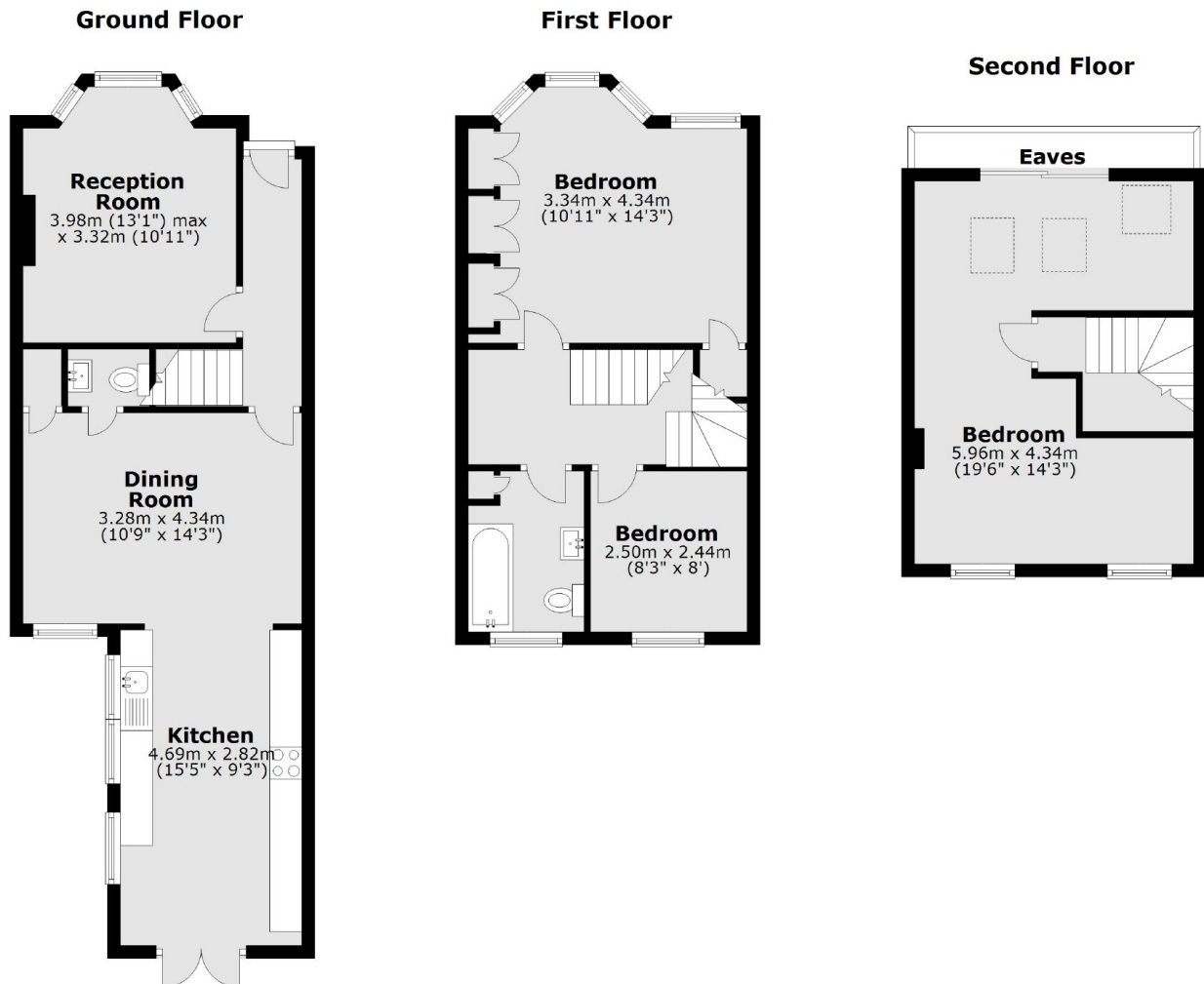

Total area: approx. 108.3 sq. metres (1165.3 sq. feet)

Robertson Smith & Kempson Northfields Sales
 116 Northfield Avenue,
 London, W13 9RT
 020 8566 2340
northfieldssales@robertsonsmithandkempson.co.uk

Energy Rating: . We aim to make our particulars both accurate and reliable. However they are not guaranteed; nor do they form part of an offer or contract. If you require clarification on any points then please contact us, especially if you're traveling some distance to view. Please note that appliances and heating systems have not been tested and therefore no warranties can be given as to their good working order.