



Connells

Chalkdown
Luton



Property Description

Situated in the popular Bushmead area of North Luton, Connells offer this two bedroom family home. This area of Luton, as well as being close to all local amenities, offers great easy access to local commuting routes. Call Connells now on 01582 592 332.

Entrance Hall

Door to front aspect. Radiator.

Lounge

14' 4" x 11' 11" max (4.37m x 3.63m max)
Double glazed window to rear aspect. Double glazed French door. Radiator.

Kitchen

9' 9" x 5' 9" (2.97m x 1.75m)
Double glazed window to front aspect. Fitted kitchen comprising a range of wall and base units with work surfaces over incorporating a stainless steel sink and drainer unit. Part tiling. Electric oven with gas hob. Plumbing for a washing machine. Space for a fridge and freezer.

First Floor Landing

Stairs leading from entrance hall. Loft access.

Bedroom One

12' x 9' 2" (3.66m x 2.79m)
Double glazed window to front aspect. Radiator.

Bedroom Two

11' 11" x 7' 9" (3.63m x 2.36m)
Double glazed window to front aspect. Radiator.

Bathroom

Double glazed window to side aspect. Suite comprising bath with mixer taps and shower attachment, wash hand basin and low level wc. Fully tiled. Radiator.

Rear Garden

Decking area. Shed.

Parking

Allocated parking for two vehicles.



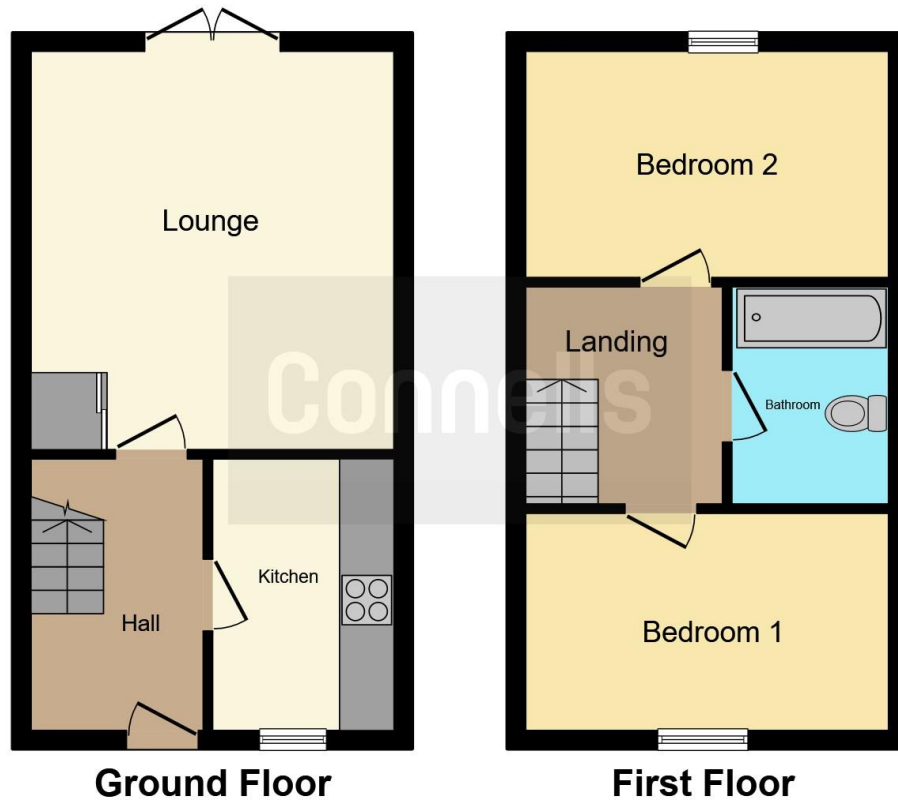

This floorplan is for illustrative purposes only and is not drawn to scale. Measurements, floor-areas, openings and orientations are approximate. They should not be relied upon for any purpose and do not form any part of an agreement. No liability is taken for any error or mis-statement. All parties must rely on their own inspections.

To view this property please contact Connells on

T 01582 592332
E lutonnorth@connells.co.uk

1A Riddy Lane
 LUTON LU3 2AD

EPC Rating: D

view this property online connells.co.uk/Property/ref-LUN101506

Tenure: Freehold



1. MONEY LAUNDERING REGULATIONS Intending purchasers will be asked to produce identification documentation at a later stage and we would ask for your co-operation in order that there will be no delay in agreeing the sale. 2. These particulars do not constitute part or all of an offer or contract. 3. The measurements indicated are supplied for guidance only and as such must be considered incorrect. Potential buyers are advised to recheck measurements before committing to any expense. 4. We have not tested any apparatus, equipment, fixtures, fittings or services and it is in the buyers interest to check the working condition of any appliances.

See all our properties at www.connells.co.uk | www.rightmove.co.uk | www.zoopla.co.uk

Property Ref: LUN101506 - 0005