

# FLETCHERS

ESTATE AGENTS

---



## Goldhawk Road, W6

£425,000

A two bedroom apartment located in a highly sort-after art-deco 1930's building near Ravenscourt Park. The flat is located on the third floor of the building with lift-access.

Stamford Court sits on the borders of Hammersmith and Chiswick with Ravenscourt Park, the River Thames and Chiswick High Road close by. There is easy access to central London via the A4, and via the M4 for Heathrow Airport. Stamford Brook Underground station (District line) is on the opposite side of the road.

- Two Bedrooms • Third Floor • Light & Airy • Separate Kitchen • Lift-Access • Porter •

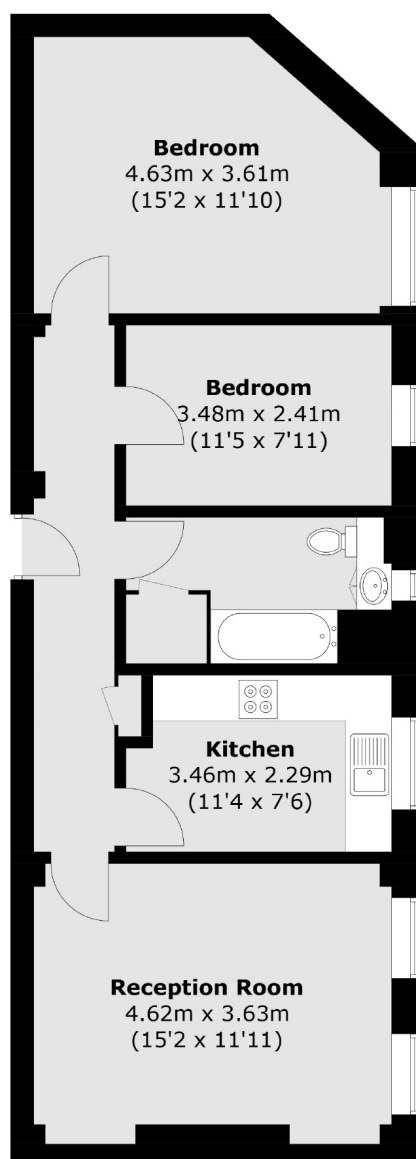

### Third Floor

Total area (approx.): 65.6 sq. m (706.1 sq. ft)

Fletchers Brook Green Sales  
144 Shepherds Bush Road, Hammersmith, London, W6 7PB  
020 7603 1415  
[brookgreensales@fletcherestates.com](mailto:brookgreensales@fletcherestates.com)

Energy Rating: C. We aim to make our particulars both accurate and reliable. However they are not guaranteed; nor do they form part of an offer or contract. If you require clarification on any points then please contact us, especially if you're traveling some distance to view. Please note that appliances and heating systems have not been tested and therefore no warranties can be given as to their good working order.