

Brixton Hill | London, SW2



£330,000
Leasehold

Brixton Hill | London, SW2



Located in this sought after 1930's block at the foot of Brixton Hill is a charming first floor, one bedroom apartment. The property features a well proportioned reception room that is large enough to house a dining space and leads into a well functioning kitchen. The bedroom is a good sized double with space to house a large wardrobe and the bathroom is modern and fully tiled with three piece suite. The flat has a light and airy feel to it, complemented by natural oak wooden flooring throughout. The current vendor has ensured that the property is finished with clean lines and has a homely feel. The block is complete with a small communal garden to the rear and security entryphone system. Perfect as a first time buy and equally popular as a rental investment. The apartment block is ideally located a stone's throw from the amenities, bars and restaurants of Brixton. Brixton rail and tube stations, Ritzy cinema, the eateries and shops of Brixton Village, Brixton (O2) Academy and Brockwell Park are all within a short distance.

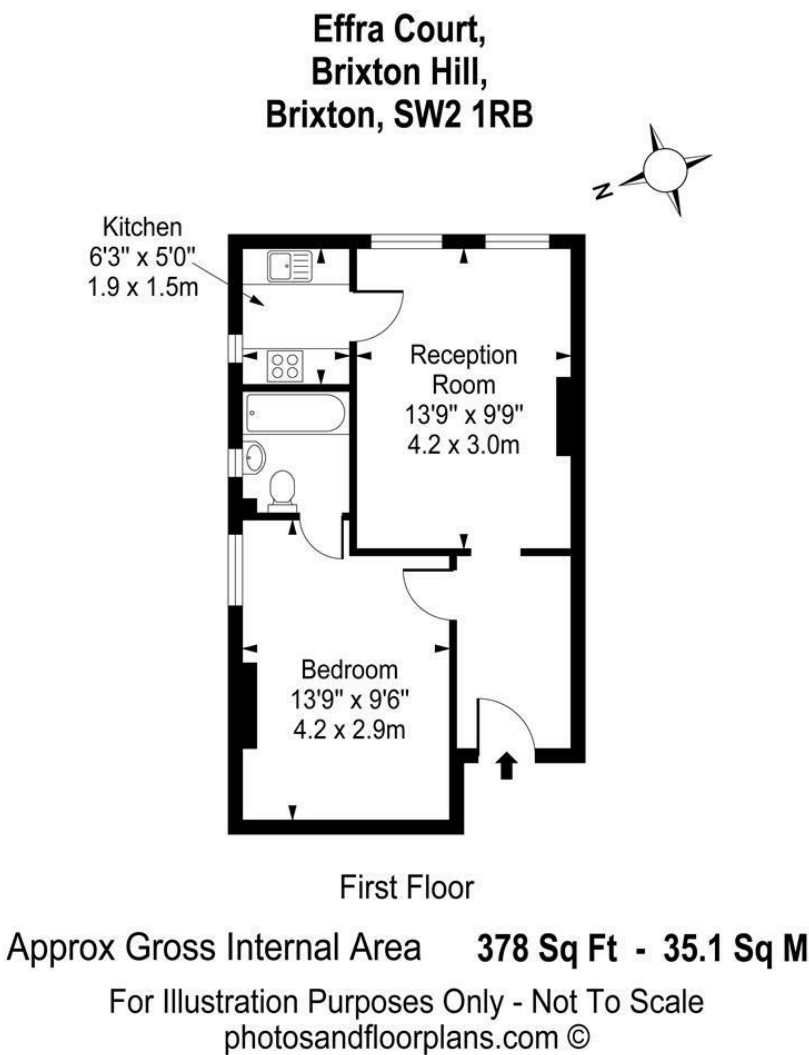

Energy Efficiency Rating		
	Current	Potential
Very energy efficient - lower running costs		
(92 plus) A		
(81-91) B		
(69-80) C		
(55-68) D		
(39-54) E		
(21-38) F		
(1-20) G		
Not energy efficient - higher running costs		
England & Wales		
EU Directive 2002/91/EC		
Environmental Impact (CO ₂) Rating		
	Current	Potential
Very environmentally friendly - lower CO ₂ emissions		
(92 plus) A		
(81-91) B		
(69-80) C		
(55-68) D		
(39-54) E		
(21-38) F		
(1-20) G		
Not environmentally friendly - higher CO ₂ emissions		
England & Wales		
EU Directive 2002/91/EC		

These particulars are designed to provide a guideline only and cannot be relied upon as a statement of fact. The description represents the opinion of the author and is not intended to provide false or misleading information. Any prospective purchaser should make further checks on its accuracy. All measurements are approximate and floorplans are for representation only.



Eden Harper
3 Arlington Parade, Brixton Hill, Brixton, SW2 1RH
0207 274 3111
brixsales@edenharper.com
www.edenharper.com