



x2



x2



x1



**Dering Close, Coventry**  
**Asking Price £180,000**





This modern 2 bedroom, semi-detached house is offered 'For Sale' with no upward chain. Benefiting from solar panels and briefly comprising of: Entrance Hallway, Ground Floor W.C. Fitted kitchen, spacious lounge with French doors leading to an enclosed rear garden and stairs raising to the first which consists of two double bedrooms and a family bathroom.

The property also benefits from gas central heating, double glazing and driveway parking to the front of the property.

- EPC Rating: C
- Semi-Detached House
- Gas Central Heating & Double Glazing
- Driveway Parking
- Solar Panels
- Two Double Bedrooms
- Ground Floor W.C
- Close To Local Amenities
- No Upward Chain
- Easy Access For Motorway Networks

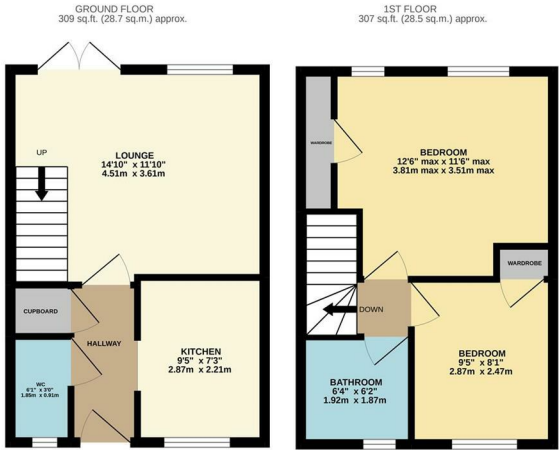

PLEASE NOTE: General Information

We have been informed by the vendor that the tenure of the property is Freehold. However, you are recommended to have this information verified by your legal advisor at the earliest opportunity. All measurements are approximate and quoted in metric and are for general guidance only and whilst every attempt has been made to ensure accuracy, they must not be relied on. The fixture, fittings and appliances referred to have not been tested and therefore no guarantee can be given that they are in working order. Internal photos are produced for internal general information and it must not be inferred that any item would be included within the sale.

**Elite Property**  
**Sterling House, 112 Walsgrave Road, Stoke, Coventry, West Midlands, CV2 4ED**  
**Tel: 024 7665 2200**  
**www.eliteproperty.co**

