



- Freehold
- Modern kitchen
- Large living space
- Two bedrooms

Partridge Road, Hampton

A stunning two bedroom mid-terraced family home situated in a convenient location.

£450,000



Property Description

A stunning two bedroom mid-terraced family home situated in a convenient location. The property is in excellent order throughout and the living space comprises of a front door to entrance hall, a large reception room and a modern open plan kitchen/dining room. On the first floor there is a well proportioned master bedroom with a walk-in style wardrobe, one further bedroom and a contemporary family bathroom. Further benefits include off street parking, loft access ideal for storage and a rear garden stretching over 35ft.

Location

Partridge Road is a convenient and sought after location being close to Sainsbury's and some outstanding local schools. Hampton Common and Carlisle Park are both nearby along with excellent transport links including Hampton Station with its direct route to Waterloo.





Partridge Road, TW12 Approx. Gross Internal Area 752 Sq Ft - 69.86 Sq M

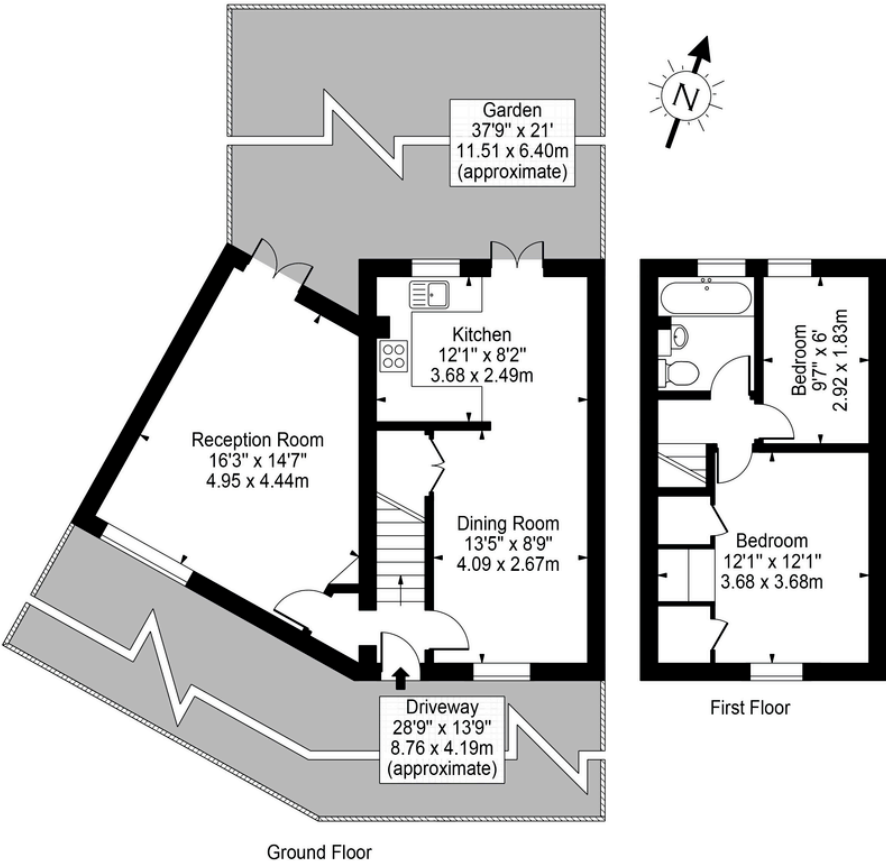

Ground Floor

For Illustration Purposes Only - Not To Scale Floor Plan by Mira Nikolova Photography

This floor plan should be used as a general outline for guidance only and does not constitute in whole or in part an offer or contract. Any intending purchaser or lessee should satisfy themselves by inspection, searches, enquiries and full survey as to the correctness of each statement. Any areas, measurements or distances quoted are approximate and should not be used to value a property or be the basis of any sale or let.

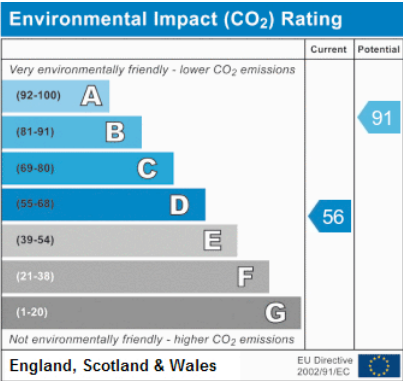
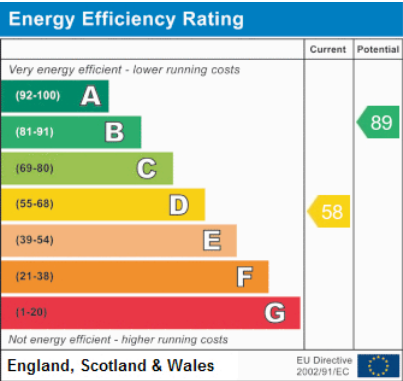

www.griffinsteven.co.uk

020 8979 1597

enquiries@griffinsteven.co.uk

Agents Note: Whilst every care has been taken to prepare these sales particulars, they are for guidance purposes only. All measurements are approximate are for general guidance purposes only and whilst every care has been taken to ensure their accuracy, they should not be relied upon and potential buyers are advised to recheck the measurements