



16 Tallington Road

Barholm, Stamford, PE9 4RE

£795 Per Calendar Month

Richardson

16 Tallington Road

Barholm, Stamford, PE9 4RE

UNDER-APPLICATION 3 bedroom end of terrace cottage with oil fired central heating and log burner.

Location

The property is situated opposite the Church in the centre of the small village of Barholm, approximately 7 miles from Stamford and Bourne.

Description

3 bedroom end of terrace cottage with oil fired central heating and log burner.

Kitchen

15'9" x 10'9" (4.82 x 3.28)

Fitted with a range of cupboards and laminate worktops with tiled splashbacks. Separate pantry cupboard. Windows to rear and side elevations and door to garden. Door to sitting room.

Living Room

13'5" x 12'11" (4.11 x 3.95)

With log burner and window to frontage.

Bathroom

6'10" x 6'1" (2.09 x 1.86)

Modern white 3 piece suite with shower over bath.

First Floor

Bedroom 1

12'3" x 8'9" (3.75 x 2.67)

Window to front elevation.

Bedroom 2

10'9" x 6'11" (3.29 x 2.12)

Window to side elevation.

Bedroom 3

12'11" x 7'4" (3.94 x 2.25)

Window to rear.





Garden

Enclosed garden with outbuildings and oil fired boiler.

Outbuilding

Stone outbuilding with light and power and plumbing for washing machine with worktop over.

Tenure

The property is available on an Assured Shorthold Tenancy as specified under the Housing Act 1988 and amended under the Housing Act 1996.

Services

Mains water, electricity and drainage are connected.

Rent

The rent is payable monthly in advance, by standing order.

Deposit

Five weeks' rent payable in advance to be returned after deductions and without interest at the end of the tenancy. The deposit amount for this property is £917.

Council Tax

The Council Tax Band for the property is Band B.

Viewing

All viewings strictly by appointment through Richardson, 01780 758000.

Floor Plan

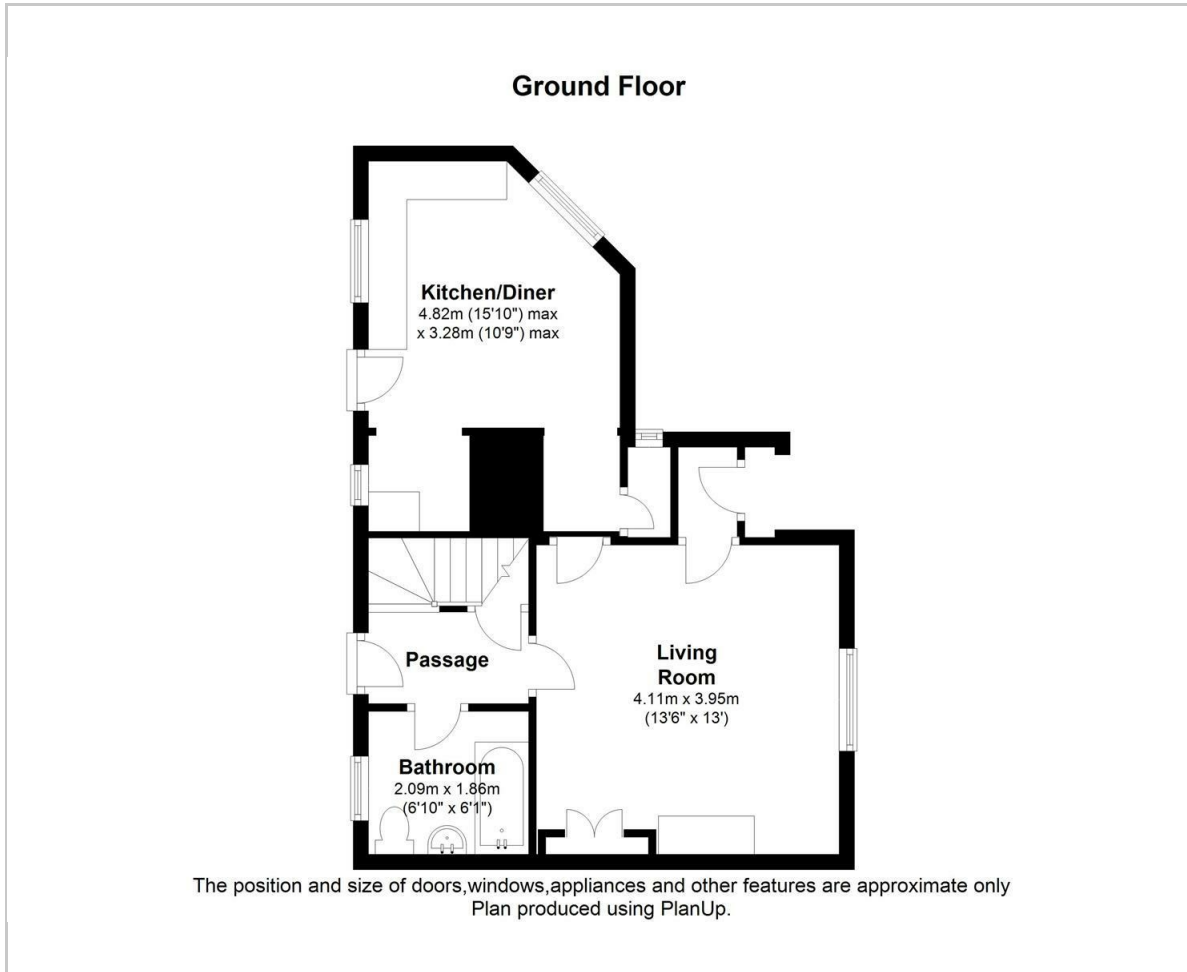

Area Map



Energy Efficiency Graph

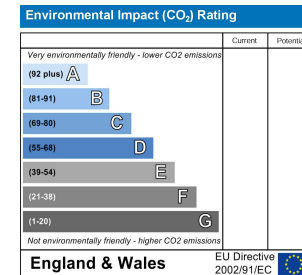
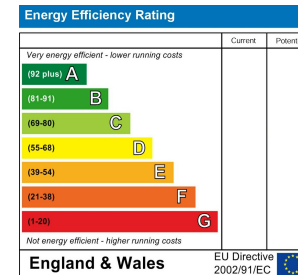

IMPORTANT NOTICE - Richardson for themselves and the Vendors or Lessors of this property whose agents they are given notice that:

1. The particulars are intended to give a fair and substantially correct overall description for the use and the guidance of intending purchasers and do not constitute, nor constitute any part of an offer or contract. Prospective purchasers and lessees should seek their own professional advice.
2. All descriptions, dimensions, reference to condition and necessary permissions for the use and occupation and their details are given in good faith, and are believed to be correct, but any intending purchaser or tenants should not rely on them as statements or representations of fact but must satisfy themselves by inspection or otherwise to the correctness of each or them.
3. No person in the employment of Richardson has the authority to make or give any representation or warranty whatever in relation to this property on behalf of Richardson, nor enter into any contract on behalf of the vendor.
4. No responsibility can be accepted for any expenses incurred by intending purchasers or lessees in inspecting properties which have been sold, let or withdrawn.

MEASUREMENTS AND OTHER INFORMATION - All measurements are approximate. Whilst we endeavour to make our sales details reliable, if there is any point which is of particular importance to you, please contact the agent, who will be pleased to check the information for you, especially if you will be travelling some distance to view the property. Electrical and other appliances mentioned within the sale particulars have not been tested by Richardson, therefore prospective purchasers must satisfy themselves as to their working order. The sale is subject to all rights of support, public and private rights of way, water, light, drainage and other easements, quasi-easements and way leaves, all other rights, whether mentioned in these particulars or not.

MONEY LAUNDERING REGULATIONS intending purchasers will be asked to produce identification and proof of financial status when an offer is received. We would ask for your co-operation in order that no delay in agreeing a sale.

Sheep Market, Stamford, Lincs, PE9 2RB

www.richardsonstateagents.co.uk

01780 762433