

23, Barncliffe Road, Sheffield, S10 4DF

23, Barncliffe Road

Sheffield, S10 4DF

Description

A lovely 1960's semi detached property with accommodation over two floors and offering potential for extensions at the side, rear or via the attic (subject to the necessary consent). The property occupies a super position in this most desirable neighbourhood, close to the highly regarded schooling, the local park and countryside walks alongside local shops and more comprehensive amenities which can be found at Crosspool or in Fulwood Village. Number 23 is coming to the market with no onward chain and although requiring a general scheme of modernisation the property does have full UPVC double glazing, gas central heating and a large, detached garage that is situated in the rear garden.

- Three bedrooms including two good doubles.
- Sitting room with bay window.
- Dining room overlooking the pretty garden.
- Fitted kitchen with access to the garden.
- Ground floor W.C, bathroom and further W.C on the first floor.
- Off road parking for at least one car with drive leading past the house to the rear.
- Rear garden, mainly laid to lawn with a small patio.
- Detached garage/store.
- UPVC double glazing and gas central heating.
- No onward chain.





Ground Floor
46 sq m/495.13 sq ft
Approx.

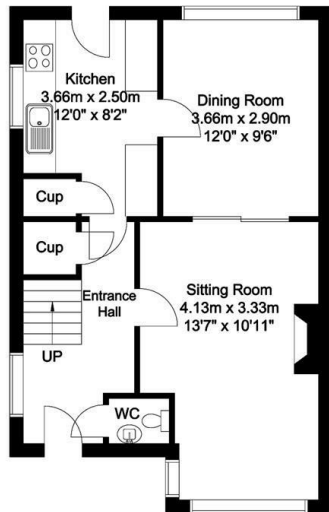

First Floor
43 sq m/462.84 sq ft
Approx.

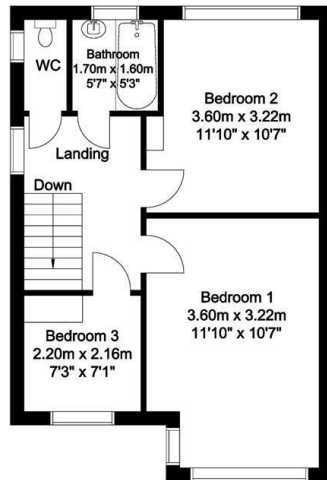

Outbuilding
13 sq m/139.93 sq ft
Approx.

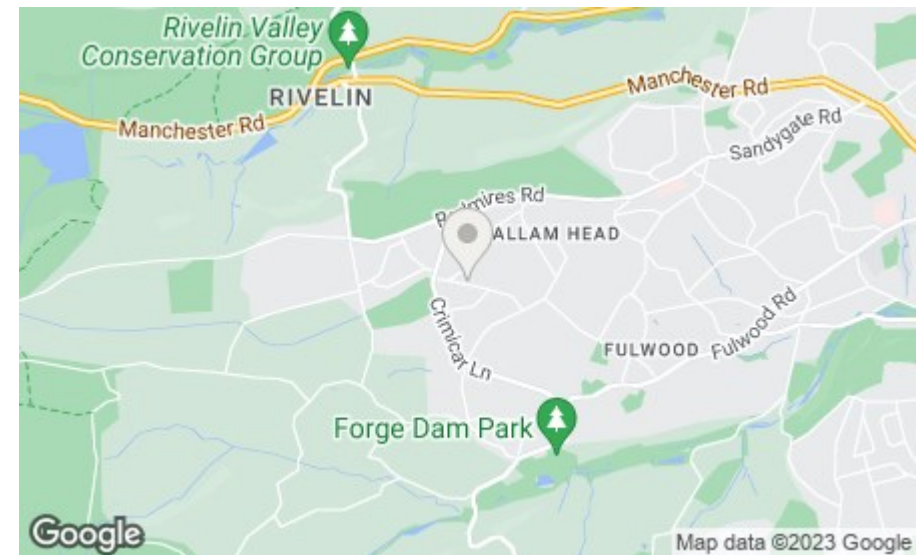
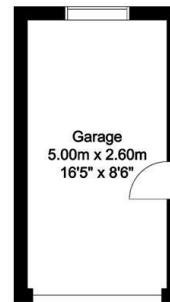

Whilst every attempt has been made to ensure the accuracy of the floor plan contained here, no responsibility is taken for incorrect measurements of doors, windows, appliances and room or any error, omission or misstatement. Exterior and interior walls are drawn to scale based on interior measurements. Any figure given is for initial guidance only and should not be relied on as a basis of valuation. These plans are for marketing purposes only and should be used such by any prospective purchase. Specially no guarantee is should not be relied on as a basis of valuation. These plans are for marketing purposes only and should be used such by any prospective purchase. Specially no guarantee is given on the total square footage of the property if quoted this plan.
CP Property Services ©2022

Bakewell
3 Royal Oak Place
Matlock Street
Bakewell DE45 1HD
T: 01629 700699
E: bakewell@elr.co.uk

Banner Cross
888 Ecclesall Road
Banner Cross
Sheffield S11 8TP
T: 01142 683388
E: bannercross@elr.co.uk

Dore
33 Townhead Road
Sheffield
S17 3GD
T: 0114 2362420
E: dore@elr.co.uk

Hathersage
Main Road, Hathersage
Hope Valley
Derbyshire S32 1BB
T: 01433 651888
E: peakdistrict@elr.co.uk

Rotherham
149 Bawtry Road
Wickersley
Rotherham S66 2BW
T: 01709 917676
E: wickersley@elr.co.uk

**EADON
LOCKWOOD
& RIDDLE**
ESTD 1840

All rooms have been measured with electronic laser and are approximate measurements only. None of the services to the above property have been tested by ourselves, and we cannot guarantee that the installations described in the details are in perfect working order. Eadon Lockwood & Riddle for themselves, and for the vendors or lessors, produce these brochures in good faith, and are a guideline only. They do not constitute any part of a contract and are correct to the best of our knowledge at the time of going to press.