

Toddington Office:

01525 877 300



HOUSEHOLD
estate agents

Residential Sales • Property Management • Lettings

13 Witham Court, Bletchley, Milton Keynes, MK3 7QU

£825 Per Calendar Month



BRIGHT & SPACIOUS BUNGALOW WITH A PRIVATE GARDEN. Additional benefits include MODERN FITTED KITCHEN, MODERN BATHROOM, LARGE LOUNGE DINER, PRIVATE PARKING, DOUBLE GLAZING, AVAILABLE IN APRIL on an UNFURNISHED BASIS.

WITHAM COURT is located just on the outskirts of BLETCHLEY and is within a commutable distance to all of it's amenities including local shops and schools. To fully appreciate the fantastic benefits on offer please contact your local HOUSEHOLD LETTING AGENTS office without further delay to arrange an appointment to view.

• Bright and spacious Bungalow • Modern Fitted Kitchen • Modern Bathroom • Private Garden • Quiet Location • Unfurnished • Available in April • Parking • One double bedroom

For details on all of our properties for sale and for rent visit **www.house-hold.co.uk**

PRS Property
Redress
Scheme

Zoopla.co.uk

movewithus
recommended agent

nTheMarket.com

rightmove
find your happy

The Property Experts with the Personal Touch

Ground Floor

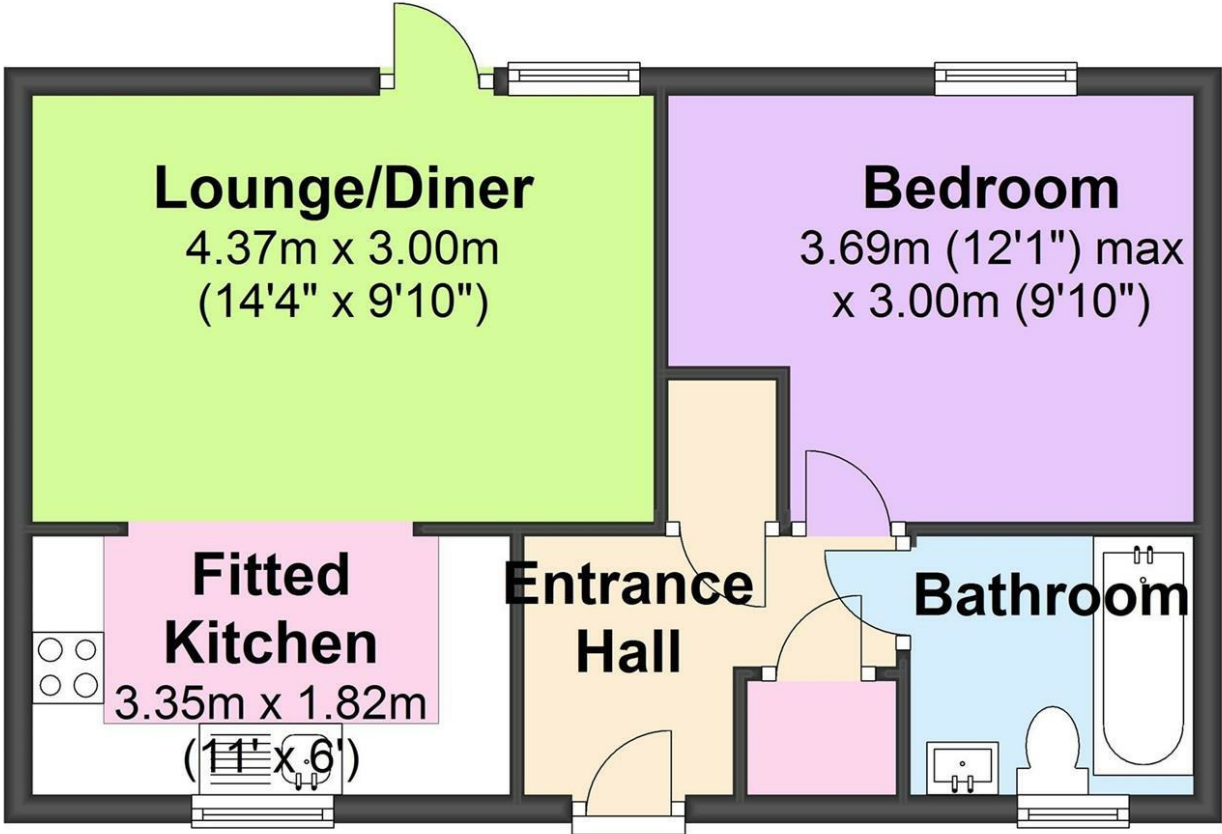

EPC

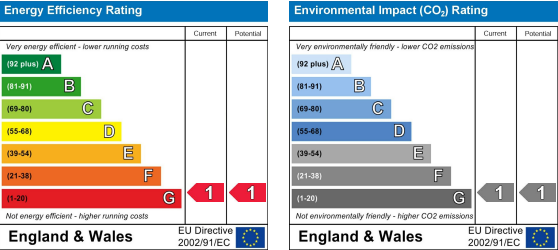

address: 2-4 High Street, Toddington, Bedfordshire LU5 6BY Additional Office: Dunstable: 15b High Street North - 01582 608 911

telephone: 01525 877 300

email: lettings@house-hold.co.uk

website: www.house-hold.co.uk

The Property Experts with the Personal Touch

MISDESCRIPTIIONS ACT: Household Estate Agents Ltd. For themselves and for the vendors of this property, whose agents they are, give notice that the particulars are set out as a general outline only for the guidance of intended purchasers and do not constitute or constitute part of any offer or contract. All descriptions, dimensions reference to condition and necessary permissions for use and occupation and other details are given without responsibility, and any intending purchasers should not rely upon them as statements or representations of fact but must satisfy themselves by inspection or otherwise as to their correctness. No person in the employment of Household Estate Agents Limited has any authority to give or make any representation or warranty whatsoever in relation to this property.