



## Chatsworth Road, NW2

### Leasehold - £1,250,000

For Sale is this beautiful three bedroom Garden Flat offering 1,370 sq ft of well laid out accommodation, situated on a pretty tree lined street.

The property has been impeccably designed throughout and comprises a double reception room with a feature fireplace and parquet flooring, flowing into the stunning kitchen with direct access to the 120 ft rear garden through bi-folding doors. Additionally, there is the bay fronted main bedroom with fitted wardrobes and an ensuite shower room, two good sized bedrooms which are serviced by a family bathroom and a study. The property is offered with a long lease and off-street parking.

Located in a great position just moments away from the hustle and bustle of Walm Lane with excellent transport links via Willesden Green (Jubilee - Zone 2). This area is very popular with those looking for excellent living space with an easy commute into Central London.

- Beautiful modern 3 bedroom Garden Flat
- Boasting 1,370 sq ft of accommodation
- 120 ft private garden & decked patio
- Off-street parking
- Viewing highly recommended
- COUNCIL: Brent (E)

020 8459 1133

[enquiries@cameronsstiff.co.uk](mailto:enquiries@cameronsstiff.co.uk)

[cameronsstiff.co.uk](http://cameronsstiff.co.uk)



## Chatsworth Road, London, NW2

Approximate Area = 1370 sq ft / 127.2 sq m (excludes shed)

For identification only - Not to scale

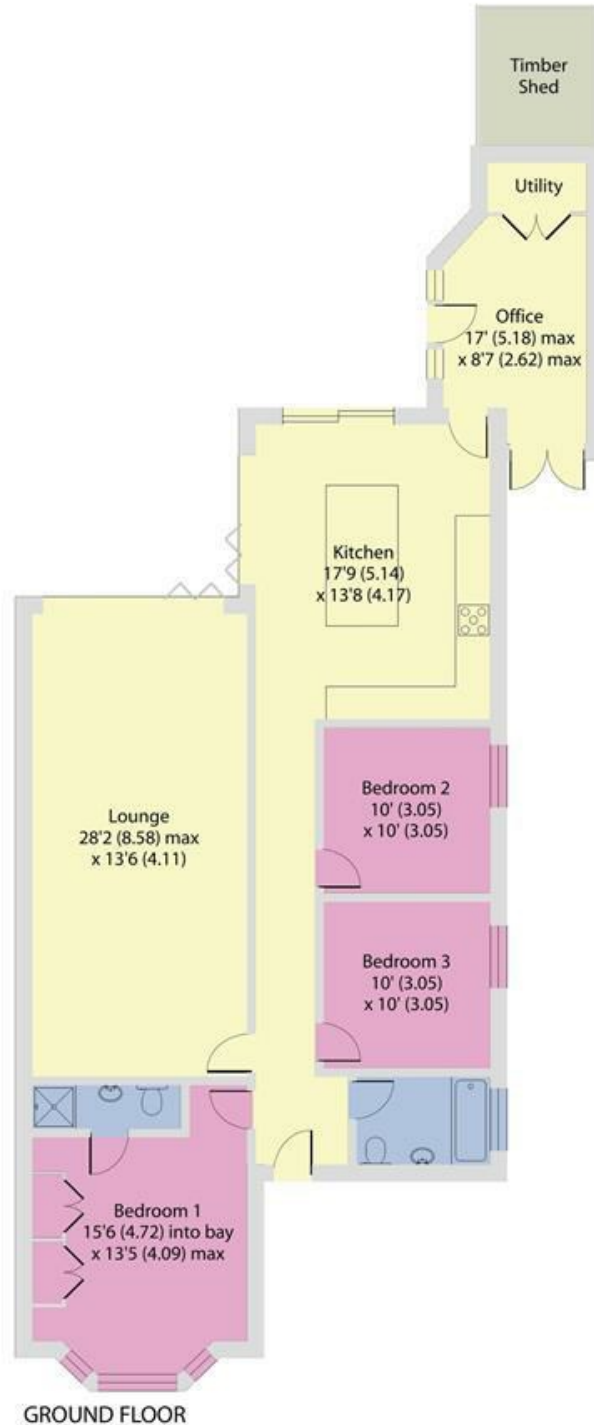

Floor plan produced in accordance with RICS Property Measurement Standards incorporating International Property Measurement Standards (IPMS2 Residential). © nichecom 2024. Produced for Camerons Stiff & Co. REF: 233153

EPC: C  
Ref: 18899674

