



Thomas More Street, E1W

£690,000

 2  1  2  C

- Two Bedroom Apartment
- Two Bathrooms
- West Wapping Location
- Moments from St Katharine's Docks
- Balcony
- Chain Free



Ea2 are pleased to offer for sale this well presented two bedroom apartment within this secure building with Porter and Parking in West Wapping. The spacious apartment comprises of a large and bright Reception with access to the balcony that stretches along to the primary bedroom, a separated and fully fitted Kitchen, 2 spacious double Bedrooms and 2 Bathrooms.

Hermitage Waterside further benefits from secure underground Parking, Bike storage, lift access and Porter. Ideally located in West Wapping, only moments away from St Katharine's Docks with a wide selection of pubs, bars, restaurants and cafes nearby. Close to Tower Bridge and Aldgate stations and walking distance to The City. Close to local bus routes providing an easy access to Canary Wharf, London Bridge or Shoreditch. Offered chain free.



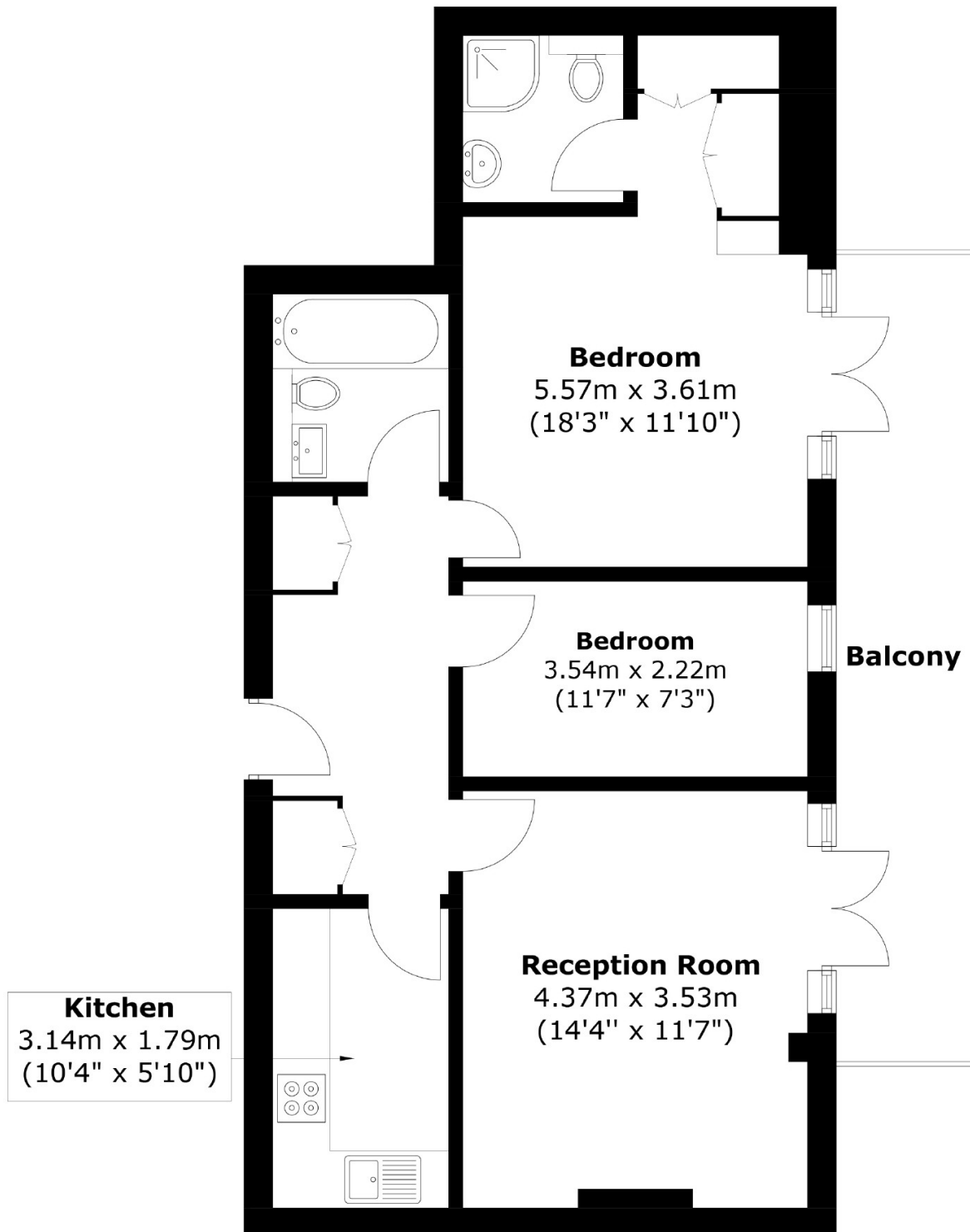

Total area: Approx. 63.9 sq. meters (687.8 sq. feet)
Plus Balcony, approx. 12.0 sq. meters (129.2 sq. feet)

35A Wapping High Street,
London, E1W 1NR
020 7665 5589
ea2group.com