



The Broadway, Farnham Common, SL2 3PP
£243,000





The Broadway, Farnham Common, SL2 3PP

£243,000

- One Bedroom
- Sought After High Street Location
- Fitted Wardrobes
- Close To Local Amenities
- Good Condition Throughout
- Fitted Kitchen With Integrated Appliances
- Allocated Parking
- 499 sq ft

Description

This well presented flat offers an ideal opportunity for first time buyers or those seeking to establish themselves in a welcoming community.

Upon entering, you will find a spacious double bedroom complete with fitted wardrobes, ensuring ample storage, a modern bathroom is designed with contemporary fixtures, the heart of the home is the bright and airy reception/dining room, which seamlessly integrates with a sleek fitted kitchen. This open plan layout creates an inviting atmosphere ready for its new owners.

Situation

Located in the heart of Farnham Common village, this elegant flat offers a wonderful blend of convenience, community spirit, and access to nature. The area is served by a number of highly regarded schools including Farnham Common Infant & Junior Schools, Burnham Grammar School and The Beaconsfield School. Within 3/4 miles, you have access to Burnham, Slough, and Gerrards Cross train stations, with Elizabeth Line services to central London. Also quick access to major road links M40, M4 and M25. Shopping facilities include Slough town centre and High Wycombe with the Eden shopping centre boasting a variety of local shops, restaurants, cafes and coffee shops.



Floor Plans

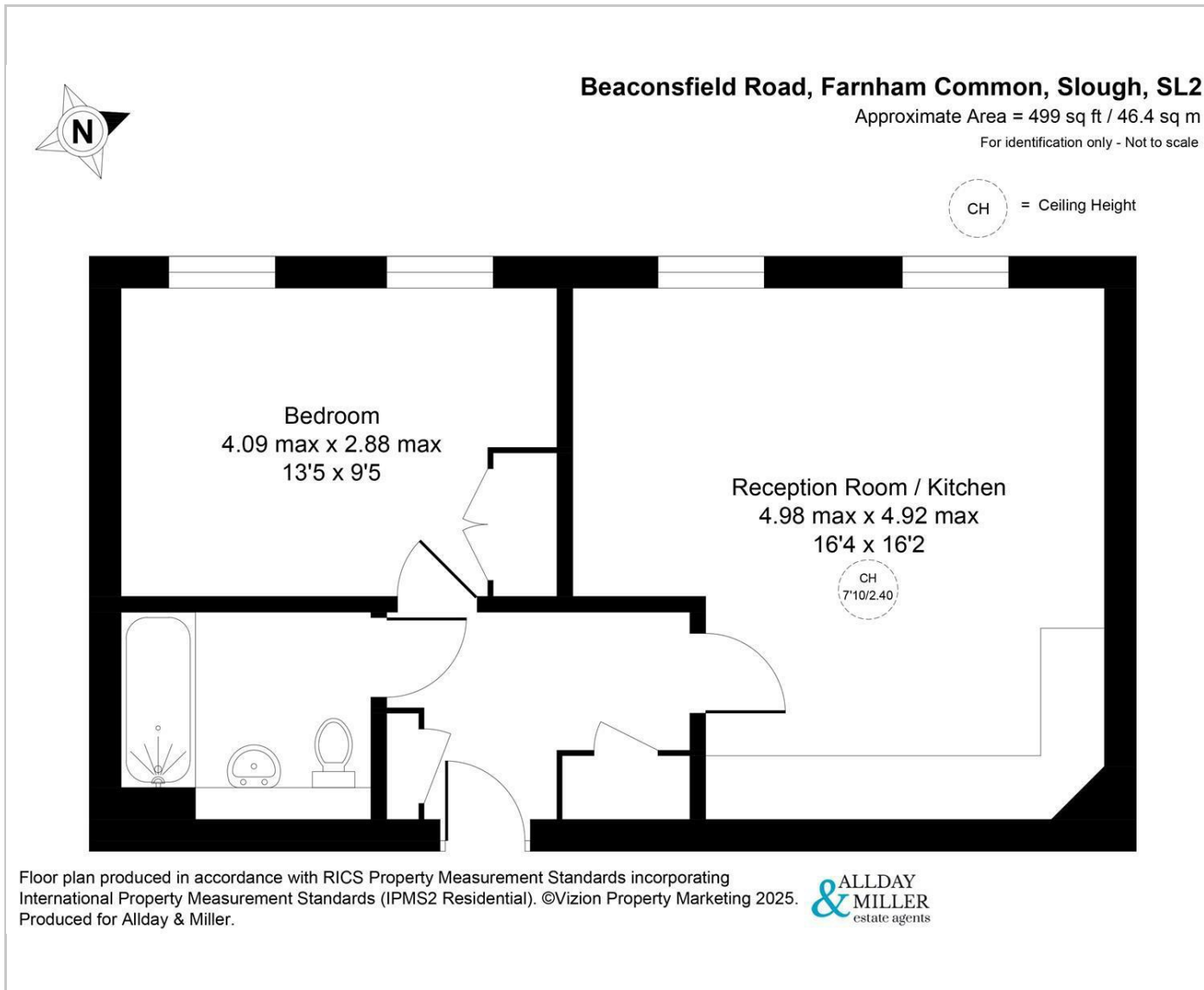

Area Map

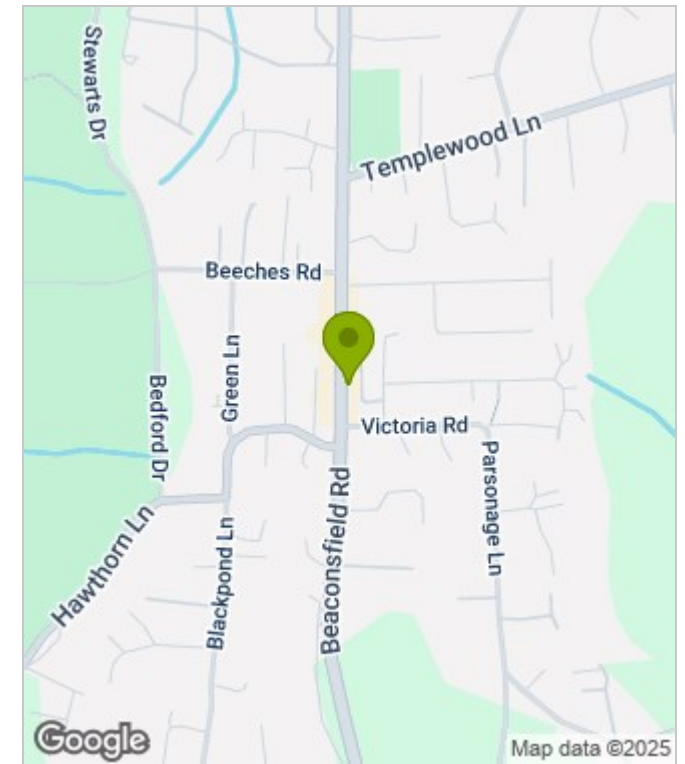

Energy Performance Graph

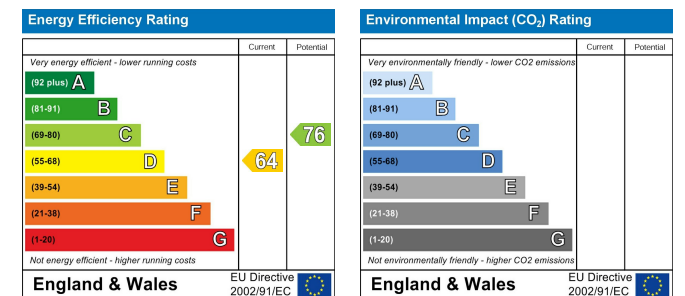

These particulars, whilst believed to be accurate are set out as a general outline only for guidance and do not constitute any part of an offer or contract. Intending purchasers should not rely on them as statements of representation of fact, but must satisfy themselves by inspection or otherwise as to their accuracy. No person in this firm's employment has the authority to make or give any representation or warranty in respect of the property.