

ALLDAY
& MILLER

281 Field End Road, Ruislip, HA4 9DQ
£500,000

 2  2  1  c



281 Field End Road, Ruislip, HA4 9DQ

£500,000

- Two Bedrooms
- Secure Residents Parking
- Penthouse Apartment With Lift
- Close To Local Amenities
- Large Private Balcony With Stunning Views
- Two Bathrooms
- Open Plan Lounge / Kitchen
- 777 Sq Ft
- Short distance to Eastcote Station
- Long lease (245 Years). Ground Rent/Service Charge £2400 pa.

Description

This stunning penthouse apartment boasts two generously sized double bedrooms, each offering the luxury of its own private en suite bathroom.

The heart of the home is a bright and airy reception/dining room, filled with ample natural light. This living area seamlessly integrates with a sleek, fully fitted kitchen, complete with modern appliances, high-gloss cabinetry, ample workspace and a sky light window.

A delightful balcony area which creates the perfect space for outdoor dining.

Situation

Field End Road is conveniently situated within walking distance of Eastcote with its selection of shops, cafes and restaurants such as Costa Coffee, Tesco Express and Sainsbury's. The Metropolitan and Piccadilly Line is available at Eastcote Station making the journey into central London a breeze. The A40 is also only a short drive away which is ideal for commuters seeking connections to London or the Home Counties. There are also several green spaces in the local area to include Cavendish Recreation ground. Victoria Road retail park is also close by and offers a variety of supermarkets and shops. The property is also located close to highly rated local schools which include Newton Farm Nursery, Infant and Junior school, St Swithun Wells Catholic Primary School and Field End Infant and Junior School.



Floor Plans

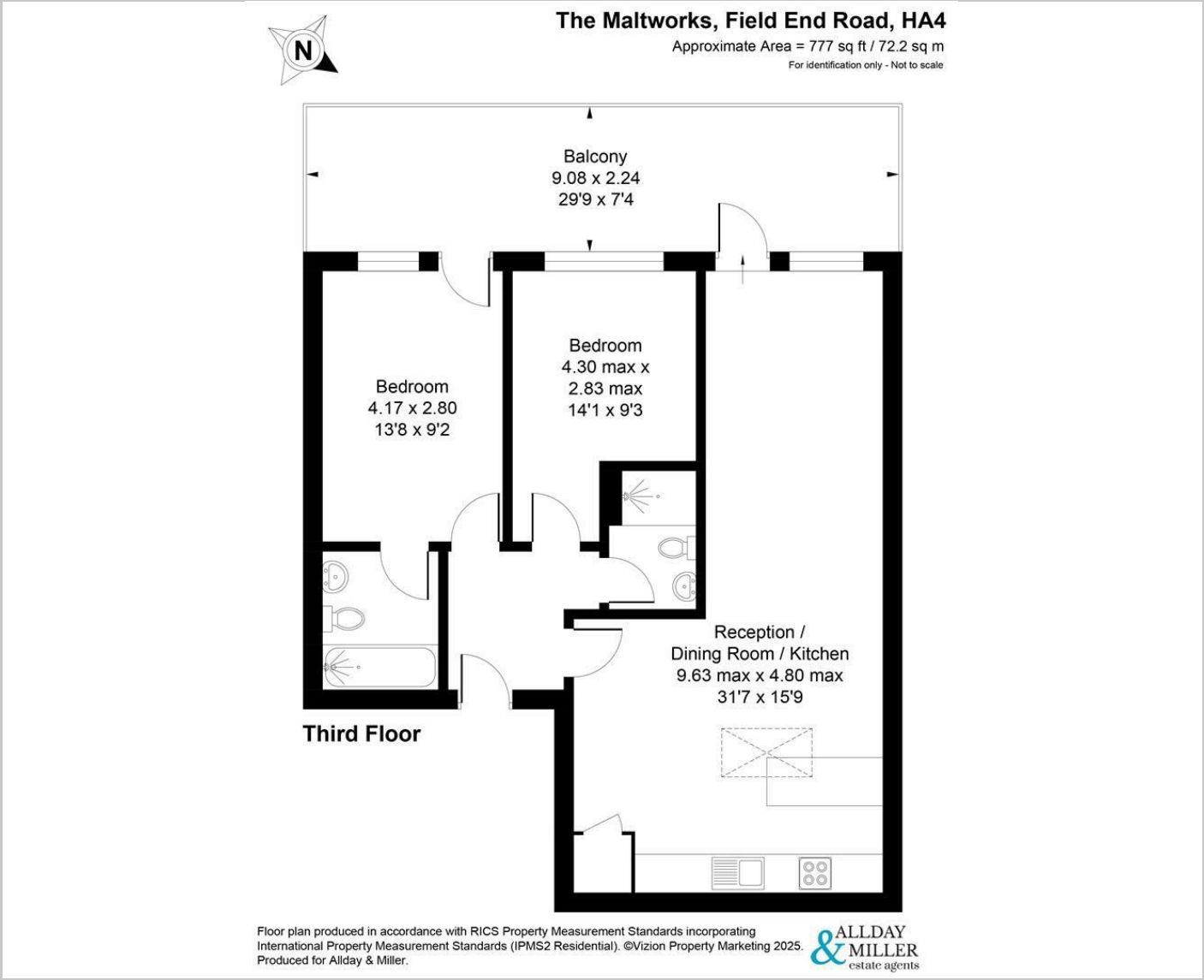

Area Map

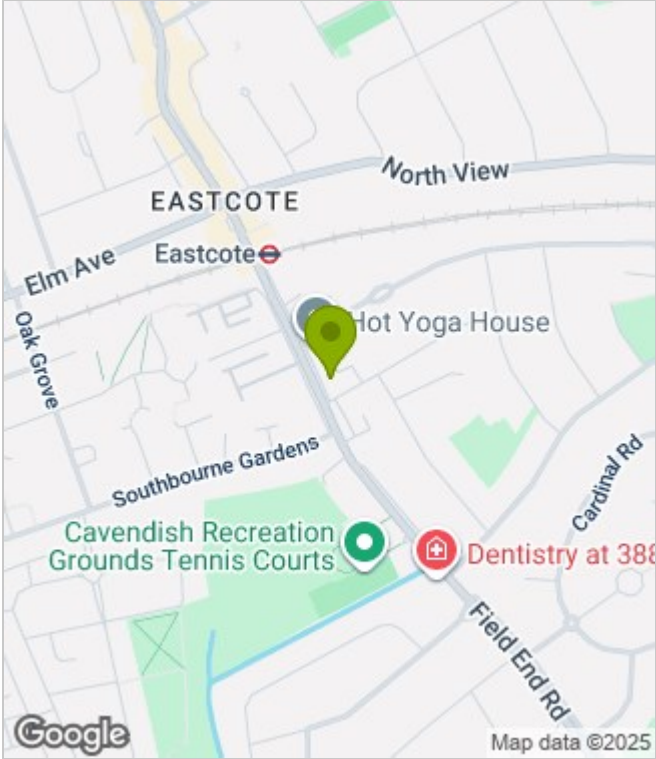

Energy Performance Graph

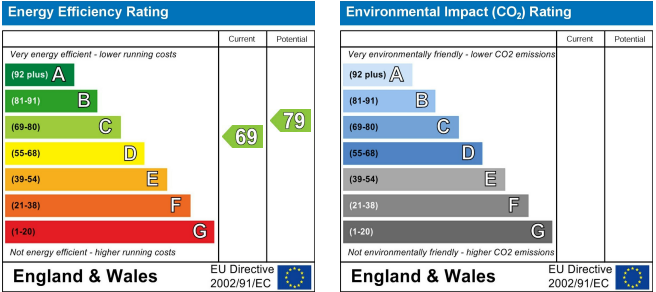

These particulars, whilst believed to be accurate are set out as a general outline only for guidance and do not constitute any part of an offer or contract. Intending purchasers should not rely on them as statements of representation of fact, but must satisfy themselves by inspection or otherwise as to their accuracy. No person in this firms employment has the authority to make or give any representation or warranty in respect of the property.