

# 4 THE MANOR HOUSE

## Hillfield



MARCHAND PETIT

COASTAL, TOWN & COUNTRY







## 4 THE MANOR HOUSE

---

A beautifully presented and elegant first-floor apartment, offering spacious open-plan living, three double bedrooms, beautiful countryside views, and allocated parking.

This wonderful home would make a perfect lock up and leave bolthole, chic main home or an ideal investment to let out.

Accessed via a charming communal courtyard garden, this apartment forms part of a stunning converted country house and enjoys far-reaching views across the surrounding countryside. Refurbished to a high specification throughout, the property blends period charm with a modern contemporary style.

The accommodation comprises of a bright and airy open-plan living space, with a well-appointed kitchen featuring high-quality integral appliances and Unistone quartz worktops, seamlessly flowing through to the living and dining areas from where the beautiful views are enjoyed.

There are three generous double bedrooms, including a principal bedroom with an en suite shower room, alongside a sleek and stylish family bathroom.

Outside there are communal grounds available to enjoy and the property benefits from an allocated parking space. In the basement there is a most useful secure storage facility.

With its idyllic setting, elegant interiors, and contemporary finish, this apartment offers a perfect balance of comfort, style, and convenience.

Hillfield Village occupies a tranquil rural setting promoting a relaxed yet active outdoors lifestyle, situated just a couple of miles outside of Dartmouth. Dartmouth is a beautiful waterside town, particularly well known as a sailing centre with excellent facilities for yachtsmen and its famous annual Royal Regatta. The town provides a good range of shops, restaurants and galleries and is surrounded by stunning countryside and a short drive from some of the most beautiful beaches in the South West. There are several excellent golf courses within easy reach and railway links to London Paddington can be made locally at Totnes, about 13 miles to the north. Access to the A38 Devon Expressway at Buckfastleigh is about 19 miles away.







## KEY FEATURES

---

- Spacious Elegant first floor apartment
- Stylish Open plan living
- 3 double bedrooms, 1 en suite
- Separate family bathroom
- Beautiful views of the surrounding countryside
- Allocated parking
- Full residential status
- Lovey communal grounds









# PROPERTY DETAILS

---

**Property Address**

4 The Manor House, Hillfield Village, Dartmouth, Devon, TQ6 0FA

**Mileages**

Dartmouth town Totnes 13 miles, Kingsbridge 15 miles, A38 Devon Expressway 19 miles. All mileages are approximate.

**Services**

Mains electricity and water. Private drainage .Electric heating

**EPC Rating**

Current: C Potential: B

**Council Tax Band**

D

**Tenure**

999 year lease from November 2015. Share of Freehold  
£1593 p.a. service charge

**Authority**

South Hams District Council

**Fixtures & Fittings**

All items in the written text of these particulars are included in the sale. All others are expressly excluded regardless of inclusion in any photographs. Purchasers must satisfy themselves that any equipment included in the sale of the property is in satisfactory order.

**Directions**

Proceed out of Dartmouth on the A3122 driving through Norton. Take the second left into Bugford Lane and after about ½ mile, the entrance to Hillfield Village will be found on the left

**Viewing**

Strictly by appointment with the sole agents, Marchand Petit, Dartmouth.  
Tel: 01803 839190.



IMPORTANT NOTICE 1. These particulars are for guidance only. They are prepared and issued in good faith and are intended to give a fair description of the property, but do not constitute part of an offer or contract. 2. Any description or information given should not be relied on as a statement or representation of fact that the property or its services are in good condition. Neither Marchand Petit, nor any of its employees, has any authority to make or give any representation or warranty whatsoever in relation to the property. 3. The photographs show only certain parts and aspects of the property at the time they were taken. Any areas, measurements or distances given are approximate only. 4. Any reference to alterations to, or use of, any part of the property is not a statement that any regulations or other consent has been obtained. These matters must be verified by any intending purchaser. 5. Descriptions of a property are inevitably subjective, and the descriptions contained herein are used in good faith as an opinion and not by way of statement of fact. If any points of particular importance need clarifying before viewing, please do not hesitate to contact our office. MONEY LAUNDERING REGULATIONS - Prior to a sale being agreed, prospective purchasers will be required to produce identification documents. Your co-operation with this, in order to comply with Money Laundering regulations, will be appreciated and assist with the smooth progression of the sale.



# FLOOR PLAN

---

## 4 The Manor House, Hillfield

### First Floor

Approx. 80.4 sq. metres (865.5 sq. feet)

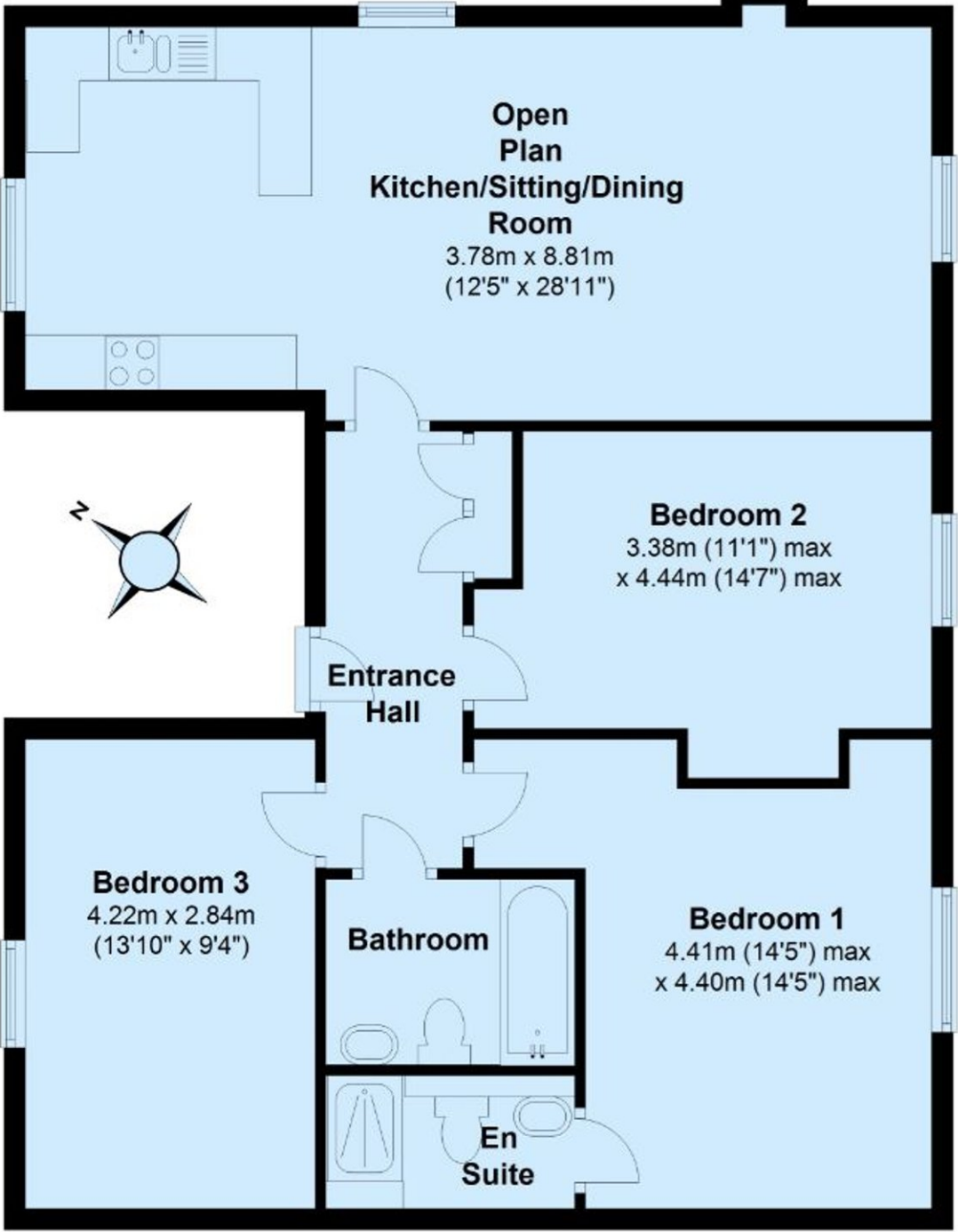

Total area: approx. 80.4 sq. metres (865.5 sq. feet)





MARCHAND PETIT

COASTAL, TOWN & COUNTRY

Dartmouth Office

01803 839190 | [dartmouth@marchandpetit.co.uk](mailto:dartmouth@marchandpetit.co.uk)  
1-3 Hauley Road, Dartmouth, Devon, TQ6 9AA

[MARCHANDPETIT.CO.UK](http://MARCHANDPETIT.CO.UK)

Dartmouth  
01803 839190

Kingsbridge  
01548 857588

Modbury  
01548 831163

Newton Ferrers  
01752 873311

Salcombe  
01548 844473

Totnes  
01803 847979

Lettings  
01548 855599

Prime Waterfront & Country House  
01548 855590