



Hever Close, Pitstone Leighton Buzzard LU7 9FH



The current owners have tastefully decorated and presented this charming family home to a very high standard throughout. The inviting entrance hall leads onto the guest cloakroom, living room, study and kitchen.

The stunning living room is bright with natural light flooding the room through the front windows with glazed French doors opening onto the snug/ playroom. The modern kitchen is fitted with a range of base and wall mounted units with integrated appliances and quartz worktop, of particular note is the impressive open plan family/ dining room with views of the gorgeous rear garden; the study completes the downstairs accommodation.

On the first floor you will find three large double bedrooms, each with built in wardrobes and a family bathroom. The principal bedroom benefits from a stylish modern, en-suite and twin double wardrobes. The second floor offers two further impressive double bedrooms with vaulted ceilings, and a bathroom.

Outside

Outside, there is a lovely enclosed rear garden partly laid to lawn with beautiful stocked herbaceous borders and a central paved patio providing an excellent area for entertaining friends and family, there is also a brick-built BBQ with seating area and an outside butlers sink, with french doors accessing the double garage. The summer house/ games room offers a great accommodation and benefits from a wet room; this area can also be utilised as a gym or an office. The front garden is partially laid to lawn and block paving, providing ample parking with driveway leading to a detached double garage with power & light.

Location

Castlemead is a popular development in the Buckinghamshire village of Pitstone approximately one mile from Tring Train station serving London Euston, popular with families and commuters alike. The village has a village hall and green in the centre and a choice of restaurants and a large general store providing one's day to day needs. Pitstone falls in the catchment for the well reputed Grammar Schools in Aylesbury.





welcome to Hever Close, Pitstone Leighton Buzzard

- Detached
- Five Bedrooms
- Summer House/Games Room
- Two Bathrooms & En-Suite to Principal Room
- Gardens

Tenure: Freehold EPC Rating: D
Council Tax Band: G

guide price
£800,000

An impressive five double bedroom detached family home situated in a tucked away location on Hever Close.

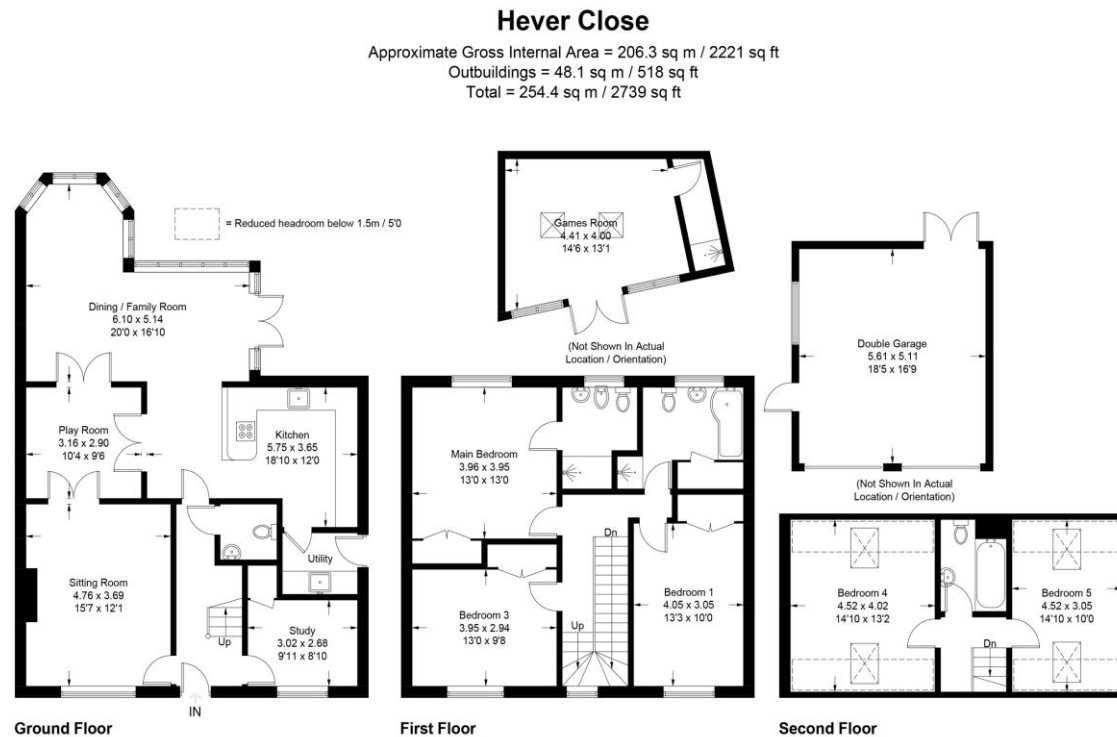

check out more properties at brownandmerry.co.uk
see all our properties on zoopla.co.uk | rightmove.co.uk | sequencehome.co.uk



Property Reference:
TRG109004 - 0003

1. MONEY LAUNDERING REGULATIONS Intending purchasers will be asked to produce identification documentation at a later stage and we would ask for your co-operation in order that there is no delay in agreeing the sale. 2. These particulars do not constitute part or all of an offer or contract. 3. The measurements indicated are supplied for guidance only and as such must be considered incorrect. Potential buyers are advised to recheck measurements before committing to any expense. 4. We have not tested any apparatus, equipment, fixtures or services and it is in the buyers interest to check the working condition of any appliances. 5. Where an EPC, or a Home Report (Scotland only) is held for this property, it is available for inspection at the branch by appointment. If you require a printed version of a Home Report, you will need to pay a reasonable production charge reflecting printing and other costs. 6. We are not able to offer an opinion either written or verbal on the content of these reports and this must be obtained from your legal representative. 7. Whilst we take care in preparing these reports, a buyer should ensure that his/her legal representative confirms as soon as possible all matters relating to title including the extent and boundaries of the property and other important matters before exchange of contracts.



01442 824133



Tring@brownandmerry.co.uk



41 High Street, TRING,
Hertfordshire, HP23 5AA



brownandmerry.co.uk