



Atkins Close, Cambridge
Offers in Excess of **£370,000** **Freehold**

**Sharman
Quinney**

Key Features



- End of terrace family home
- Versatile living and layout
- Ample storage throughout
- Ability to extend, side and rear
- Brand new combi boiler
- Driveway parking
- Enclosed rear garden

When you enter the property, you are welcomed by a well-sized front porch, perfect for coats, shoes, household belongings and additional storage.

To the front of the property, you will find a spacious living / dining room offering ample space for furniture. The current living room is currently being used as a double bedroom but provides excellent potential to be reinstated as a comfortable living area.

The kitchen features a practical tiled floor and offers a generous Range of wall and base units, providing ample storage space. There is plenty of



worktop surface space for food preparation, along with single oven, gas hob and built-in appliances, for added convenience. The boiler, located in the kitchen, has recently been replaced with a brand-new unit.

Beyond the kitchen, is a useful utility room with access to the garden, providing additional storage and space for laundry.

Upstairs, the property offers two spacious double bedrooms, both providing ample room for furniture. The accommodation is completed by an updated, fully tiled shower room with a heated towel rail, finished to a modern standard.

This property also benefits from approved plans for a side and rear extension, offering fantastic potential to further enhance and expand living space. Please contact the branch for further details.



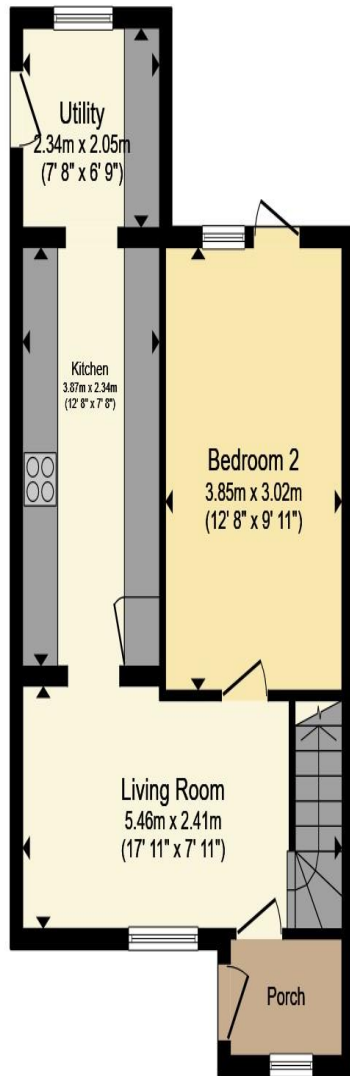

Ground Floor

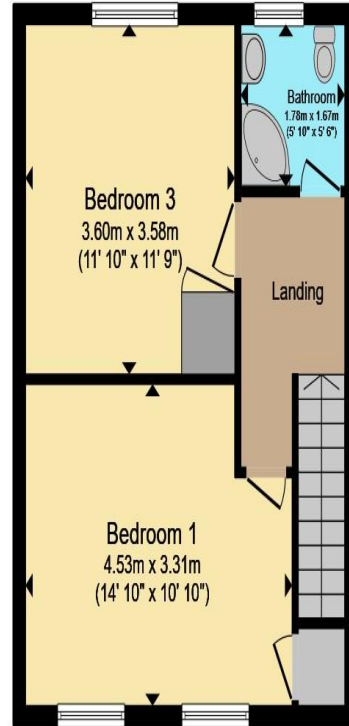

First Floor

- Kitchen - 3.87m x 2.34m / 12'8 x 7'8
- Living room - 5.46m x 2.41 / 17'11 x 7'11
- Utility room - 2.34 x 2.05m / 7'8 x 6'9
- Bedroom one - 4.53m x 3.31m / 14'10 x 10'10
- Bedroom two - 3.85m x 3.02m / 12;8 x 9'11
- Bedroom Three - 3.60m x 3.58m / 11'10 x 11'9

Total floor area 84.3 m² (908 sq.ft.) approx

This floor plan is for illustrative purposes only. It is not drawn to scale. Any measurements, floor areas (including any total floor area), openings and orientation are approximate. No details are guaranteed, they cannot be relied upon for any purpose and they do not form part of any agreement. No liability is taken for any error, omission or misstatement. A party must rely upon its own inspection(s). Powered by www.propertybox.io

**Sharman
Quinney**

To view this property call Sharman Quinney on:
01223 426139

Selling your property?

Contact us to arrange a **FREE** home valuation.

 01223 426139

 Unit 5 Orchard House Unwin Square, Orchard Park, CAMBRIDGE, Cambridgeshire, CB4 2AD

 orchardpark@sharmanquinney.co.uk

 www.sharmanquinney.co.uk



 SCAN ME



Sharman Quinney Holdings Limited is registered in England and Wales under company number 4174227, Registered Office is Cumbria House, 16-20 Hockliffe Street, Leighton Buzzard, Bedfordshire, LU7 1GN. VAT Registration Number is 500 2481 05.

1: These particulars do not constitute part or all of an offer or contract. 2: The measurements indicated are supplied for guidance only and as such must be considered incorrect. 3: Potential buyers are advised to recheck the measurements before committing to any expense. 4: Sharman Quinney has not tested any apparatus, equipment, fixtures, fittings or services and it is the buyers interests to check the working condition of any appliances. 5: Sharman Quinney has not sought to verify the legal title of the property and buyers must obtain verification from their legal representative. 6: Intending purchasers will be asked to produce identification documentation at a later stage and we would ask your co-operation in order that there will be no delay in agreeing the sale. Ref: ORP102242 - 0003

