



**High Trees Close, Redditch B98 7XJ**

welcome to

## High Trees Close, Redditch

\*\*\* WELL-PRESENTED TERRACE PROPERTY \*\*\* THREE BEDROOMS \*\*\* KITCHEN/DINER \*\*\* DRIVEWAY \*\*\* CONSERVATORY \*\*\* LIVING ROOM \*\*\*  
FAMILY BATHROOM \*\*\* SECURE REAR GARDEN \*\*\* GREAT LOCATION \*\*\*



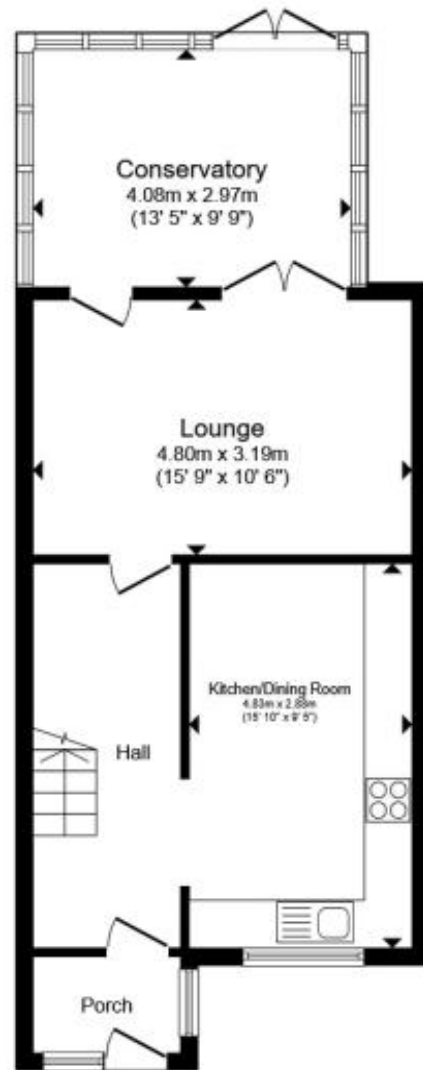

**Ground Floor**

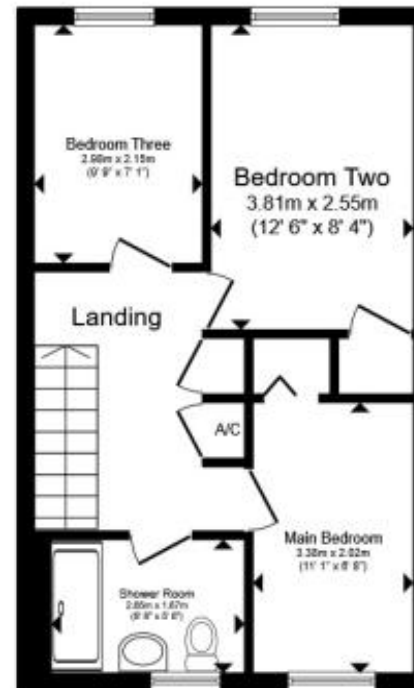

**First Floor**

Total floor area 92.2 m<sup>2</sup> (992 sq.ft.) approx

This floor plan is for illustrative purposes only. It is not drawn to scale. Any measurements, floor areas (including any total floor area), openings and orientation are approximate. No details are guaranteed, they cannot be relied upon for any purpose and they do not form part of any agreement. No liability is taken for any error, omission or misstatement. A party must rely upon its own inspection(s). Powered by [www.propertybox.io](http://www.propertybox.io)

**Driveway**  
**Entrance Hall**

With central heating radiator

**Living Room**

With double glazed french doors to the rear and a central heating radiator

**Kitchen/Diner**

With a range of wall and base units, a sink/drain, gas hob/oven, plumbing for a washing machine, double glazed windows to the front and a central heating radiator

**Conservatory**

With double glazed windows to the side and rear aspects and a door leading out to the rear garden

**Landing**

**Bedroom One**

With double glazed windows to the rear and a central heating radiator

**Bedroom Two**

With double glazed windows to the front and a central heating radiator

**Bedroom Three**

With double glazed windows to the rear and a central heating radiator

**Bathroom**

With a w/c, hand wash basin, a bath with shower over, double glazed windows to the front and a central heating radiator

**Rear Garden**

With patio and decking areas

**Agents Note**

The Council Tax Band is a B



***view this property online*** [shipways.co.uk/Property/RDC110495](http://shipways.co.uk/Property/RDC110495)



welcome to

## High Trees Close, Redditch

- Well-presented terrace property
- Three bedrooms
- Kitchen/diner
- Driveway
- Conservatory

Tenure: Freehold EPC Rating: C

Council Tax Band: B

# £240,000



Please note the marker reflects the postcode not the actual property

**view this property online** [shipways.co.uk/Property/RDC110495](https://shipways.co.uk/Property/RDC110495)



Property Ref:  
RDC110495 - 0003

1. MONEY LAUNDERING REGULATIONS Intending purchasers will be asked to produce identification documentation at a later stage and we would ask for your co-operation in order that there is no delay in agreeing the sale. 2. These particulars do not constitute part or all of an offer or contract. 3. The measurements indicated are supplied for guidance only and as such must be considered incorrect. Potential buyers are advised to recheck measurements before committing to any expense. 4. We have not tested any apparatus, equipment, fixtures or services and it is in the buyers interest to check the working condition of any appliances. 5. Where an EPC, or a Home Report (Scotland only) is held for this property, it is available for inspection at the branch by appointment. If you require a printed version of a Home Report, you will need to pay a reasonable production charge reflecting printing and other costs. 6. We are not able to offer an opinion either written or verbal on the content of these reports and this must be obtained from your legal representative. 7. Whilst we take care in preparing these reports, a buyer should ensure that his/her legal representative confirms as soon as possible all matters relating to title including the extent and boundaries of the property and other important matters before exchange of contracts.

Shipways is a trading name of Sequence (UK) Limited which is registered in England and Wales under company number 4268443, Registered Office is Cumbria House, 16-20 Hockliffe Street, Leighton Buzzard, Bedfordshire, LU7 1GN. VAT Registration Number is 500 2481 05.

  
shipways



**01527 65155**



[Redditch@shipways.co.uk](mailto:Redditch@shipways.co.uk)



3 Alcester Street, REDDITCH, Worcestershire,  
B98 8AE



[shipways.co.uk](https://shipways.co.uk)