



Flat 63 Trinity Place, Park Street, Maidenhead SL6 1TJ

welcome to

Flat 63 Trinity Place, Park Street, Maidenhead

Situated in the heart of Maidenhead town centre, this stylish new-build one-bedroom apartment at Trinity Place offers contemporary living with exceptional convenience.



Trinity Place, Park Street, Maidenhead, SL6

Approximate Area = 541 sq ft / 50.2 sq m

For identification only - Not to scale

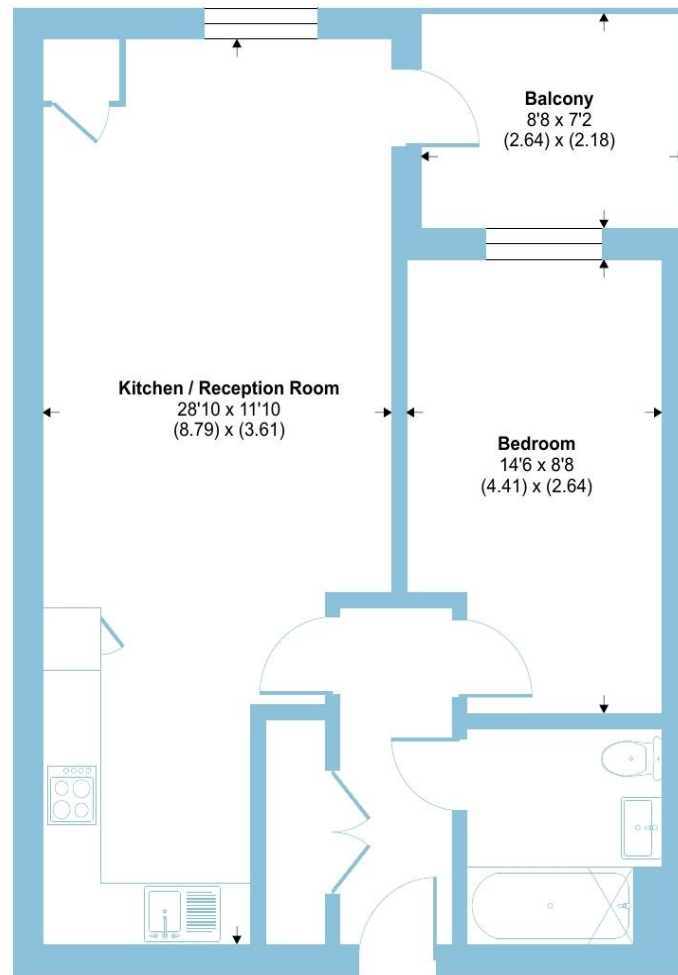

THIRD FLOOR

Finished to a high specification throughout, the property features a bright and well-proportioned open-plan living area, seamlessly connecting to a modern fitted kitchen complete with integrated appliances and sleek cabinetry.

The spacious double bedroom provides a comfortable retreat, complemented by a beautifully designed bathroom with modern fixtures and quality finishes.

A feature of the apartment is the private balcony, ideal for enjoying outdoor space, morning coffee, or evening relaxation overlooking the vibrant surroundings.

Residents benefit from secure entry and well-maintained communal areas, ensuring both comfort and peace of mind.

Trinity Place is perfectly positioned just moments from the town centre, offering a wide range of shops, restaurants, and leisure facilities, as well as excellent transport links, including Maidenhead railway station with fast connections to London via the Elizabeth Line.

This property is ideal for first-time buyers, professionals, or investors seeking a high-quality, low-maintenance home in a sought-after central location.

welcome to

Flat 63 Trinity Place, Park Street

- STYLISH ONE DOUBLE BEDROOM APARTMENT
- FINISHED TO A HIGH SPECIFICATION
- MODERN FITTED KITCHEN
- PRIVATE BALCONY
- SECURE ENTRY
- WELL MAINTAINED COMMUNAL AREAS
- WITHIN EASY REACH OF MAIDENHEAD TRAIN STATION AND THE ELIZABETH LINE
- IDEAL FIRST PURCHASE AND/OR INVESTMENT

Tenure: Leasehold EPC Rating: B

Council Tax Band: B Service Charge: 1942.08

Ground Rent: None

This is a Leasehold property with details as follows; Term of Lease 250 years from 15 Mar 2019. Should you require further information please contact the branch. Please Note additional fees could be incurred for items such as Leasehold packs.

£275,000



Please note the marker reflects the postcode not the actual property

check out more properties at rogerplatt.co.uk



Property Ref:
MHD123889 - 0001

1. MONEY LAUNDERING REGULATIONS Intending purchasers will be asked to produce identification documentation at a later stage and we would ask for your co-operation in order that there is no delay in agreeing the sale. 2. These particulars do not constitute part or all of an offer or contract. 3. The measurements indicated are supplied for guidance only and as such must be considered incorrect. Potential buyers are advised to recheck measurements before committing to any expense. 4. We have not tested any apparatus, equipment, fixtures or services and it is in the buyers interest to check the working condition of any appliances. 5. Where an EPC, or a Home Report (Scotland only) is held for this property, it is available for inspection at the branch by appointment. If you require a printed version of a Home Report, you will need to pay a reasonable production charge reflecting printing and other costs. 6. We are not able to offer an opinion either written or verbal on the content of these reports and this must be obtained from your legal representative. 7. Whilst we take care in preparing these reports, a buyer should ensure that his/her legal representative confirms as soon as possible all matters relating to title including the extent and boundaries of the property and other important matters before exchange of contracts.

Roger Platt is a trading name of Sequence (UK) Limited which is registered in England and Wales under company number 4268443, Registered Office is Cumbria House, 16-20 Hockliffe Street, Leighton Buzzard, Bedfordshire, LU7 1GN. VAT Registration Number is 500 2481 05.

roger platt



01628 773333



Maidenhead@rogerplatt.co.uk



25-29 Queen Street, MAIDENHEAD, Berkshire,
SL6 1NB



rogerplatt.co.uk