



Cranston Court, Bloemfontein Road, London, W12 7FF

Welcome to

**Cranston Court, Bloemfontein Road,
London**

Flooded with natural light, this well maintained fifth-floor, one bedroom apartment in Cranston Court features an open-plan kitchen and reception area that flows onto a private balcony. With floor-to-ceiling windows, a resident lift, and a secure video entry system, this home offers both comfort and peace of mind.

This property is situated in the heart of Shepherd's Bush, a vibrant and well-connected area of West London. This location offers an excellent mix of residential charm and urban convenience. The area is home to the iconic Westfield, one of Europe's largest shopping destinations, as well as benefitting local amenities including independent shops, traditional markets, and a wide choice of cafes, pubs and restaurants along with the iconic Soho House White City. The nearest Underground stations are Shepherd's Bush Market, approximately 0.4 miles (Circle line and Hammersmith and City line) and Wood Lane, approximately 0.9 miles (Central line) which both offer a brilliant service to the city, there are also a range of buses that provide services to central London.



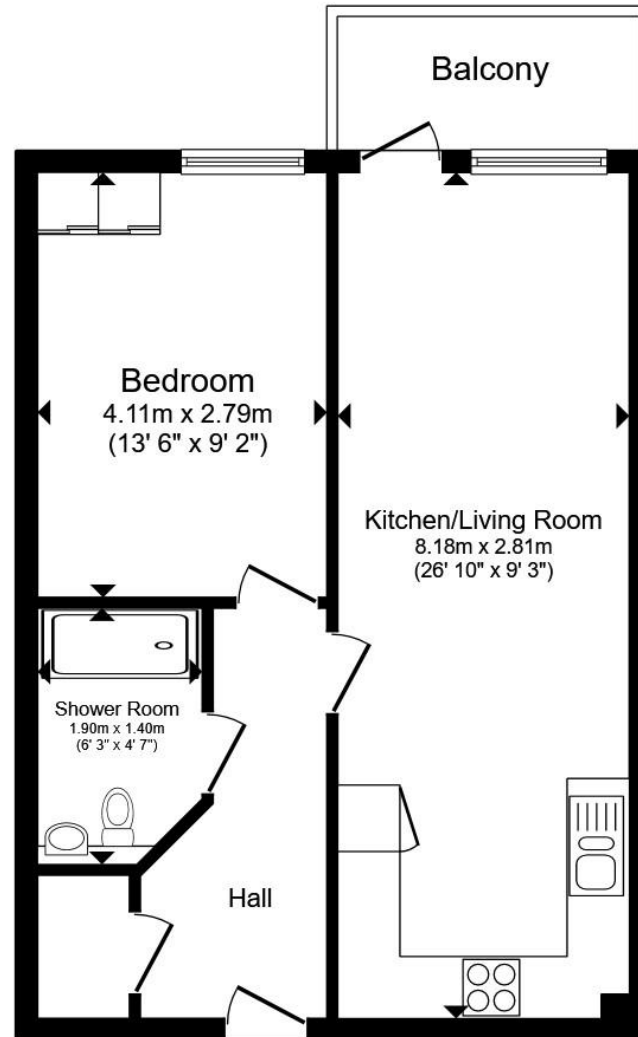

Fifth Floor

Total floor area 46.6 m² (502 sq.ft.) approx

This floor plan is for illustrative purposes only. It is not drawn to scale. Any measurements, floor areas (including any total floor area), openings and orientation are approximate. No details are guaranteed, they cannot be relied upon for any purpose and they do not form part of any agreement. No liability is taken for any error, omission or misstatement. A party must rely upon its own inspection(s). Powered by www.propertybox.io

Welcome to

Cranston Court Bloemfontein Road, London

- One Bedroom
- Open Plan Reception
- Private Balcony
- Fifth Floor
- Lift

Tenure: Leasehold EPC Rating: B

Council Tax Band: D Service Charge: 2400.00

Ground Rent: 250.00

This is a Leasehold property with details as follows; Term of Lease 125 years from 29 Sep 2013. Should you require further information please contact the branch. Please Note additional fees could be incurred for items such as Leasehold packs.

This property is situated in the heart of Shepherd's Bush, a vibrant and well-connected area of West London.

£400,000



Please note the marker reflects the postcode not the actual property

view this property online barnardmarcus.co.uk/Property/WKT107747



Property Ref:
WKT107747 - 0003

1. MONEY LAUNDERING REGULATIONS Intending purchasers will be asked to produce identification documentation at a later stage and we would ask for your co-operation in order that there is no delay in agreeing the sale. 2. These particulars do not constitute part or all of an offer or contract. 3. The measurements indicated are supplied for guidance only and as such must be considered incorrect. Potential buyers are advised to recheck measurements before committing to any expense. 4. We have not tested any apparatus, equipment, fixtures or services and it is in the buyers interest to check the working condition of any appliances. 5. Where an EPC, or a Home Report (Scotland only) is held for this property, it is available for inspection at the branch by appointment. If you require a printed version of a Home Report, you will need to pay a reasonable production charge reflecting printing and other costs. 6. We are not able to offer an opinion either written or verbal on the content of these reports and this must be obtained from your legal representative. 7. Whilst we take care in preparing these reports, a buyer should ensure that his/her legal representative confirms as soon as possible all matters relating to title including the extent and boundaries of the property and other important matters before exchange of contracts.

barnard marcus



020 7603 1384



WestKensington@barnardmarcus.co.uk



66-68 Shepherds Bush Road, West Kensington,
London, W6 7PH



barnardmarcus.co.uk