



**155 Dudley Street**

, Bedford, MK40 3SY

Offers Over £375,000



## Floor Plan

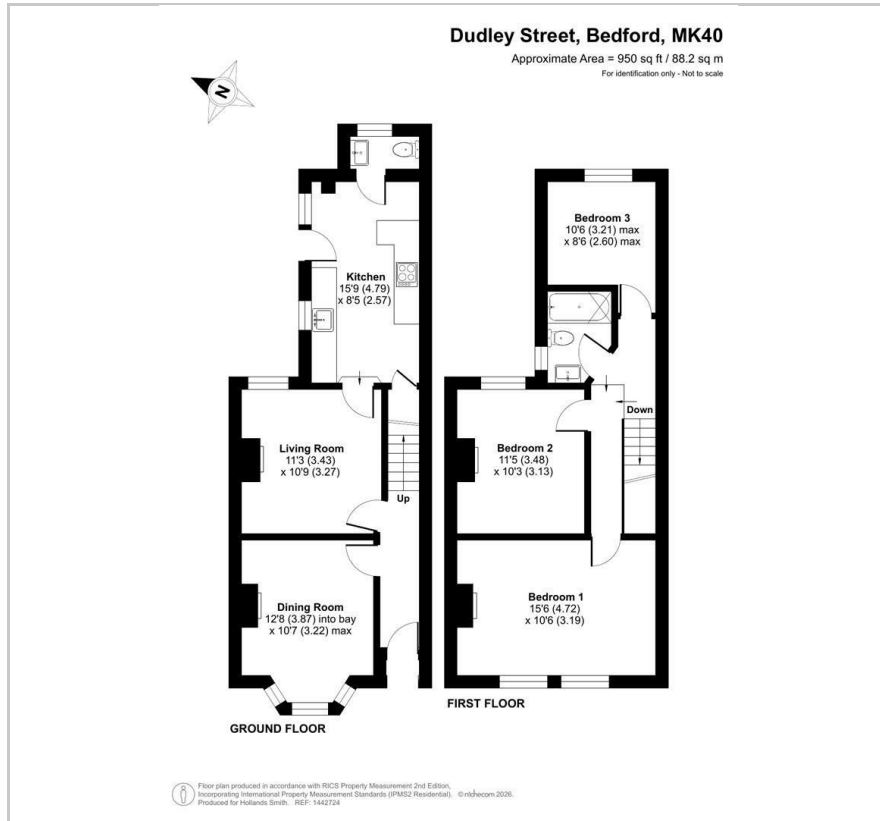

## Area Map



## Energy Efficiency Graph

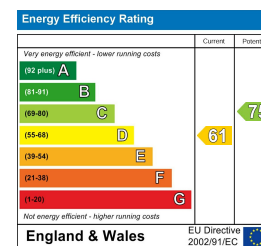

## Viewing

Please contact our Bedford Office on 01234 216612 if you wish to arrange a viewing appointment for this property or require further information.



This period bay fronted terraced home is situated on the northern edge of the 'Castle Quarter' and provides larger than typical accommodation and is well-presented throughout with plenty of period features. There are separate sitting and dining rooms and an extensively fitted kitchen breakfast room with a butler sink, built in oven and hob and wooden worktops. A handy WC to the rear completes the ground floor accommodation. Unusually, there are three double bedrooms as well as a first floor bathroom with a modern suite including a shower over the bath. Period features include fireplaces to most of the principal rooms. Stripped wood floors and doors as well as picture rails and some sash windows. Heating is by gas to radiators from a combination boiler. Outside, there is a pretty, walled garden with both lawn and patio areas.

The popular Castle Road area of the town has good choice of independently-owned cafes, coffee shops and delis as well as specialist shops such as a butchers, bakery and home improvement stores. Both Russell park and The Embankment are close by and the area is also home to the highly-regarded Castle Newnham Primary School. Bedford town centre is a short walk away and offers a wider choice of shops along with fast rail links into London St Pancras. EER: D



**163 Castle Road, MK40 3RT**

**Tel: 01234 216612**

**www.hollandsmith.co.uk**