



Aylmer Drive, Tilney St. Lawrence, King's Lynn, PE34 4RQ



welcome to

Aylmer Drive, Tilney St. Lawrence, King's Lynn

Located in the popular village of Tilney St Lawrence is this spacious two bedroom semi detached bungalow with conservatory and off road parking, which is being offered with no onward chain. Viewing highly recommended.



Double Glazed Entrance Door To

Entrance Hall

Radiator, airing cupboard housing hot water tank

Lounge

11' 2" x 15' 7" (3.40m x 4.75m)

Bay window, radiator

Kitchen

10' 10" x 5' 10" (3.30m x 1.78m)

Range of base and wall units, roll edge work top, inset stainless steel sink with mixer tap over, built-in oven, electric hob, space for fridge freezer and washing machine, radiator and small breakfast bar, two double glazed windows, ceramic tiled floor

Conservatory

10' 10" max x 13' 7" max (3.30m max x 4.14m max)

UPVc construction under polycarbonate roof, radiator, door to rear

Bedroom One

11' 2" to fitted wardrobes x 7' 11" (3.40m to fitted wardrobes x 2.41m)

Radiator, double glazed window

Bedroom Two

8' 3" x 9' 2" (2.51m x 2.79m)

Radiator, door to conservatory

Shower Room

6' 2" max x 6' 4" max (1.88m max x 1.93m max)

Shower cubicle, low level WC, wash hand basin, double glazed window, heated towel rail

Utility Area/Family Room

15' 4" max x 15' 9" max (4.67m max x 4.80m max)

Formerly the garage. Double glazed door to rear, wall mounted oil boiler, door to front and rear

Outside

Driveway to front. Laid to lawn front garden. The rear garden is laid mainly to lawn and enclosed by timber fencing.

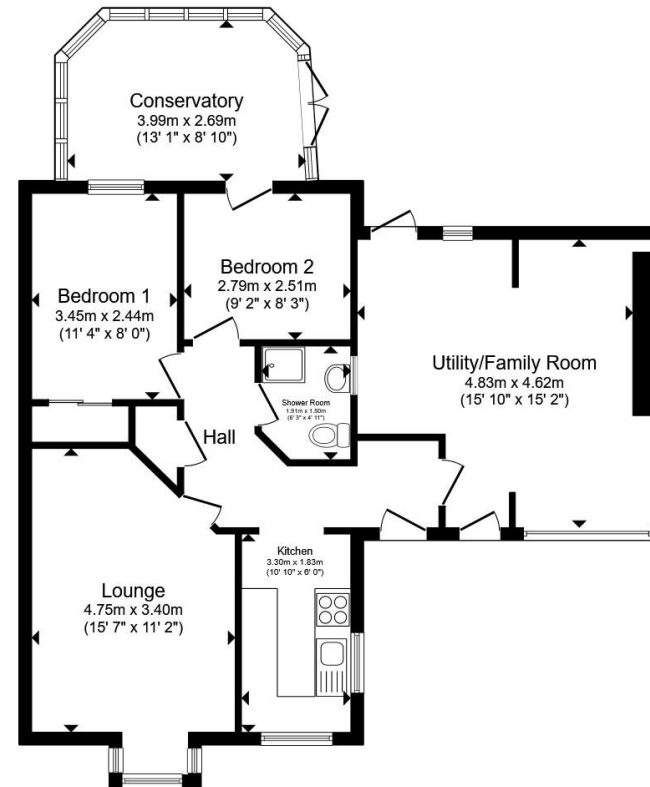

Total floor area 84.3 m² (908 sq.ft.) approx

This floor plan is for illustrative purposes only. It is not drawn to scale. Any measurements, floor areas (including any total floor area), openings and orientation are approximate. No details are guaranteed, they cannot be relied upon for any purpose and they do not form part of any agreement. No liability is taken for any error, omission or misstatement. A party must rely upon its own inspection(s). Powered by www.propertybox.io



view this property online williamhbrown.co.uk/Property/KLN119916



welcome to

Aylmer Drive, Tilney St. Lawrence, King's Lynn

- Popular Village of Tilney St Lawrence
- Semi Detached Bungalow
- Two Bedrooms
- Conservatory
- Utility/Family Room

Tenure: Freehold EPC Rating: D

Council Tax Band: B

£170,000



Please note the marker reflects the postcode not the actual property

view this property online williamhbrown.co.uk/Property/KLN119916



Property Ref:
KLN119916 - 0003

1. MONEY LAUNDERING REGULATIONS Intending purchasers will be asked to produce identification documentation at a later stage and we would ask for your co-operation in order that there is no delay in agreeing the sale. 2. These particulars do not constitute part or all of an offer or contract. 3. The measurements indicated are supplied for guidance only and as such must be considered incorrect. Potential buyers are advised to recheck measurements before committing to any expense. 4. We have not tested any apparatus, equipment, fixtures or services and it is in the buyers interest to check the working condition of any appliances. 5. Where an EPC, or a Home Report (Scotland only) is held for this property, it is available for inspection at the branch by appointment. If you require a printed version of a Home Report, you will need to pay a reasonable production charge reflecting printing and other costs. 6. We are not able to offer an opinion either written or verbal on the content of these reports and this must be obtained from your legal representative. 7. Whilst we take care in preparing these reports, a buyer should ensure that his/her legal representative confirms as soon as possible all matters relating to title including the extent and boundaries of the property and other important matters before exchange of contracts.

William H Brown is a trading name of Sequence (UK) Limited which is registered in England and Wales under company number 4268443, Registered Office is Cumbria House, 16-20 Hockliffe Street, Leighton Buzzard, Bedfordshire, LU7 1GN. VAT Registration Number is 500 2481 05.



william h brown



01553 771337



KingsLynn@williamhbrown.co.uk



40-42 King Street, KING'S LYNN, Norfolk, PE30 1ES



williamhbrown.co.uk