



Church Walk, Yaxley Peterborough  
**£240,000 Freehold**

**Sharman  
Quinney**

# Key Features



- Established Semi- Detached Home
- Three Bedrooms + Downstairs WC
- Two Reception Areas + Conservatory
- Separate Two-Piece Shower Room
- Separate One-Piece WC

Established Semi-Detached Family Home set back from the road in a Non Estate Location, briefly the accommodation comprises of Reception Hall with stairs to the first floor landing and a door to the Kitchen with a range of fitted base and eye level units, cupboards and drawers, built-in pantry, worktop space, one and a quarter single drainer sink unit, built-in five ring gas hob, eye level electric oven, space for a fridge/freezer, plumbing for a dishwasher, archway to the dining area, door to the Utility Room with worktop space, storage cupboards under, plumbing a washing machine, space for a tumble dryer, polycarbonate roof door to the front and one to the rear garden, door to the Downstairs WC, Dining Area with an archway through to the lounge, double glazed sliding doors to the Conservatory with double glazed windows, French doors to the rear garden, Upstairs First



Floor Landing with doors to the Three Bedrooms,  
Two Piece Shower Room, Separate WC with the  
wall mounted heating boiler, Outside frontage is  
open plan, laid mainly to lawn, Rear Garden is  
enclosed, non-overlooked with various plants and  
shrubs, paved patio seating area.

Reception Hall  
Kitchen - L/Shaped Room.  
Dining Area  
Lounge  
Conservatory  
Utility L/shaped Room, including WC.  
Downstairs WC  
First Floor Landing  
Bedroom 1  
Bedroom 2  
Bedroom 3  
Separate Shower Room  
Separate WC

All measurements are listed on the floor plan.



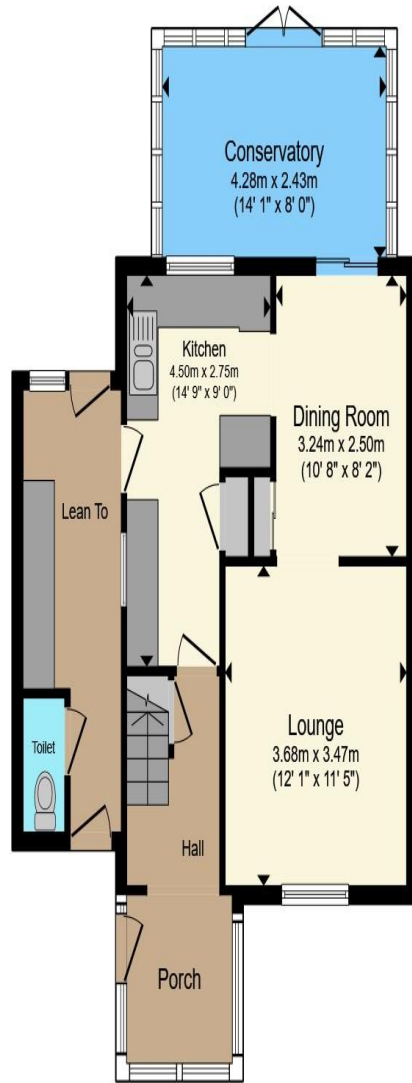

**Ground Floor**

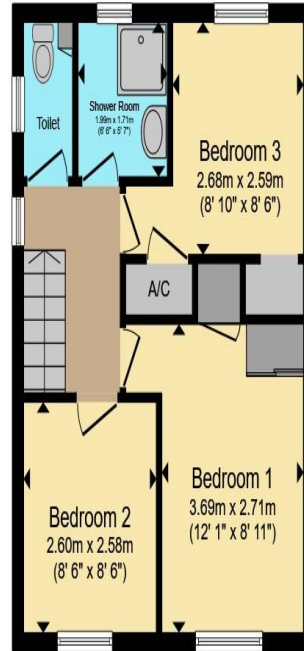

**First Floor**

Total floor area 100.6 m<sup>2</sup> (1,082 sq.ft.) approx

This floor plan is for illustrative purposes only. It is not drawn to scale. Any measurements, floor areas (including any total floor area), openings and orientation are approximate. No details are guaranteed, they cannot be relied upon for any purpose and they do not form part of any agreement. No liability is taken for any error, omission or misstatement. A party must rely upon its own inspection(s). Powered by [www.propertybox.io](http://www.propertybox.io)

**Sharman  
Quinney**

To view this property call Sharman Quinney on:  
**01733 245400**

# Selling your property?

Contact us to arrange a **FREE** home valuation.

 01733 245400

 Unit 19 Maltings Square, Broadway Shopping Centre, Yaxley, Cambridgeshire, PE7 3EW

 yaxley@sharmanquinney.co.uk

 [www.sharmanquinney.co.uk](http://www.sharmanquinney.co.uk)



 SCAN ME



Sharman Quinney Holdings Limited is registered in England and Wales under company number 4174227, Registered Office is Cumbria House, 16-20 Hockliffe Street, Leighton Buzzard, Bedfordshire, LU7 1GN. VAT Registration Number is 500 2481 05.

1: These particulars do not constitute part or all of an offer or contract. 2: The measurements indicated are supplied for guidance only and as such must be considered incorrect. 3: Potential buyers are advised to recheck the measurements before committing to any expense. 4: Sharman Quinney has not tested any apparatus, equipment, fixtures, fittings or services and it is the buyers interests to check the working condition of any appliances. 5: Sharman Quinney has not sought to verify the legal title of the property and buyers must obtain verification from their legal representative. 6: Intending purchasers will be asked to produce identification documentation at a later stage and we would ask your co-operation in order that there will be no delay in agreeing the sale. Ref: YAX203736 - 0001

