



Curtis Avenue, Glasgow G44 4NN

welcome to Curtis Avenue, Glasgow

- Lower Cottage Flat
- Bright Spacious Lounge / Dining Room
- Fitted Kitchen
- Two Good Sized Bedrooms
- Family Bathroom

Tenure: Freehold EPC Rating: D
Council Tax Band: C

offers over
£110,000

Presented to the market is this two bedroom lower cottage flat situated within the much in demand locale of Kings Park.

Offering a versatile internal layout and suited to a wide variety of purchasers, ranging from the first time buyer to those considering downsizing, or even an investor looking for a buy-to-let opportunity, this flat will undoubtedly be of wide appeal.

The spacious internal layout comprises: entrance hall, good sized lounge with open plan dining room, fitted kitchen, two double bedrooms and family bathroom with three piece suite. Good storage solutions. Externally rear gardens and driveway for off street parking.

Kings Park offers access to the M74 providing links to Glasgow City Centre and further afield and there are a number of well serviced train and bus routes within this affluent suburb. A selection of primary and secondary schooling is available and the park provides recreational grounds. The neighbouring town of Rutherglen offers an abundance of shops, bars, restaurants, a library, and much more within this established residential area.

Early Viewing Advised.

Entrance Hallway

Lounge / Dining Room

17' 8" x 14' 9" Max (5.38m x 4.50m Max)

Kitchen

6' 6" x 6' 5" (1.98m x 1.96m)

Bedroom One

16' 6" Max x 11' 1" (5.03m Max x 3.38m)

Bedroom Two

11' 1" x 9' 7" (3.38m x 2.92m)

Bathroom

7' 3" x 5' 9" (2.21m x 1.75m)

view this property online allenandharris.co.uk/Property/BSD109229



Property Ref:
BSD109229 - 0002

1. MONEY LAUNDERING REGULATIONS Intending purchasers will be asked to produce identification documentation at a later stage and we would ask for your co-operation in order that there is no delay in agreeing the sale. 2. These particulars do not constitute part or all of an offer or contract. 3. The measurements indicated are supplied for guidance only and as such must be considered incorrect. Potential buyers are advised to recheck measurements before committing to any expense. 4. We have not tested any apparatus, equipment, fixtures or services and it is in the buyers interest to check the working condition of any appliances. 5. Where an EPC, or a Home Report (Scotland only) is held for this property, it is available for inspection at the branch by appointment. If you require a printed version of a Home Report, you will need to pay a reasonable production charge reflecting printing and other costs. 6. We are not able to offer an opinion either written or verbal on the content of these reports and this must be obtained from your legal representative. 7. Whilst we take care in preparing these reports, a buyer should ensure that his/her legal representative confirms as soon as possible all matters relating to title including the extent and boundaries of the property and other important matters before exchange of contracts.



0141 613 3992



Burnside@allenandharris.co.uk



240 Stonelaw Road, Rutherglen, GLASGOW,
Lanarkshire, G73 3SA



allenandharris.co.uk

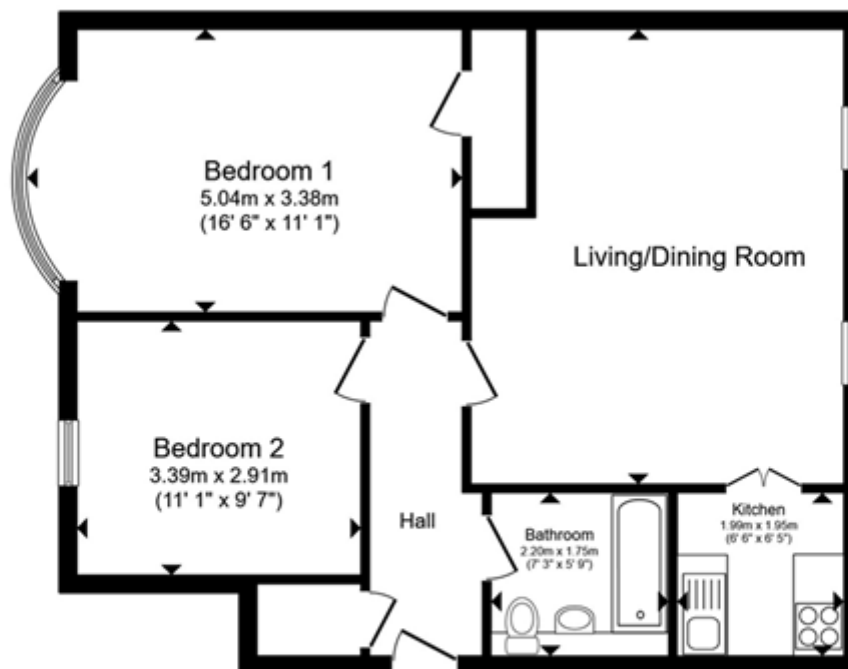

Total floor area 67.5 m² (726 sq.ft.) approx

This floor plan is for illustrative purposes only. It is not drawn to scale. Any measurements, floor areas (including any total floor area), openings and orientation are approximate. No details are guaranteed, they cannot be relied upon for any purpose and they do not form part of any agreement. No liability is taken for any error, omission or misstatement. A party must rely upon its own inspection(s). Powered by www.propertybox.io



view this property online allenandharris.co.uk/Property/BSD109229

1. MONEY LAUNDERING REGULATIONS Intending purchasers will be asked to produce identification documentation at a later stage and we would ask for your co-operation in order that there is no delay in agreeing the sale. 2. These particulars do not constitute part or all of an offer or contract. 3. The measurements indicated are supplied for guidance only and as such must be considered incorrect. Potential buyers are advised to recheck measurements before committing to any expense. 4. We have not tested any apparatus, equipment, fixtures or services and it is in the buyers interest to check the working condition of any appliances. 5. Where an EPC, or a Home Report (Scotland only) is held for this property, it is available for inspection at the branch by appointment. If you require a printed version of a Home Report, you will need to pay a reasonable production charge reflecting printing and other costs. 6. We are not able to offer an opinion either written or verbal on the content of these reports and this must be obtained from your legal representative. 7. Whilst we take care in preparing these reports, a buyer should ensure that his/her legal representative confirms as soon as possible all matters relating to title including the extent and boundaries of the property and other important matters before exchange of contracts.

Property Ref:
BSD109229 - 0002



0141 613 3992



Burnside@allenandharris.co.uk



240 Stonelaw Road, Rutherglen, GLASGOW,
Lanarkshire, G73 3SA



allenandharris.co.uk