



Martin Road, Ipswich, IP2 8BJ

welcome to

Martin Road, Ipswich

This characterful, end-terraced home benefits from three good-sized bedrooms, including an impressive master bedroom occupying the width of the property, two reception rooms, a large, modern, ground floor bathroom, a well-maintained rear garden and permit parking.

Entrance Hall

A fitted mat, carpet flooring, one radiator, a staircase and doors to reception rooms.

Lounge

Cosy lounge with double glazed window to the front, carpet flooring, one radiator, TV point, wall hung lights and bespoke fitted shelving.

Dining Room

Spacious dining room with double glazed window to the rear, original floorboards (in excellent condition), an understairs storage cupboard, one radiator, an alcove for a fireplace and fitted shelving.

Kitchen

Long, sweeping kitchen with two double glazed windows to the side, a door to the garden, a sliding door to the bathroom, eye and base level units in white with wood effect worktop surfaces, a stainless steel sink plus drainer and chrome mixer tap, an integrated double oven with gas hob and extractor hood, space for a washing machine, fridge/freezer and dishwasher, wood effect flooring and a utility area to the rear with a storage cupboard, space for a fridge/freezer and a fitted worktop.

Ground Floor Bathroom

Large bathroom with double glazed windows to the side and rear, low level WC, pedestal wash hand basin, a bath with shower attachment, part tiled walls, extractor fan, chrome heated towel rail and a sliding door to entry.

First Floor Landing

An airing cupboard, carpet flooring and loft hatch.

Master Bedroom

Spacious master bedroom, occupying the entire width of the property, with two double glazed windows to the front, carpet flooring, one radiator and a fitted fire place.

Bedroom Two

Double glazed window to the rear, carpet flooring, one radiator and a fireplace.

Bedroom Three

Double glazed window to the rear, carpet flooring and one radiator.

Outside:

Front Garden

Beautiful front garden with a walled border, a gate to entry, a shingle area with a bin store and an original tiled pathway leading to a covered porch.

Rear Garden

A sunny, well-maintained rear garden with a hard standing seating area, steps done to the remainder of the garden, an outside tap, fully enclosed, partially walled border, a rear gate, a grassed area, flower beds and a shed.

Parking

Permit parking is readily available at £64 per year.

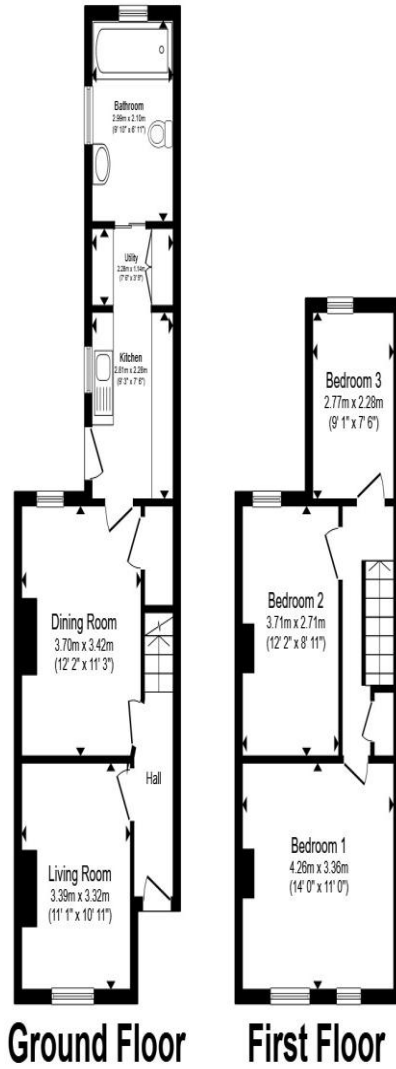

Total floor area 82.4 m² (887 sq.ft.) approx

This floor plan is for illustrative purposes only. It is not drawn to scale. Any measurements, floor areas (including any total floor area), openings and orientation are approximate. No details are guaranteed, they cannot be relied upon for any purpose and they do not form part of any agreement. No liability is taken for any error, omission or misstatement. A party must rely upon its own inspection(s). Powered by www.propertybox.io



welcome to
Martin Road,
Ipswich

- Double-skim walls
- Three good-sized bedrooms
- Two reception rooms
- Large, modern ground floor bathroom
- Permit parking readily available

Tenure: Freehold EPC Rating: D
Council Tax Band: B

offers in excess of
£220,000



view this property online williamhbrown.co.uk/Property/IPS121581



Property Ref:
IPS121581 - 0005

1. MONEY LAUNDERING REGULATIONS Intending purchasers will be asked to produce identification documentation at a later stage and we would ask for your co-operation in order that there is no delay in agreeing the sale. 2. These particulars do not constitute part or all of an offer or contract. 3. The measurements indicated are supplied for guidance only and as such must be considered incorrect. Potential buyers are advised to recheck measurements before committing to any expense. 4. We have not tested any apparatus, equipment, fixtures or services and it is in the buyers interest to check the working condition of any appliances. 5. Where an EPC, or a Home Report (Scotland only) is held for this property, it is available for inspection at the branch by appointment. If you require a printed version of a Home Report, you will need to pay a reasonable production charge reflecting printing and other costs. 6. We are not able to offer an opinion either written or verbal on the content of these reports and this must be obtained from your legal representative. 7. Whilst we take care in preparing these reports, a buyer should ensure that his/her legal representative confirms as soon as possible all matters relating to title including the extent and boundaries of the property and other important matters before exchange of contracts.

William H Brown is a trading name of Sequence (UK) Limited which is registered in England and Wales under company number 4268443, Registered Office is Cumbria House, 16-20 Hockliffe Street, Leighton Buzzard, Bedfordshire, LU7 1GN. VAT Registration Number is 500 2481 05.



william h brown



01473 226101



ipswich@williamhbrown.co.uk



16-18 Wolsey House, Princes Street, IPSWICH,
Suffolk, IP1 1QT



williamhbrown.co.uk