

SNELLERS

ESTATE AGENTS



Rosecroft Gardens, TW2

£595,000

Offered to the market with no onward chain and presented in excellent condition, is this beautiful semi-detached bungalow benefitting from two double bedrooms, a modern family bathroom, high quality Leicht German kitchen, potential to extend (STPP) and two garages.

Rosecroft Gardens is situated within the ever popular Rosebine development and is close to many excellent schools within the Richmond Borough. Twickenham town centre is easily accessible and Whitton mainline station is also close by.

- Bungalow • Two Garages • Modern Finish •
- Popular Location • Two Bedrooms • Private Garden •

SNELLERS

ESTATE AGENTS

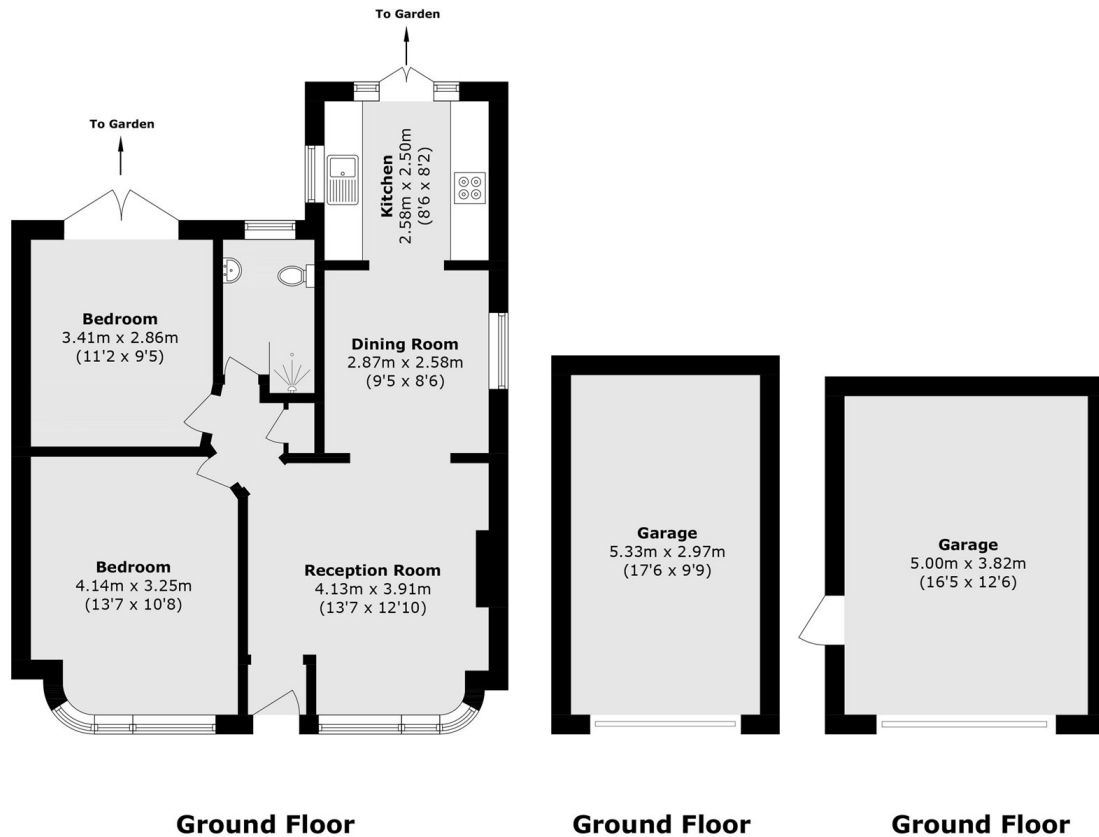

Total area (approx.): 58.7 sq. m (631.8 sq. ft)
Garage total (approx.): 34.9 sq m (375.6 sq. ft)

Snellers Twickenham Sales
64-66 Heath Road
Twickenham
TW1 4BX
020 8892 5555
twickenhamsales@snellers.co.uk

Energy Rating: C We aim to make our particulars both accurate and reliable. However they are not guaranteed; nor do they form part of an offer or contract. If you require clarification on any points then please contact us, especially if you're traveling some distance to view. Please note that appliances and heating systems have not been tested and therefore no warranties can be given as to their good working order