



Flat 3, 40 Osborne Road, Portsmouth, PO5 3LT

£650 Per Month Council Tax Band A Deposit £750



1



1



1



E

**Tully's**

## Floor Plan

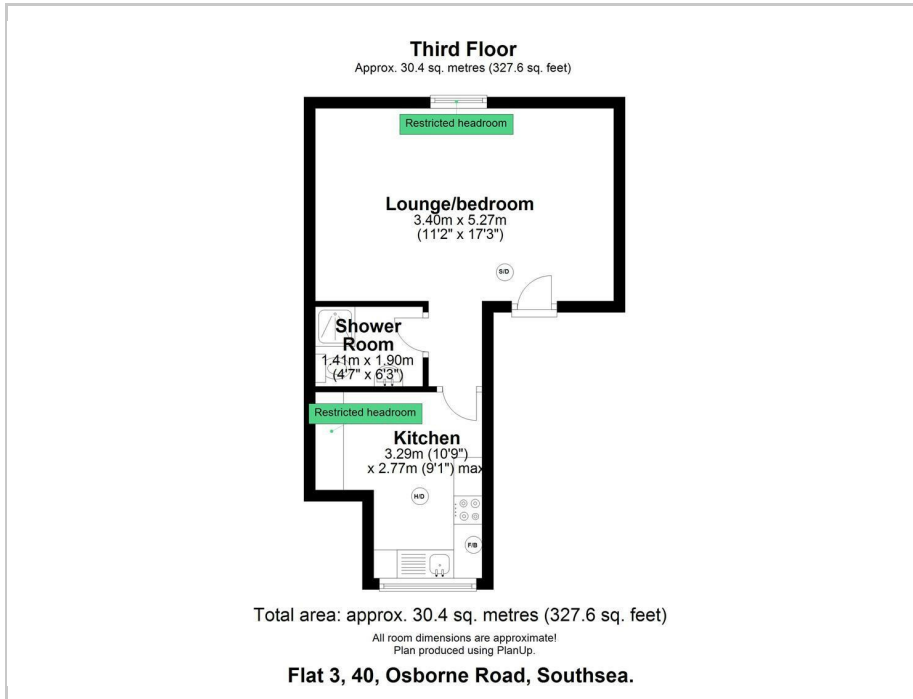

## Area Map

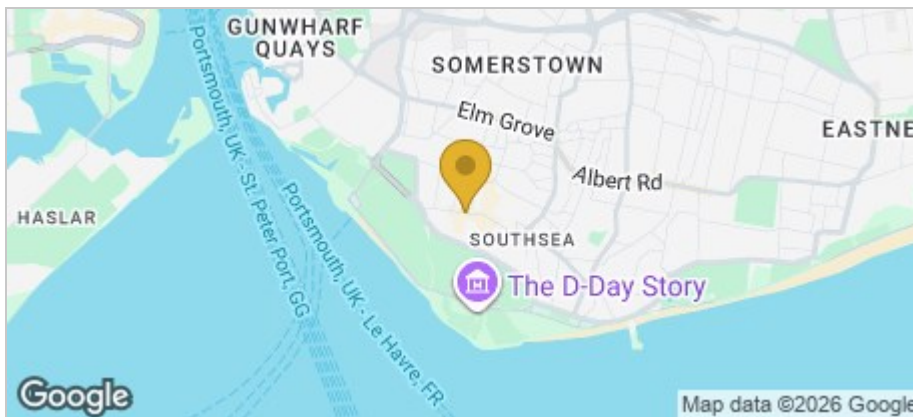

## Accommodation

- Holding Deposit - £150.00
- Deposit - £750.00
- STUDIO APARTMENT
- MOMENTS FROM THE BEACH
- CLOSE TO LOCAL SHOPS, BARS AND RESTAURANTS
- AVAILABLE TO MOVE INTO NOW
- THIRD FLOOR
- UNFURNISHED

## Viewing

Please contact our Southsea Office on 023 9273 2241 if you wish to arrange a viewing appointment for this property or require further information.

## Energy Efficiency Graph

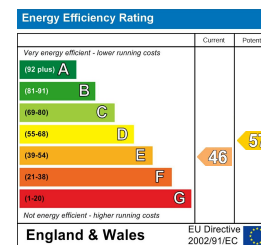

157-159 Albert Road, Southsea, Portsmouth, Hampshire, PO4 0JW  
023 9273 2241 Email: tully@tullyand.co lettings@tullyand.co

**Tully's**