



Lowick Gardens, PETERBOROUGH  
Offers in Excess of £180,000 **Freehold**

**Sharman  
Quinney**

# Key Features



- Two-bedroom Mid-terraced Property
- Bright and Spacious Lounge
- Garage and Private Rear Garden
- Front and Rear Gardens
- Ideal First-time Buyer or Investment Purchase

Tucked away in a popular residential setting, this well-presented two-bedroom mid-terraced home offers an ideal opportunity for first-time buyers, downsizers, or investors alike. The property combines practical living space with desirable outdoor area, allocated parking, and a garage - a rare and valuable combination.

The accommodation opens into a welcoming entrance leading through to a bright and comfortable lounge, perfect for relaxing or entertaining guests. The layout flows into a functional kitchen area with ample storage and worktop space, overlooking the rear garden.

Upstairs, the property offers two well-proportioned bedrooms, both benefiting from natural light and versatile space for bedroom furniture or home



working. A neatly presented family bathroom serves the first floor, completing the internal accommodation.

Externally, the home enjoys both front and rear gardens, offering space for outdoor seating. The property further benefits from a garage with a lined space for vehicle to have right of way, providing secure parking and additional storage.

Situated within convenient reach of local amenities, transport links, and green spaces, this home offers comfortable living in a practical and sought-after location.

Entrance Hall

Lounge

Kitchen Diner

Downstairs W/C

First Floor Landing

Bedroom One

Bedroom Two

Bathroom



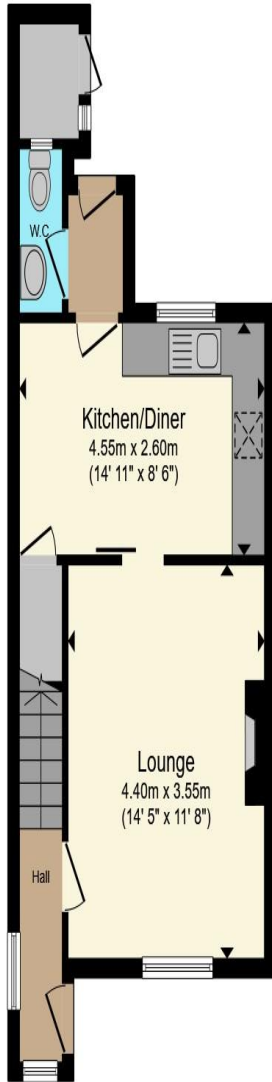

**Ground Floor**

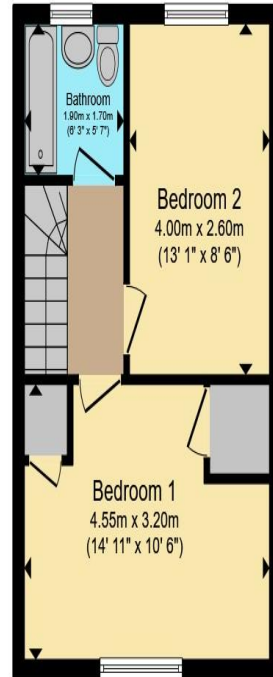

**First Floor**

Total floor area 70.2 m<sup>2</sup> (756 sq.ft.) approx

This floor plan is for illustrative purposes only. It is not drawn to scale. Any measurements, floor areas (including any total floor area), openings and orientation are approximate. No details are guaranteed, they cannot be relied upon for any purpose and they do not form part of any agreement. No liability is taken for any error, omission or misstatement. A party must rely upon its own inspection(s). Powered by [www.propertybox.io](http://www.propertybox.io)

**Sharman  
Quinney**

To view this property call Sharman Quinney on:  
**01733 897896**

# Selling your property?

Contact us to arrange a **FREE** home valuation.

 01733 897896

 70 Albert Place, PETERBOROUGH,  
Cambridgeshire, PE1 1DD

 peterborough@sharmanquinney.co.uk

 [www.sharmanquinney.co.uk](http://www.sharmanquinney.co.uk)



 SCAN ME



Sharman Quinney Holdings Limited is registered in England and Wales under company number 4174227, Registered Office is Cumbria House, 16-20 Hockliffe Street, Leighton Buzzard, Bedfordshire, LU7 1GN. VAT Registration Number is 500 2481 05.

1: These particulars do not constitute part or all of an offer or contract. 2: The measurements indicated are supplied for guidance only and as such must be considered incorrect. 3: Potential buyers are advised to recheck the measurements before committing to any expense. 4: Sharman Quinney has not tested any apparatus, equipment, fixtures, fittings or services and it is the buyers interests to check the working condition of any appliances. 5: Sharman Quinney has not sought to verify the legal title of the property and buyers must obtain verification from their legal representative. 6: Intending purchasers will be asked to produce identification documentation at a later stage and we would ask your co-operation in order that there will be no delay in agreeing the sale. Ref: PTB207560 - 0003

