



## Waun Road

guide price £210,000- £220,000

- Guide Price £210,000- £220,000
- Immaculately Presented Throughout
- Modern Kitchen & Bathroom
- Low Maintenance Landscaped Garden
- Generous Driveway Parking
- Sought-After Residential Location
- Excellent Transport Links to M4 & Rail Network
- Secure side entrance
- EPC Rating: C



**Pinkmove**

01633 746088  
team@pinkmove.co.uk



## About the property

Located on the ever-popular Waun Road in Cwmbran, this immaculately presented two double bedroom home is ideal for first-time buyers, downsizers or investors, offering practical and versatile accommodation throughout. The property comprises a bright living room, modern fitted kitchen, two double bedrooms and a stylish family bathroom with shower, perfectly suited to modern and everyday living.

The property further benefits from a well-maintained, low maintenance rear garden featuring a generous patio and raised decking area, ideal for outdoor dining and relaxing, along with decorative planting, secure fencing and a useful storage shed plus a larger shed, with full electricity. To the front, a driveway provides generous and convenient off-road parking.

Situated in a popular residential area, the property is close to Cwmbran Shopping Centre, well-regarded schools, local parks, and excellent transport links, including quick access to the A4042, M4 corridor and Cwmbran train station. Overall, a fantastic home in a convenient and sought-after location.

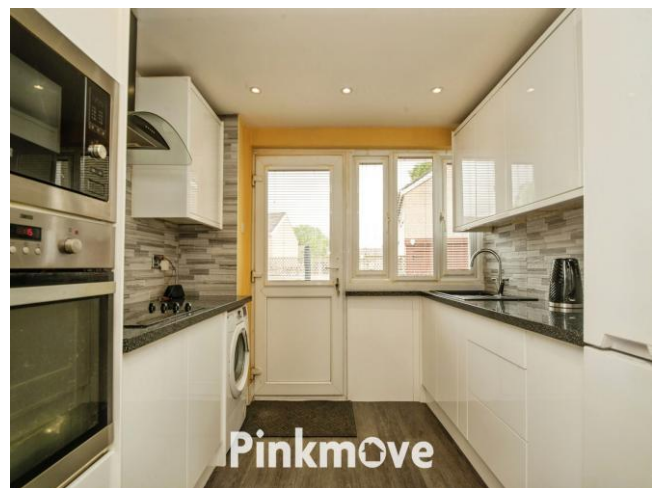



## Accommodation

Entrance Hall

Living Room

Kitchen

Landing

Bedroom One

Bedroom Two

Family Bathroom

## Floorplan

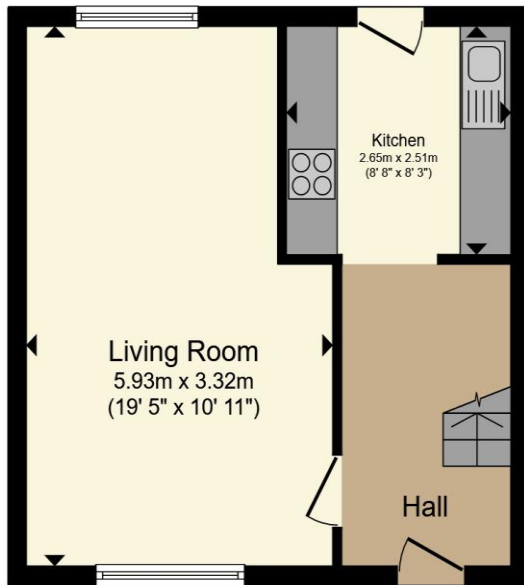

**Ground Floor**

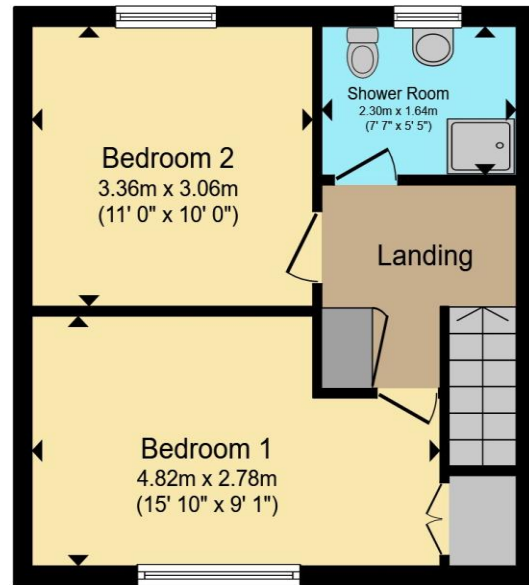

**First Floor**

Total floor area 67.8 sq.m. (730 sq.ft.) approx

This floor plan is for illustrative purposes only. It is not drawn to scale. Any measurements, floor areas (including any total floor area), openings and orientation are approximate. No details are guaranteed, they cannot be relied upon for any purpose and they do not form part of any agreement. No liability is taken for any error, omission or misstatement. A party must rely upon its own inspection(s). Powered by [www.localagent.com](http://www.localagent.com)

Pinkmove

## Important Information

Note while we endeavour to make our sales details accurate and reliable, if there is any point which is of particular interest to you, please contact the office and we will be pleased to confirm the position for you. We have not personally tested any apparatus, equipment, fixtures, fittings or services and cannot verify they are in working order or fit for their purposes. Nothing in these particulars is intended to indicate that carpets or curtains, furnishings or fittings, electrical goods (whether wired or not). Gas fires or light fittings or any other fixtures not expressly included form part of the property offered for sale. This computer generated Floorplan, if applicable, is intended as a general guide to the layout and design of the property. It is not to scale and should not be relied upon for dimensions. Tenure: We cannot confirm the tenure of the property as we have not had access to the legal documents. The buyer is advised to obtain verification from their solicitor or surveyor.

Peter Alan Limited is registered in England and Wales under company number 2073153. Registered Office is Cumbria House, 16-20 Hockliffe Street, Leighton Buzzard, Bedfordshire, LU7 1GN. VAT Registration Number is 500 2481 05. For activities relating to regulated mortgages and non-investment insurance contracts, Peter Alan Limited is an appointed representative of Connells Limited which is authorised and regulated by the Financial Conduct Authority. Connells Limited's Financial Services Register number is 302221. Most buy-to-let

