



£538,950

Avonwick Road

Hounslow, TW3 4DX

PROPERTY SUMMARY

A significantly larger-than-average three-bedroom terraced home, ideally situated in a prime location for excellent transport links.

Having been lovingly owned by the same family for over 40 years, the property has been well maintained and offers a wonderful opportunity for its next chapter. Internally, the home features two spacious reception rooms, a separate kitchen, and a ground floor bathroom. To the first floor are three generous double bedrooms, along with a family bathroom.

Externally, the property boasts a substantial rear garden, offering excellent potential for extension (subject to planning permission). Offered to the market with no onward chain, this is an ideal opportunity for families and investors alike.

Avonwick Road is located within Hounslow Central, a well-connected and established residential area in West London. The wider Hounslow town centre is a recognised metropolitan hub, situated approximately 10 miles from Central London, offering a strong mix of retail, leisure and transport links.

3



1



2





Approximate Gross Internal Area = 133.84 sq m / 1441 sq ft
 Outbuilding = 9.32 sq m / 100 sq ft
 Total = 143.16 sq m / 1541 sq ft

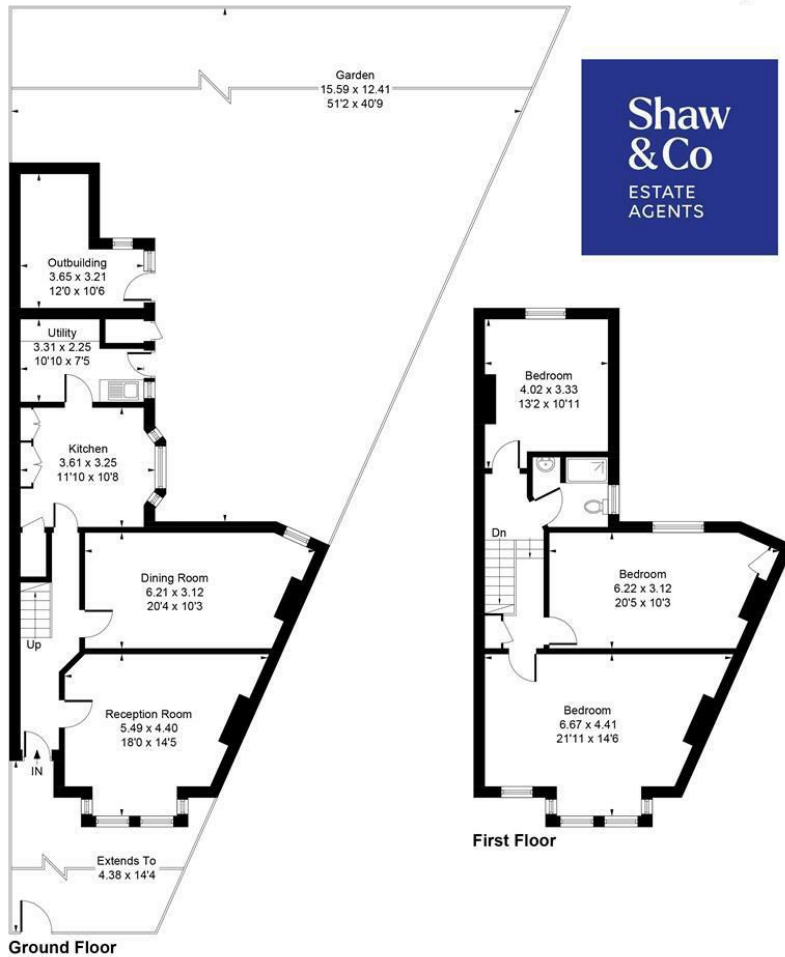

Whilst every attempt has been made to ensure the accuracy of the floor plan contained here, measurements of doors, windows, rooms and any other items are approximate and no responsibility is taken for any error, omission, or mis-statement. This plan is for illustrative purposes only and should be used as such by any prospective purchaser.
 © Vizion Property Marketing Produced for Shaw & Co.

LOCAL AUTHORITY

Hounslow

TENURE

Freehold

COUNCIL TAX BAND

VIEWINGS

By prior appointment only

Energy Efficiency Rating		Current	Potential
Very energy efficient - lower running costs			
(92 plus) A			
(81-91) B			
(69-80) C			
(55-68) D			
(39-54) E			
(21-38) F			
(1-20) G			
Not energy efficient - higher running costs			
England & Wales		EU Directive 2002/91/EC	



Agents Note: Whilst every care has been taken to prepare these particulars, they are for guidance purposes only. All measurements are approximate and are for general guidance purposes only and whilst every care has been taken to ensure their accuracy, they should not be relied upon and potential buyers/tenants are advised to recheck the measurements

Shaw & Co
 ESTATE AGENTS

OFFICE ADDRESS
 10 Central Parade
 New Heston Road
 Heston
 Middlesex
 TW5 0LJ

OFFICE DETAILS
 0208 570 7258
 heston@shawandcoestates.com