



For Sale

40 Devon Way, Northampton

£147,500

2

1

2

76 sq m

**Affordable and modern, this two-bedroom terraced house in Spinney Hill offers a unique opportunity with 50% shared ownership. With a large lounge/diner and parking for two vehicles, it's ideal for first-time buyers.**

This affordable two-bedroom terraced house on Devon Way, Northampton, presents a unique opportunity with 50% shared ownership. Built in 2022, it offers contemporary living in the sought-after area of Spinney Hill. The property features a large lounge/diner, perfect for everyday living and entertaining guests. With two double bedrooms and a modern bathroom, it provides comfortable accommodation for a small family or professionals.

The property benefits from allocated parking for two vehicles, an attractive feature for those with multiple cars. The new build from July 2022 means you'll enjoy the peace of mind that comes with a builder's warranty still in place. Its location is convenient for access to local amenities, making daily errands straightforward and efficient.

Spinney Hill is known for its community feel and proximity to Northampton's town centre. The area offers reputable schools and green spaces, making it appealing for families and individuals alike. With easy access to transport links, including nearby bus routes, commuting or travelling further afield is hassle-free.

This property represents an excellent opportunity to secure an affordable home in a desirable location. Take advantage of this chance to invest in your future today.

Shared Ownership Details

**Joel Beardsmore**

07989715168

joel@thepropertyexperts.co.uk



 **The  
Property  
Experts**

**The Property Experts UK**

01604422551

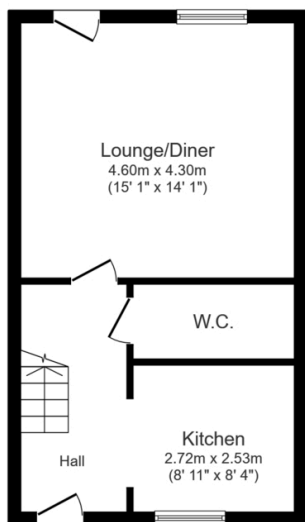

Ground Floor

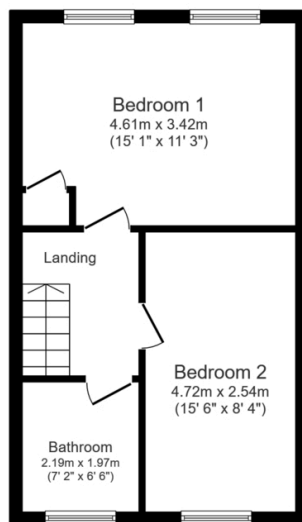

First Floor

Total floor area: 76.0 sq.m. (818 sq.ft.)

This floor plan is for illustrative purposes only. It is not drawn to scale. Any measurements, floor areas (including any total floor area), openings and orientations are approximate. No details are guaranteed; they cannot be relied upon for any purpose and do not form any part of any agreement. No liability is taken for any error, omission or misstatement. A party must rely upon its own inspection(s). Powered by www.Propertybox.io

- 50% Shared Ownership
- 2 Bedroom Terrace
- Two Double Bedrooms
- Large Lounge/Diner
- Allocated parking for 2 Vehicles
- Close to local amenities
- New Build from July 2022
- Sought after area of Spinney Hill
- Builders Warranty remaining

