



Orchard Crescent, Enfield EN1 3NS

welcome to

Orchard Crescent, Enfield

A beautifully appointed and extended four bedroom 1930's built house, in this delightful quiet turning, just off Willow Road, within level walking distance of Enfield Town shopping centre and rail stations (Liverpool Street Line). Good schools are also close at hand.

The particularly well presented accommodation features:-





Entrance Hall

Ceramic tiled floor, column radiator, cupboard housing gas central heating boiler.

Lounge

13' 8" x 12' 9" (4.17m x 3.89m)
Laminate floor, attractive open fireplace with stone mantel, modern radiator, open planned to:-

Dining Room

12' 6" x 11' 10" (3.81m x 3.61m)
Laminate floor, modern radiator, double glazed French windows to garden.

Kitchen

7' 6" x 7' 4" (2.29m x 2.24m)
Comprehensively fitted in modern units, comprising base units with granite worktops, Miele ceramic hob with fume extractor hood over, built-in oven, integrated dishwasher, inset one and a half bowl stainless steel sink unit, matching wall cabinets, ceramic tiled floor.

First Floor

Landing

Laminate floor.

Bedroom One

12' 8" max x 11' 6" (3.86m max x 3.51m)
Laminate floor, radiator, bay with shutters.

Bedroom Two

11' 2" x 10' 5" (3.40m x 3.17m)
Laminate floor, radiator, shutters to window.

Bedroom Three

7' 6" x 6' 1" (2.29m x 1.85m)
Laminate floor, radiator.

Family Bathroom

Panelled bath with rain shower, shower screen, bracket wash hand basin, low flush WC (white suite), ceramic tiled floor and walls, heated towel rail.

Second Floor

Bedroom Four (Master Bedroom)

17' 6" x 11' 7" (5.33m x 3.53m)
Eaves cupboard, range of built-in wardrobe cupboards, double glazed French windows to Juliet balcony with delightful views.

En-Suite Shower Room / Wc

Walk-in shower area, vanity wash hand basin with cupboard under, low flush WC (white suite), ceramic tiled floor, heated towel rail.

Outside

Rear Garden

Delightful south facing rear garden with synthetic lawn and shrub borders, full width decking patio, large pine den 9' 2" x 9' 1" with power and lighting, French windows onto garden. Timber shed 9' 1" x 4' 10" with power and lighting.



view this property online barnfields.co.uk/Property/ENF105874



welcome to

Orchard Crescent, Enfield

- Spacious Attractive Lounge
- Good Sized Dining Room
- Modern Fitted Kitchen
- Four Good Sized Bedrooms
- Two Bathrooms (One En-Suite)

Tenure: Freehold EPC Rating: C

£650,000

Orchard Crescent, Enfield, EN1

Approximate Area = 1122 sq ft / 104.2 sq m
 Limited Use Area(s) = 173 sq ft / 16 sq m
 Outbuilding = 127 sq ft / 11.7 sq m
 Total = 1422 sq ft / 131.9 sq m
 For identification only - Not to scale

Denotes restricted head height

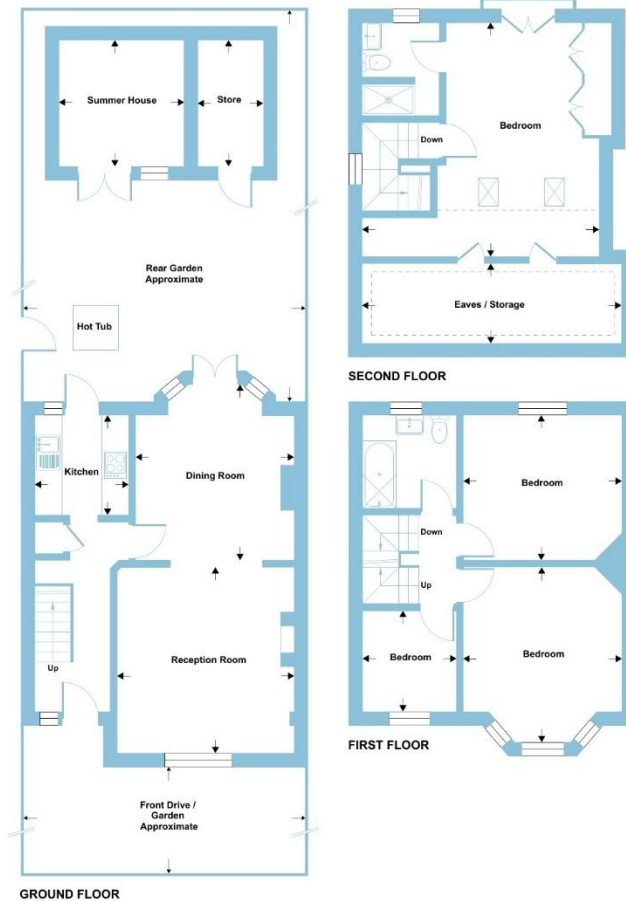

Please note the marker reflects the postcode not the actual property

check out more properties at [barnfields.co.uk](https://www.barnfields.co.uk)

Floor plan produced in accordance with RICS Property Measurement 2nd Edition, Incorporating International Property Measurement Standards (IPMS2 Residential). © nitchecom 2026. Produced for Barnard Marcus. REF: 1480930



Property Ref:
ENF105874 - 0001

1. MONEY LAUNDERING REGULATIONS Intending purchasers will be asked to produce identification documentation at a later stage and we would ask for your co-operation in order that there is no delay in agreeing the sale. 2. These particulars do not constitute part or all of an offer or contract. 3. The measurements indicated are supplied for guidance only and as such must be considered incorrect. Potential buyers are advised to recheck measurements before committing to any expense. 4. We have not tested any apparatus, equipment, fixtures or services and it is in the buyers interest to check the working condition of any appliances. 5. Where an EPC, or a Home Report (Scotland only) is held for this property, it is available for inspection at the branch by appointment. If you require a printed version of a Home Report, you will need to pay a reasonable production charge reflecting printing and other costs. 6. We are not able to offer an opinion either written or verbal on the content of these reports and this must be obtained from your legal representative. 7. Whilst we take care in preparing these reports, a buyer should ensure that his/her legal representative confirms as soon as possible all matters relating to title including the extent and boundaries of the property and other important matters before exchange of contracts.

Barnfields is a trading name of Sequence (UK) Limited which is registered in England and Wales under company number 4268443, Registered Office is Cumbria House, 16-20 Hockliffe Street, Leighton Buzzard, Bedfordshire, LU7 1GN. VAT Registration Number is 500 2481 05.



020 8363 3394



info@barnfields.com



1a Windmill Hill, Enfield, Middlesex, EN2 6SE



[barnfields.co.uk](https://www.barnfields.co.uk)