



BROMPTON SQUARE KNIGHTSBRIDGE SW3
£700 PER WEEK AVAILABLE 07/09/2026

Hamptons
THE HOME EXPERTS

{ THE PARTICULARS

Brompton Square Knightsbridge
SW3

£700 Per Week
Furnished

-  1 Bedroom
-  1 Bathroom
-  1 Reception

Features

- *SHORT LET ALL BILLS INCLUDED* , -
- One Bedroom / One Bathroom, - 2nd Floor, - Communal Garden Access, - Permit
- Parking Available, - Furnished, - Council Tax Band F
- Council Tax
- Council Tax Band F

Hamptons
7 Lower Sloane Street
Sloane Square, London, SW1W 8AH
020 7824 8242
sloanesquarelettings@hamptons.co.uk
www.hamptons.co.uk

{ SECOND FLOOR ONE BEDROOM FLAT WITH VIEWS OF COMMUNAL GARDENS

The Property

A modern one bedroom apartment situated on the second floor, boasting a wealth of natural light and communal garden views. The property consists of a large reception with an open plan kitchen with an abundance of natural light and delightful backdrop, the bedroom is set to the rear of the building with a very quiet aspect. The flat further benefits from a modern bathroom with bath and separate shower.

Location

Brompton Square is a delighted garden square and considered to be a Prime Knightsbridge address accessed from the Brompton Road, the closest underground station is South Kensington being 0.4 miles away and offering District & Circle and Piccadilly lines for ease of travel both in to Central London and or Heathrow.



BROMPTON SQUARE

Approximate Gross Internal Area = 463 sq. ft. (43.0 sq. m.)

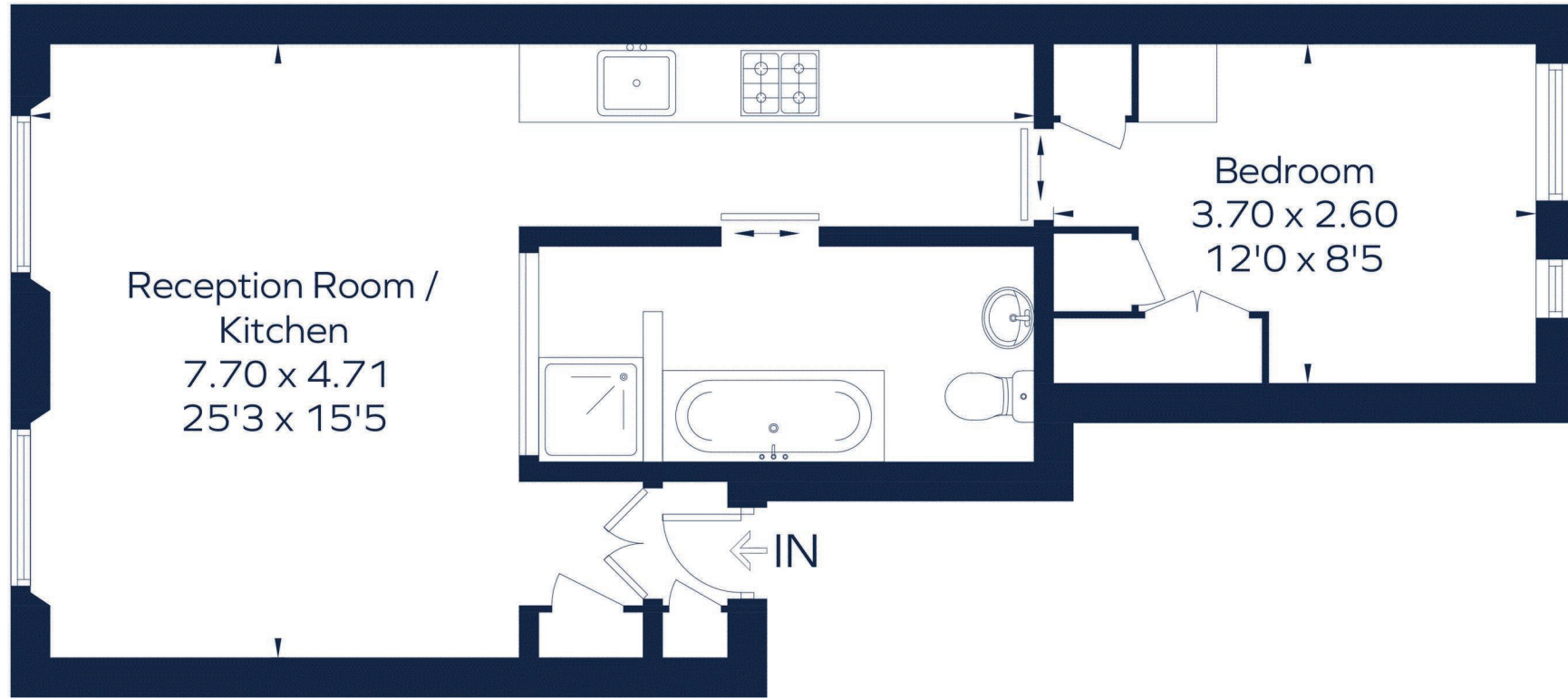

Second Floor

Drawn for illustration and identification purposes only.
ID 1284311

For Clarification

We wish to inform prospective tenants that we have prepared these particulars as a general guide and they have been confirmed as accurate by the landlord. We have not verified permissions, nor carried out a survey, tested the services, appliances and specific fittings. Room sizes are approximate and measurement figures rounded: they are taken between internal wall surfaces and therefore include cupboards/shelves, etc. Accordingly, they should not be relied upon for

carpets and furnishings. It should also be noted that all fixtures and fittings, carpeted, curtains/blinds, kitchen equipment and garden statuary, whether fitted or not, are deemed removable by the landlord unless specifically itemised with these particulars. Please enquire in office or on our website for details on holding deposit and tenancy deposit figures.

