



**School Place, Seaward Road, Southampton SO19 2HA**

**welcome to**

## **School Place Seaward Road, Southampton**

\*TWO BEDROOM TERRACED HOUSE \* LOUNGE/DINER \* FRONT & REAR GARDENS \* ALLOCATED PARKING \* FAMILY BATHROOM \* CLOSE TO LOCAL AMENITIES & SCHOOLS \* FANTASTIC LOCATION

### **Lounge/Diner**

18' 10" x 11' 1" ( 5.74m x 3.38m )

Double glazed window to front aspect, carpeted throughout, gas radiator, dining space, opens up onto kitchen.

### **Kitchen**

11' 1" x 8' 10" ( 3.38m x 2.69m )

Wall & base mounted units, ample work top space, electric oven, gas hob, overhead extractor, undercounter plumbing for white goods, stainless steel sink & drainer, double glazed window to rear aspect, UPVC door with double glazed window onto garden, stairs leading to;

### **Landing**

Access too all rooms, leading too;

### **Bedroom One**

11' 7" x 11' 1" ( 3.53m x 3.38m )

Double glazed window to front aspect, carpets throughout, gas radiator, wardrobe space.

### **Bedroom Two**

8' 11" x 8' 10" ( 2.72m x 2.69m )

Double glazed window to rear aspect, carpets throughout, gas radiator, built in storage.

### **Bathroom**

Bath tub, overhead shower, low level w/c, wash hand basin, heated towel rail, part tiled walls.

### **Rear Garden**

Steps down to stoned area, raised decking for seating, storage unit, outside tap.

### **Parking**

Allocated space & visitor parking.





**Situated in the popular residential area of Peartree, Woolston, this well-presented two-bedroom terraced home offers comfortable living in a highly convenient location. The property has been well looked after throughout, providing a welcoming feel from the moment you step inside.**

**The accommodation is thoughtfully arranged, offering a bright and practical living space, ideal for first-time buyers, downsizers or investors alike. Externally, the home benefits from allocated parking, ensuring ease and convenience for residents and visitors.**

**One of the standout features of this property is its excellent location. Positioned within Peartree, the property is within close proximity to a range of local schools, shops and everyday amenities, making it perfectly suited for modern living. It also benefits from fantastic transport links, including easy access to the M27 motorway, while Southampton City Centre is just a short distance away for a wider selection of shopping, dining and leisure facilities.**

**For those who enjoy the outdoors, there are also lovely nearby walks to be enjoyed, adding to the overall appeal of this home.**



***view this property online*** [fox-and-sons.co.uk/Property/BIT113261](https://fox-and-sons.co.uk/Property/BIT113261)



welcome to

## School Place Seaward Road, Southampton

- Two Bedroom Terraced House
- Lounge/Diner
- Front & Rear Gardens
- Allocated Parking
- Family Bathroom

Tenure: Freehold EPC Rating: C  
Council Tax Band: A

**£230,000**

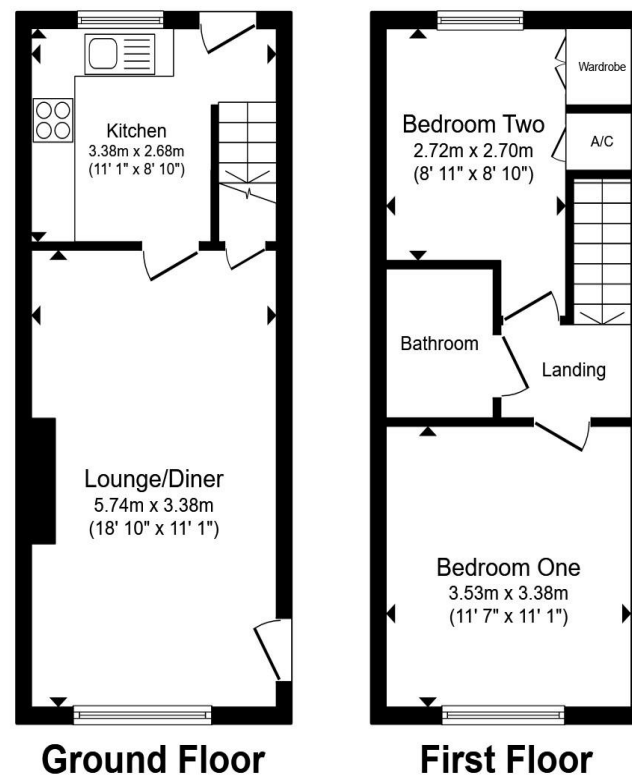

Total floor area 57.6 m<sup>2</sup> (620 sq.ft.) approx

This floor plan is for illustrative purposes only. It is not drawn to scale. Any measurements, floor areas (including any total floor area), openings and orientation are approximate. No details are guaranteed, they cannot be relied upon for any purpose and they do not form part of any agreement. No liability is taken for any error, omission or misstatement. A party must rely upon its own inspection(s). Powered by [www.propertybox.io](http://www.propertybox.io)



view this property online [fox-and-sons.co.uk/Property/BIT113261](http://fox-and-sons.co.uk/Property/BIT113261)



Property Ref:  
BIT113261 - 0004

1. MONEY LAUNDERING REGULATIONS Intending purchasers will be asked to produce identification documentation at a later stage and we would ask for your co-operation in order that there is no delay in agreeing the sale. 2. These particulars do not constitute part or all of an offer or contract. 3. The measurements indicated are supplied for guidance only and as such must be considered incorrect. Potential buyers are advised to recheck measurements before committing to any expense. 4. We have not tested any apparatus, equipment, fixtures or services and it is in the buyers interest to check the working condition of any appliances. 5. Where an EPC, or a Home Report (Scotland only) is held for this property, it is available for inspection at the branch by appointment. If you require a printed version of a Home Report, you will need to pay a reasonable production charge reflecting printing and other costs. 6. We are not able to offer an opinion either written or verbal on the content of these reports and this must be obtained from your legal representative. 7. Whilst we take care in preparing these reports, a buyer should ensure that his/her legal representative confirms as soon as possible all matters relating to title including the extent and boundaries of the property and other important matters before exchange of contracts.

Fox & Sons is a trading name of Sequence (UK) Limited which is registered in England and Wales under company number 4268443, Registered Office is Cumbria House, 16-20 Hockliffe Street, Leighton Buzzard, Bedfordshire, LU7 1GN. VAT Registration Number is 500 2481 05.



**023 8044 6724**



[Bitterne@fox-and-sons.co.uk](mailto:Bitterne@fox-and-sons.co.uk)



390c Bitterne Road, Bitterne, SOUTHAMPTON,  
Hampshire, SO18 5RS



[fox-and-sons.co.uk](http://fox-and-sons.co.uk)