



BROOMHILL ROAD, SW18

£425,000

- Two double bedrooms
- Two Bathrooms
- Close to Wandsworth Town
- Allocated parking
- Desirable location
- Energy rating: C





## ABOUT THE HOME

A spacious two bedroom flat in a modern development located just moments from the centre of Wandsworth.

Accommodation comprises; a large open plan kitchen / living room, two generous double bedrooms and two good sized bathrooms. The property also benefits from ample built in storage throughout, direct access to the developments communal gardens from the living space and allocated off street parking.

Located in Wandsworth Town with easy access to the excellent transport links, including Wandsworth Town mainline station and numerous bus links, just moments away. There are an abundance of shops, cafés, bars and restaurants local to Wandsworth Town Centre and Southside shopping centre.





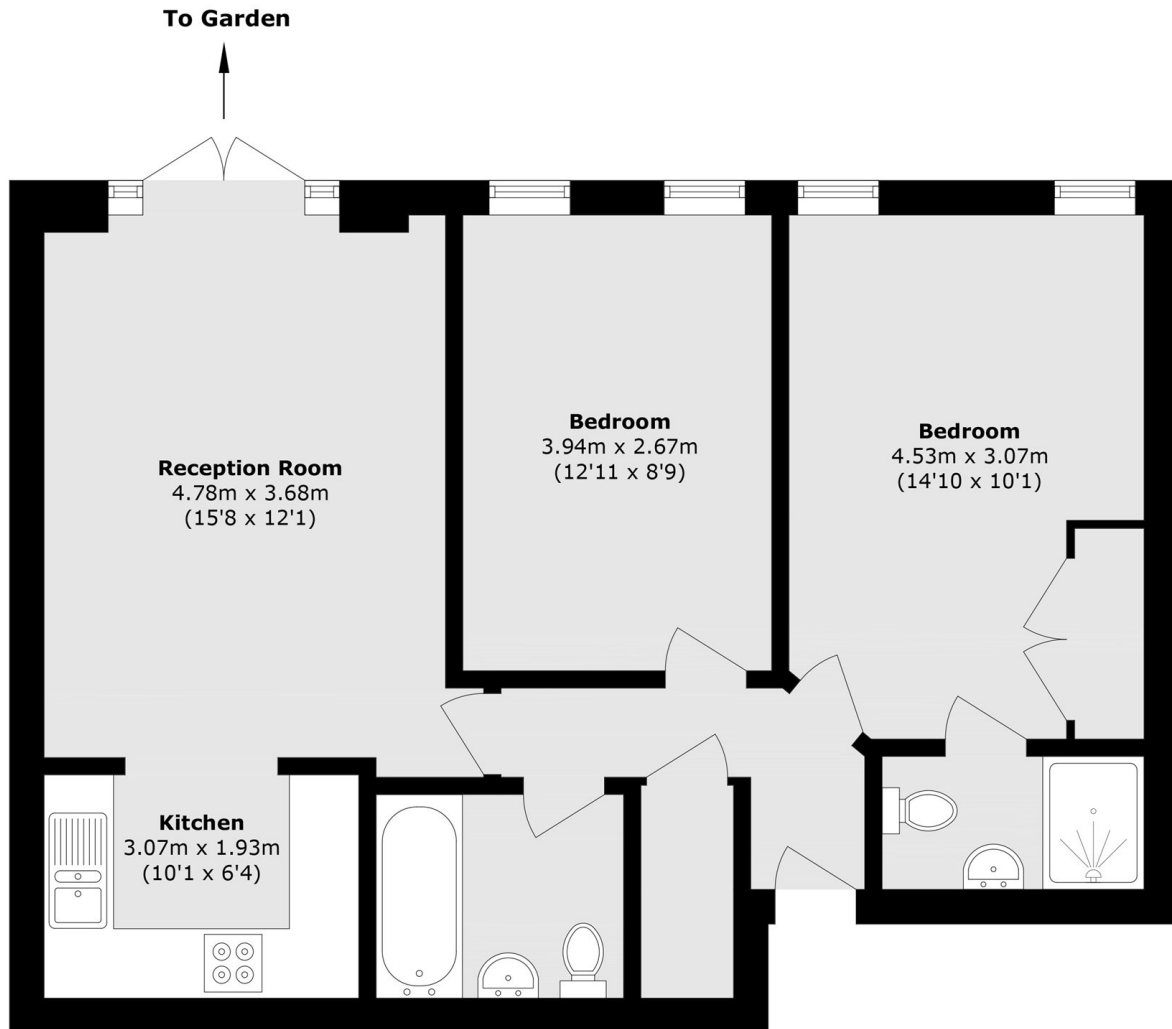

Total area (approx.): 61.0 sq. m (656.6 sq. ft)

#### JACKSONS EARLSFIELD

372-374 Garratt Lane,  
Earlsfield, London, SW18 4ES  
Sales: 020 8971 7979  
Lettings: 020 8971 7070

Energy Rating: C We aim to make our particulars both accurate and reliable. However they are not guaranteed; nor do they form part of an offer or contract. If you require clarification on any points then please contact us, especially if you're traveling some distance to view. Please note that appliances and heating systems have not been tested and therefore no warranties can be given as to their good working order.