



**Flat 4 Cygnet House, Boulters Court, Maidenhead SL6 8TU**

**welcome to**

**Flat 4 Cygnet House, Boulders Court, Maidenhead**

A beautifully presented two-bedroom ground-floor apartment situated in the highly desirable Cygnet House development, offering modern living, generous proportions and superb convenience just moments from Maidenhead town centre and transport links.





# Cygnets House, Boulton's Court, Maidenhead, SL6

Approximate Area = 753 sq ft / 70 sq m

For identification only - Not to scale

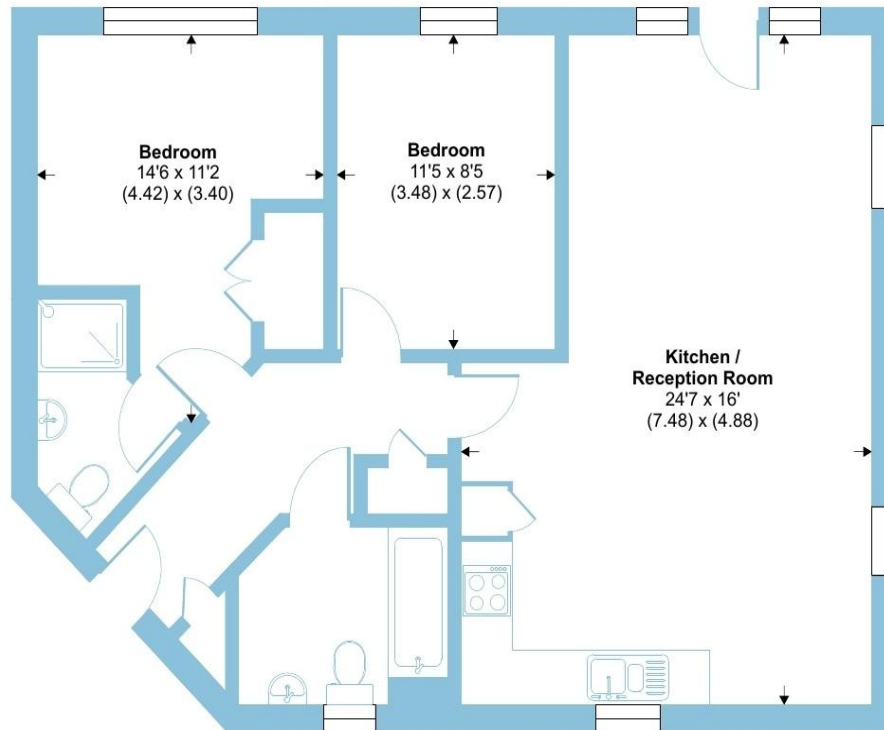

SECOND FLOOR

Upon entering, you are welcomed into a spacious hallway that provides excellent storage and leads into a bright, open-plan living and dining area. Large windows allow natural light to flood the room, creating a warm and inviting atmosphere, while the layout offers ample space for both relaxation and entertaining. The contemporary kitchen is well-equipped with modern cabinetry, integrated appliances and generous worktop space, making it ideal for everyday cooking and hosting guests.

The property features two well-proportioned bedrooms, each offering a calm and comfortable setting. The principal bedroom includes fitted wardrobes, while the second bedroom is perfect as a guest room, nursery or dedicated home office. A stylish family bathroom with a modern three-piece suite completes the interior.

One of the standout features of this ground-floor apartment is the direct access to communal gardens, providing a pleasant outdoor space to enjoy without the maintenance responsibilities of a private garden. The development also offers allocated parking and secure entry, enhancing both ease of living and peace of mind.

Ideally located, Cygnets House is within walking distance of Maidenhead's vibrant town centre, local amenities, riverside walks and Maidenhead Station - offering fast Elizabeth Line services into London. With superb access to the A404 and M4, the property is perfectly positioned for commuters.

welcome to

## Flat 4 Cygnet House, Boulters Court

- HIGHLY DESIRABLE DEVELOPMENT
- BEAUTIFULLY PRESENTED GROUND FLOOR APARTMENT
- CONTEMPORARY KITCHEN
- TWO WELL PROPORTIONED BEDROOMS
- DIRECT ACCESS TO COMMUNAL GARDENS
- ALLOCATED PARKING
- WITHIN WALKING DISTANCE OF TOWN & STATION
- SUPERB ACCESS TO A404 & M4

Tenure: Leasehold EPC Rating: C

Council Tax Band: D Service Charge: 1698.00

Ground Rent: 300.00

This is a Leasehold property with details as follows; Term of Lease 125 years from 01 Nov 2004. Should you require further information please contact the branch. Please Note additional fees could be incurred for items such as Leasehold packs.

offers over

# £367,500



Please note the marker reflects the postcode not the actual property

check out more properties at [rogerplatt.co.uk](http://rogerplatt.co.uk)



Property Ref:  
MHD119418 - 0005

1. MONEY LAUNDERING REGULATIONS Intending purchasers will be asked to produce identification documentation at a later stage and we would ask for your co-operation in order that there is no delay in agreeing the sale. 2. These particulars do not constitute part or all of an offer or contract. 3. The measurements indicated are supplied for guidance only and as such must be considered incorrect. Potential buyers are advised to recheck measurements before committing to any expense. 4. We have not tested any apparatus, equipment, fixtures or services and it is in the buyers interest to check the working condition of any appliances. 5. Where an EPC, or a Home Report (Scotland only) is held for this property, it is available for inspection at the branch by appointment. If you require a printed version of a Home Report, you will need to pay a reasonable production charge reflecting printing and other costs. 6. We are not able to offer an opinion either written or verbal on the content of these reports and this must be obtained from your legal representative. 7. Whilst we take care in preparing these reports, a buyer should ensure that his/her legal representative confirms as soon as possible all matters relating to title including the extent and boundaries of the property and other important matters before exchange of contracts.

Roger Platt is a trading name of Sequence (UK) Limited which is registered in England and Wales under company number 4268443, Registered Office is Cumbria House, 16-20 Hockliffe Street, Leighton Buzzard, Bedfordshire, LU7 1GN. VAT Registration Number is 500 2481 05.

  
roger platt



**01628 773333**



[Maidenhead@rogerplatt.co.uk](mailto:Maidenhead@rogerplatt.co.uk)



25-29 Queen Street, MAIDENHEAD, Berkshire,  
SL6 1NB



[rogerplatt.co.uk](http://rogerplatt.co.uk)