



WARE & CO
estate and letting agents

5 The Bungalows, Elms Estate, Monkton Heathfield – TA2 8NY
£225,000

5 The Bungalows, Elms Estate

Monkton Heathfield, Taunton

- End terrace bungalow in a popular residential location
- Offered for sale with no onward chain
- Professionally redecorated throughout
- Newly fitted carpets throughout
- Spacious living room
- Kitchen/breakfast room with ample storage
- Two generous double bedrooms
- Three-piece bathroom suite
- Driveway providing off-road parking
- Enclosed private rear garden with timber garden shed

TOTAL FLOOR AREA 66 sq.m.

TENURE Freehold

COUNCIL TAX Somerset Council Tax Band A. Charges payable for 2026/27 - £1,802.78

SERVICES Main services of gas, electricity, water and drainage are connected. Gas fired central heating with radiators. Broadband speeds of up to 1000mbps and good mobile signal across the four main networks.

EPC Energy Efficiency Rating: D



Offered to the market with **no onward chain**, this beautifully presented end terrace bungalow has been professionally redecorated throughout and benefits from brand new carpets, providing a superb opportunity for purchasers seeking a home that is ready to move straight into.

Situated within the ever-popular village of Monkton Heathfield, the property enjoys a private position with driveway parking to the front and a fully enclosed rear garden, making it an ideal purchase for downsizers, first-time buyers or those seeking a low-maintenance home.

The accommodation begins with a sheltered portico entrance leading into a welcoming and spacious living room that provides an excellent space for both relaxing and entertaining, whilst the generous kitchen/breakfast room offers a range of fitted units with ample worktop space and room for everyday dining.

There are two well-proportioned double bedrooms, each enjoying pleasant outlooks, together with a three-piece bathroom fitted with a bath, wash hand basin and WC.

Outside, the property benefits from off-road driveway parking to the front. The enclosed rear garden enjoys a good degree of privacy and has been designed for ease of maintenance, with space for outdoor seating and entertaining, together with a useful timber garden shed providing additional storage.



THE AREA

Monkton Heathfield is one of Taunton's most desirable residential locations, combining the convenience of excellent local amenities with easy access to the town centre and surrounding countryside. The village offers a range of everyday facilities including a village store, public house, primary school and community hall, whilst nearby Taunton provides an extensive selection of shopping, leisure and educational facilities. Excellent transport connections include easy access to Junction 25 of the M5 motorway, Taunton railway station with direct services to London Paddington and the A358 linking to the A303, making the area particularly attractive for commuters. Scenic countryside walks and nearby parkland further enhance the appeal of this well-established Somerset village.

Presented in excellent decorative order throughout and available immediately with vacant possession, this delightful bungalow offers comfortable single-storey living in one of Taunton's most sought-after residential locations.



GROUND FLOOR
660 sq.ft. (61.3 sq.m.) approx.

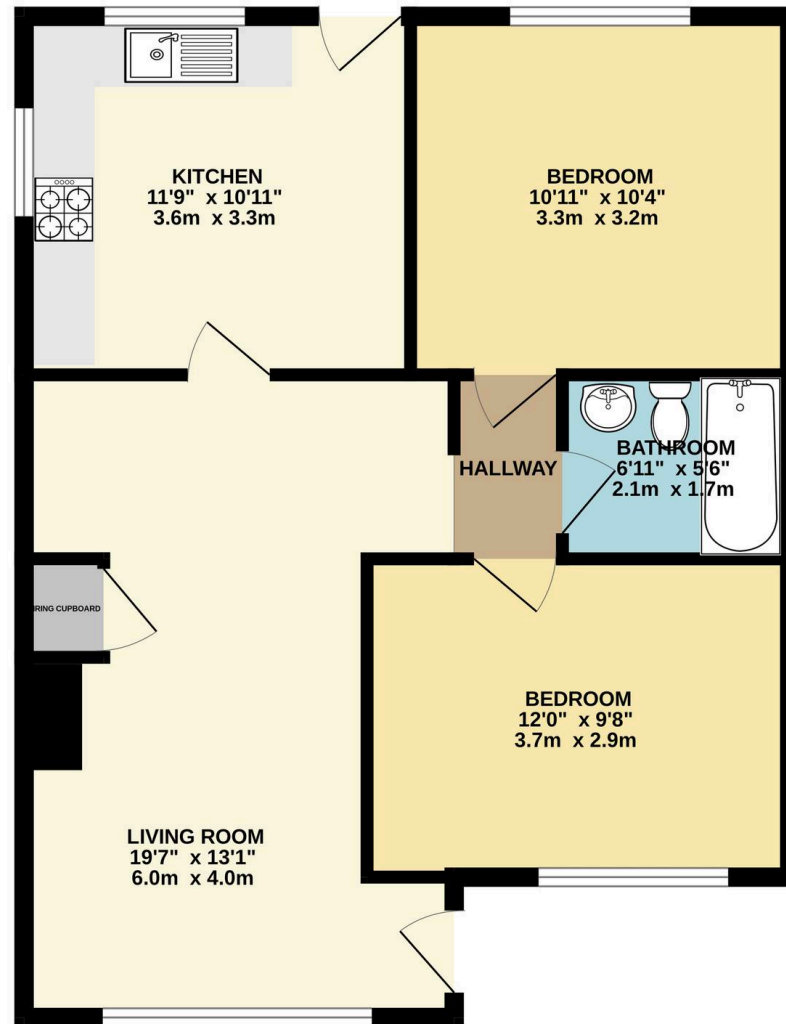

TOTAL FLOOR AREA : 660 sq.ft. (61.3 sq.m.) approx.

Whilst every attempt has been made to ensure the accuracy of the floorplan contained here, measurements of doors, windows, rooms and any other items are approximate and no responsibility is taken for any error, omission or mis-statement. This plan is for illustrative purposes only and should be used as such by any prospective purchaser. The services, systems and appliances shown have not been tested and no guarantee as to their operability or efficiency can be given.
Made with Metropix ©2026



Ware & Co

Ware & Co, 53 Bridge Street - TA1 1TP

01823259604 • info@wareandco.com • www.wareandco.com

