



## Greenmeadow Avenue, Newport

**Guide Price £210,000 - £220,000**

- Recently renovated throughout so ready to move straight into
- Newly fitted boiler and radiators throughout
- Off-road parking via driveway
- Generous enclosed rear garden
- Modern kitchen/dining room
- Recent full electrical rewire
- Excellent transport links (M4 access)
- EPC Rating: D



 3  1  2

**Pinkmove**

01633 746088  
team@pinkmove.co.uk



## About the property

This beautifully presented and recently renovated three-bedroom semi-detached home offers stylish, modern living in a highly convenient location. A range of local shops and amenities are within easy reach, with larger retail outlets nearby and excellent transport links, including quick access to the M4 for commuting to Cardiff and Bristol. Well-regarded schools are also close by.

The accommodation has been thoughtfully updated throughout, creating a fresh and contemporary feel ideal for first-time buyers and families alike. The ground floor comprises a spacious lounge, a modern kitchen/dining room perfect for entertaining, and a newly fitted family bathroom.

To the first floor are three well-proportioned bedrooms, all finished to a high standard in keeping with the rest of the property.

Externally, the property benefits from off-road parking via a driveway to the front and a generous, enclosed rear garden, ideal for outdoor living. Side access adds further practicality. This is a fantastic opportunity to acquire a turnkey home, boasting a newly fitted kitchen and bathroom, in a popular and well-connected location. The property further benefits from a full electrical rewire and a new heating system with boiler and radiators replaced.





## Accommodation

Lounge

Kitchen/Dining Room

Bathroom

Bedroom 1

Bedroom 2

Bedroom 3

01633 746088

team@pinkmove.co.uk

## Floorplan



Ground Floor

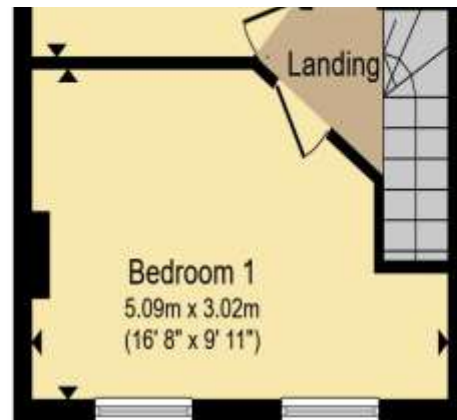

First Floor

Total floor area 64.8 sq.m. (698 sq.ft.) approx

This floor plan is for illustrative purposes only. It is not drawn to scale. Any measurements, floor areas (including any total floor area), openings and orientation are approximate. No details are guaranteed, they cannot be relied upon for any purpose and they do not form part of any agreement. No liability is taken for any error, omission or misstatement. A party must rely upon its own inspection(s). Powered by [www.focalagent.com](http://www.focalagent.com)

Pinkmove

## Important Information

Note while we endeavour to make our sales details accurate and reliable, if there is any point which is of particular interest to you, please contact the office and we will be pleased to confirm the position for you. We have not personally tested any apparatus, equipment, fixtures, fittings or services and cannot verify they are in working order or fit for their purposes. Nothing in these particulars is intended to indicate that carpets or curtains, furnishings or fittings, electrical goods (whether wired or not). Gas fires or light fittings or any other fixtures not expressly included form part of the property offered for sale. This computer generated Floorplan, if applicable, is intended as a general guide to the layout and design of the property. It is not to scale and should not be relied upon for dimensions. Tenure: We cannot confirm the tenure of the property as we have not had access to the legal documents. The buyer is advised to obtain verification from their solicitor or surveyor.

Peter Alan Limited is registered in England and Wales under company number 2073153. Registered Office is Cumbria House, 16-20 Hockliffe Street, Leighton Buzzard, Bedfordshire, LU7 1GN. VAT Registration Number is 500 2481 05. For activities relating to regulated mortgages and non-investment insurance contracts, Peter Alan Limited is an appointed representative of Connells Limited which is authorised and regulated by the Financial Conduct Authority. Connells Limited's Financial Services Register number is 302221. Most buy-to-let

noa | propertymark  
PROTECTED

The Property  
Ombudsman