



Moorend Avenue, Chelmsley Wood Birmingham B37 5SD

welcome to

Moorend Avenue, Chelmsley Wood Birmingham

*****END OF TERRACE*** POPULAR RESIDENTIAL LOCATION***THREE BEDROOMS*** FRONT AND REAR GARDENS***IDEAL FIRST TIME PURCHASE***
NO ONWARD CHAIN*****



Agent Note

This property is of a non-standard construction.

Entrance Porch

Wall light point and door to hall.

Lounge

Three ceiling light points, three wall light points, double-glazed bow window to front, double-glazed sliding door to lean too.

Kitchen

Wall, base and draw units, stainless steel sink and drainer, plumbing for washing machine, two ceiling light points, radiator, double-glazed bow window to front and double-glazed window to rear.

Landing

Loft access, ceiling light point, storage cupboard housing central heating boiler, doors to bathroom, w.c., and bedrooms one, two and three.

Bedroom One

Ceiling light point, radiator, double-glazed window to front and door to storage cupboard.

Bedroom Two

Ceiling light point, radiator and double-glazed window to front

Bedroom Three

Ceiling light point, radiator, double-glazed window to rear.

Bathroom/Wet Room

Obscured double-glazed window to rear, tiled wall and wet room, wash basin and ceiling light point.

W.C.

Obscured double-glazed window, ceiling light point and low level w.c.

Rear Garden

Slabbed, brick-built storage, rear and side access.

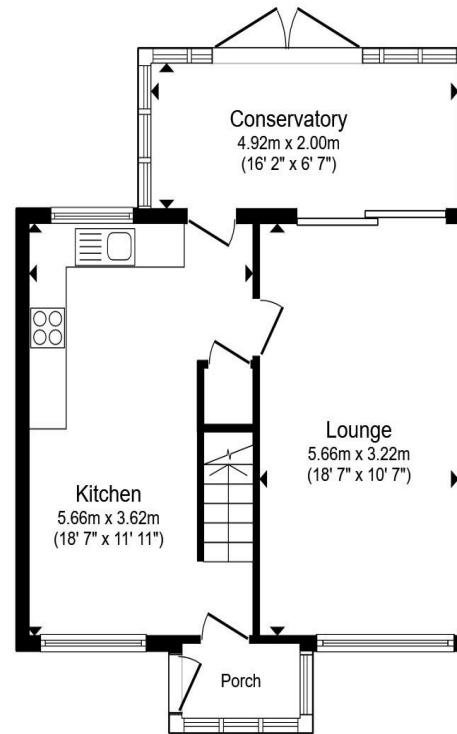

Ground Floor

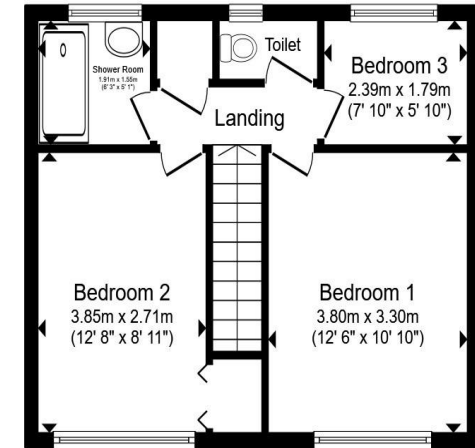

First Floor

Total floor area 89.5 m² (963 sq.ft.) approx

This floor plan is for illustrative purposes only. It is not drawn to scale. Any measurements, floor areas (including any total floor area), openings and orientation are approximate. No details are guaranteed, they cannot be relied upon for any purpose and they do not form part of any agreement. No liability is taken for any error, omission or misstatement. A party must rely upon its own inspection(s). Powered by www.propertybox.io



view this property online shipways.co.uk/Property/CAB112233



welcome to

Moorend Avenue, Chelmsley Wood Birmingham

- END OF TERRACE HOUSE
- THREE BEDROOMS
- POPULAR LOCATION
- FRONT AND REAR GARDENS
- IDEAL FIRST TIME PURCHASE

Tenure: Freehold EPC Rating: D

Council Tax Band: A

offers over

£180,000



Please note the marker reflects the
postcode not the actual property

view this property online shipways.co.uk/Property/CAB112233



Property Ref:
CAB112233 - 0003

1. MONEY LAUNDERING REGULATIONS Intending purchasers will be asked to produce identification documentation at a later stage and we would ask for your co-operation in order that there is no delay in agreeing the sale. 2. These particulars do not constitute part or all of an offer or contract. 3. The measurements indicated are supplied for guidance only and as such must be considered incorrect. Potential buyers are advised to recheck measurements before committing to any expense. 4. We have not tested any apparatus, equipment, fixtures or services and it is in the buyers interest to check the working condition of any appliances. 5. Where an EPC, or a Home Report (Scotland only) is held for this property, it is available for inspection at the branch by appointment. If you require a printed version of a Home Report, you will need to pay a reasonable production charge reflecting printing and other costs. 6. We are not able to offer an opinion either written or verbal on the content of these reports and this must be obtained from your legal representative. 7. Whilst we take care in preparing these reports, a buyer should ensure that his/her legal representative confirms as soon as possible all matters relating to title including the extent and boundaries of the property and other important matters before exchange of contracts.

Shipways is a trading name of Sequence (UK) Limited which is registered in England and Wales under company number 4268443, Registered Office is Cumbria House, 16-20 Hockliffe Street, Leighton Buzzard, Bedfordshire, LU7 1GN. VAT Registration Number is 500 2481 05.

shipways



0121 747 4722



castlebromwich@shipways.co.uk



258 Chester Road, Castle Bromwich,
BIRMINGHAM, West Midlands, B36 0JE



shipways.co.uk