



Magpie Close, Enfield, EN1 4JD

welcome to
Magpie Close, Enfield

Requiring some updating but offering excellent potential, we offer this first floor purpose built one bedroom flat, in a convenient location close to Forty Hall Country Park, within easy access of Enfield Town Shopping Centre and rail stations.





Entrance Hall

Laminate floor.

Lounge

14' 2" x 10' 3" (4.32m x 3.12m)
Laminate floor, electric radiator.

Kitchen

11' x 6' 9" (3.35m x 2.06m)
Base units with inset stainless steel sink unit, matching wall cabinets, laminate floor, airing cupboard housing lagged copper cylinder hot water tank with immersion heater.

Bedroom

12' 8" x 10' 9" (3.86m x 3.28m)
Laminate floor.

Bathroom / WC

Panelled bath with separate control, shower screen, pedestal wash hand basin, low flush WC, vinyl floor, fully tiled walls.

Outside

Communal grounds surround the blocks. There are ample parking facilities for both residents and guests.



view this property online barnfields.co.uk/Property/ENF105900



welcome to

Magpie Close, Enfield

- 154 Year Lease
- No Chain
- Good Sized Lounge
- Double Bedroom
- Ample Parking Facilities

Tenure: Leasehold EPC Rating: D

Council Tax Band: C Service Charge: 1356.00

Ground Rent: Ask Agent

This is a Leasehold property with details as follows; Term of Lease 189 years from 25 Dec 1990. Should you require further information please contact the branch. Please Note additional fees could be incurred for items such as Leasehold packs.

£200,000



Please note the marker reflects the postcode not the actual property

Magpie Close, Enfield, EN1

Approximate Area = 420 sq ft / 39 sq m

For identification only - Not to scale

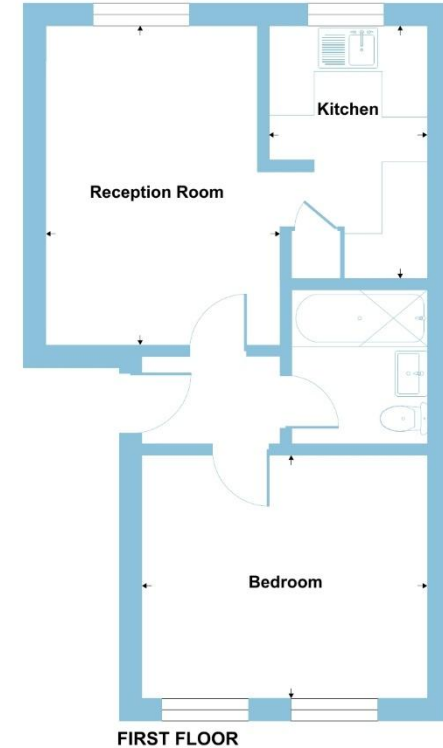

FIRST FLOOR

check out more properties at [barnfields.co.uk](https://www.barnfields.co.uk)



Property Ref:
ENF105900 - 0002

1. MONEY LAUNDERING REGULATIONS Intending purchasers will be asked to produce identification documentation at a later stage and we would ask for your co-operation in order that there is no delay in agreeing the sale. 2. These particulars do not constitute part or all of an offer or contract. 3. The measurements indicated are supplied for guidance only and as such must be considered incorrect. Potential buyers are advised to recheck measurements before committing to any expense. 4. We have not tested any apparatus, equipment, fixtures or services and it is in the buyers interest to check the working condition of any appliances. 5. Where an EPC, or a Home Report (Scotland only) is held for this property, it is available for inspection at the branch by appointment. If you require a printed version of a Home Report, you will need to pay a reasonable production charge reflecting printing and other costs. 6. We are not able to offer an opinion either written or verbal on the content of these reports and this must be obtained from your legal representative. 7. Whilst we take care in preparing these reports, a buyer should ensure that his/her legal representative confirms as soon as possible all matters relating to title including the extent and boundaries of the property and other important matters before exchange of contracts.

Barnfields is a trading name of Sequence (UK) Limited which is registered in England and Wales under company number 4268443, Registered Office is Cumbria House, 16-20 Hockliffe Street, Leighton Buzzard, Bedfordshire, LU7 1GN. VAT Registration Number is 500 2481 05.

Floor plan produced in accordance with RICS Property Measurement 2nd Edition, Incorporating International Property Measurement Standards (IPMS2 Residential). © nichecom 2026. Produced for Barnard Marcus. REF: 1485798



020 8363 3394



info@barnfields.com



1a Windmill Hill, Enfield, Middlesex, EN2 6SE



[barnfields.co.uk](https://www.barnfields.co.uk)